

TO-3

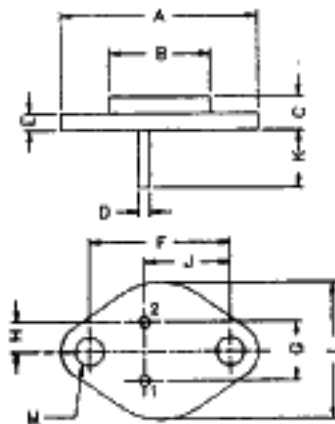

DIM	MIN	MAX
A	—	39,37
B	—	22,22
C	6,35	8,50
D	0,98	1,09
E	—	1,77
F	29,90	30,4
G	10,69	11,18
H	5,20	5,72
J	16,64	17,15
K	11,15	12,25
L	—	26,67
M	3,84	4,19

ALL DIMENSIONS ARE IN M.M.

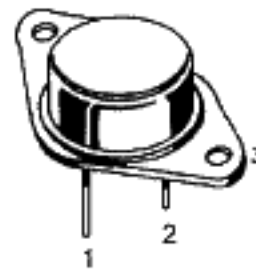

PIN CONFIGURATION
 1. BASE
 2. EMITTER
 3. COLLECTOR

TO-3 Power Package Transistors (NPN)

Type No.	Maximum Ratings						Electrical Characteristics (T _a =25°C, Unless Otherwise Specified)														
	V _{CEO} (V) Min	V _{CE0} (V) Min	V _{EB0} (V) Min	P _D (W) @ T _c =25°C	I _c (A)	I _{CEO} (μA) Max	V _{CE} (V) @ I _c	I _{CE} (μA) Max	V _{CE} (V) @ I _{CE}	I _{FE} (A) Min	I _{FE} (A) Max	I _c (A) @ V _{CE}	V _{CE} (V) @ I _c	V _{CE(SAT)} (V) & Max	V _{BE(SAT)} (V) Max	I _c (A) @ V _{CE}	C _{ob} (pF) Max	f _t (MHz) Min	f _t (MHz) Typ	I _c (mA) Max	
2N3055	100	60	7	117	15			*1000	100	20	70	4	4	1.1		4		2.5		500	
2N3055HV	100	100	7	90	15			*1000	100	20	100	4	4	1.1		4		2.5		500	
2N3055S	100	60	7	90	15			*1000	100	20	100	4	4	1.1		4		2.5		500	
2N3773	160	140	7	150	16	2000	140			15	60	8	4	1.4		8					
2N4347	140	120	7	100	5			*2000	125	15	60	2	4	1		2				500	
2N6253	50	45	7	115	15			*2000	55	20	70	3	4	1.0		3					
2N6257	50	40	5	150	20	4000	50			15	75	8	4	1.5		8		200		1000	
2N6371	50	40	7	117	15					15	60	8	4	1.5		8		800		1000	
2N6371HV	100	100	5	90	15			*2000	45	15	60	8	4	1.5		8	330	2.5		500	
2SC1308	#1500	400	6	50	5			1000	1500	3		4	5	5.0	1.5	4				3	100
2SC1413	1200	500	6	50	5	\$1000	1200							10	2.0	5					
2SC1413A	1500	500	6	50	5	\$1000	1500							10	2.0	5					
2SC1454	300	300	6	50	4	1000	300			20		1	5	1.5	1.4	2.5					
2SC1875	150	500	6	50	3.5	20	1000			5	35	0.5	10	10	0.8	1.2	2.5				
2SC1922	1500	800	6	50	2.5	10	600			5				5	1.5	2					

#NOTE: V_{CE}
 *NOTE: I_{CE}
 \$NOTE: I_{CE}