

## Series 353-383 / 453-483

PCB Header Strips  
Single row / double row  
Wire-wrap / solder tail

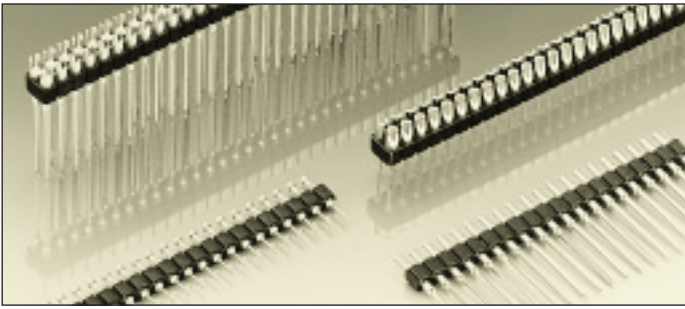



### Headers

With pin / slotted / turret / solder cup head

Solder tail or wrapost

Solder tail pin  $\varnothing$  0.53 mm

Wrapost termination  $\square$  0.63 square

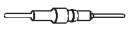
Platings	Sleeve 	Clip 	Pin 
10 90			0.25 $\mu$ m Au 5 $\mu$ m Sn Pb

### Ordering information

Replace **xx** with the number of poles. e.g. 460-10-2**xx**-00-001 for a double row version with 8 pins per row becomes:  
460-10-2**16**-00-001

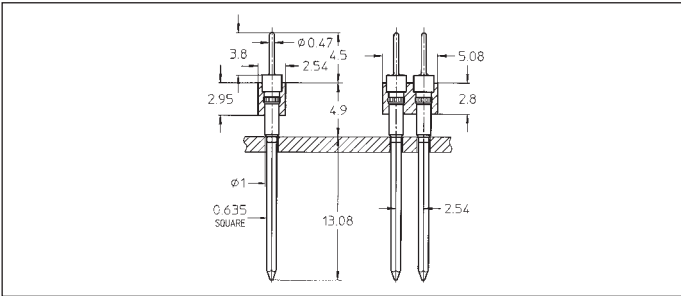

353-10-1xx-00-001 **B**

353-90-1xx-00-001

453-10-2xx-00-001 **B**

453-90-2xx-00-001

Pin header strip, wrapost, single row / double row. Solder tail see page 44

Single row, availability from: 1 to 64 contacts  
Standard number of contacts 5, 6, 8, 10, 14, 16, 20, 21, 25, 30, 32, 48, 56, 60 and 64

Double row, availability from 4 to 72 contacts  
Standard number of contacts 40, 44, 56, 64 and 72

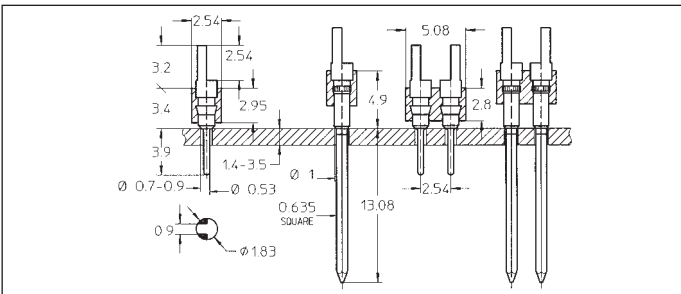

360-10-1xx-00-001 **B**

360-90-1xx-00-001

363-10-1xx-00-001 **B**

363-90-1xx-00-001

460-10-2xx-00-001 **B**

460-90-2xx-00-001

463-10-2xx-00-001 **B**

463-90-2xx-00-001

Slotted head strip, solder tail or wrapost, single row / double row

Single row, availability from: 1 to 64 contacts  
Standard number of contacts 5, 6, 8, 10, 14, 16, 20, 21, 25, 30, 32, 48, 56, 60 and 64

Double row, availability from 4 to 72 contacts  
Standard number of contacts 40, 44, 56, 64 and 72

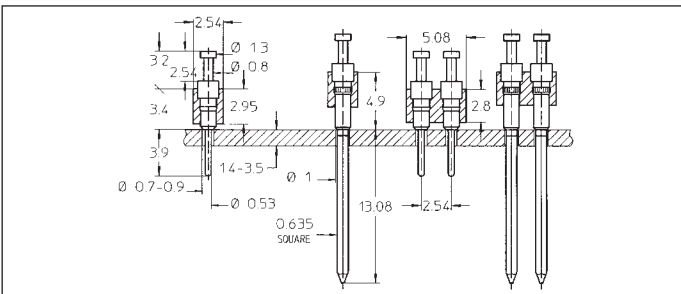

370-10-1xx-00-001 **B**

370-90-1xx-00-001

373-10-1xx-00-001 **B**

373-90-1xx-00-001

470-10-2xx-00-001 **B**

470-90-2xx-00-001

473-10-2xx-00-001 **B**

473-90-2xx-00-001

Turret head strip, solder tail or wrapost, single row / double row

Single row, availability from: 1 to 64 contacts  
Standard number of contacts 5, 6, 8, 10, 14, 16, 20, 21, 25, 30, 32, 48, 56, 60 and 64

Double row, availability from 4 to 72 contacts  
Standard number of contacts 40, 44, 56, 64 and 72

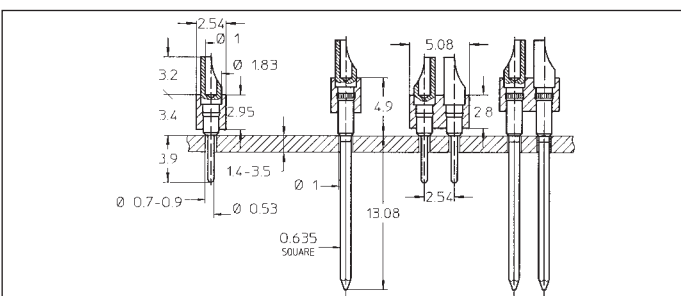

380-10-1xx-00-001 **B**

380-90-1xx-00-001

383-10-1xx-00-001 **B**

383-90-1xx-00-001

480-10-2xx-00-001 **B**

480-90-2xx-00-001

483-10-2xx-00-001 **B**

483-90-2xx-00-001

Solder cup strip, solder tail or wrapost, single row / double row

Single row, availability from: 1 to 64 contacts  
Standard number of contacts 5, 6, 8, 10, 14, 16, 20, 21, 25, 30, 32, 48, 56, 60 and 64

Double row, availability from 4 to 72 contacts  
Standard number of contacts 40, 44, 56, 64 and 72