

**VXC6 7 x 5 x 1.1 mm 2/4 pads**

<b>Package Options</b>	<b>C6</b> = 7 x 5 x 1.1 mm 2/4 pads
<b>Frequency Range</b>	10 MHz to 100.00 MHz
<b>Standard Frequencies</b>	See <a href="#">Standard Frequency Table</a>
<b>Mode</b>	<b>1</b> = Fundamental (10 to 40 MHz) <b>3</b> = 3 <sup>rd</sup> Overtone (40 to 100 MHz)
<b>Stability Options</b>	<b>A</b> = ±100 PPM -20°C to +70°C <b>B</b> = ±50 PPM -20°C to +70°C <b>F</b> = ±30 PPM -20°C to +70°C
<b>Load Capacitance</b>	<b>0</b> = Series Resonant <b>1</b> = 16 pF <b>2</b> = 20 pF <b>4</b> = 18 pF <b>5</b> = 10 pF <b>6</b> = 30 pF
<b>STD Calibration Tolerance</b>	±30 PPM at +25°C Tolerances to ±10 PPM are available
<b>Equivalent Series Resistance</b>	80Ω Maximum
<b>Shunt Capacitance</b>	7 pF Maximum
<b>Drive Level</b>	10 to 100 uW
<b>Crystal Aging</b>	<5 ppm/1 <sup>st</sup> year
<b>Standard Packaging</b>	Tape & Reel (1000 pc minimum)
<b>Typical P/N</b>	<b>VXC6-1B2-28M224</b>



**C6** = 7 x 5 x 1.0 mm 2/4 pads  
**1** = Fundamental Mode  
**B** = ±50 PPM -20°C to +70°C  
**2** = 20 pF load

[Generate your own part number!](#)

We welcome your custom requests and will issue a custom part number for items that are not listed.

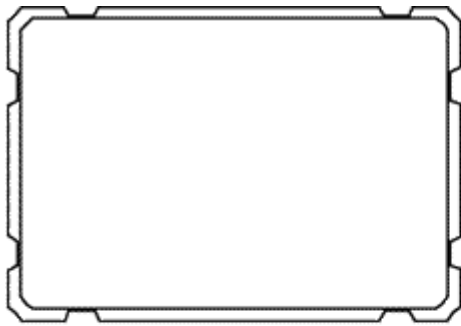

CONNECTIONS

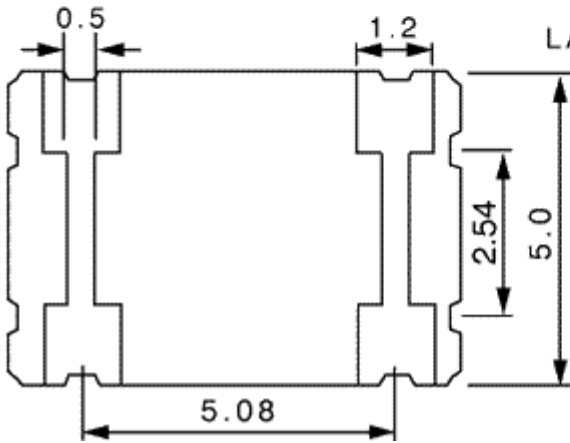
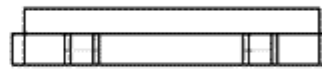
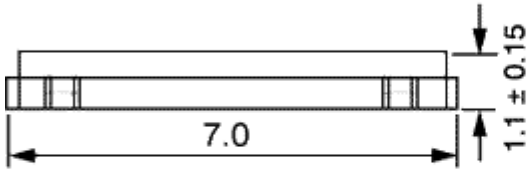
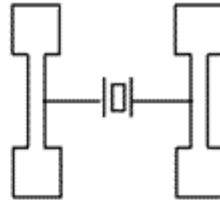

LAND PATTERN (EXAMPLE)

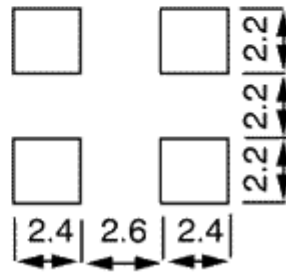

Dimensions in mm.