



Features

- Single pole/double throw
- Vertical adjust
- Rugged construction
- Board washable
- Wave solderable

■ RoHS compliant* version available

7829 6 mm Through-hole Sealed Rotary Switch

Electrical Characteristics

Contact Rating
Maximum Current100 mA max.
Maximum Voltage16 V
Contact Timing.....Non-shorting
Contact Resistance2 ohms max.

General Characteristics

Switch TypeSPDT
Operating Temperature Range
.....-55 °C to +125 °C
Storage Temperature Range
.....-55 °C to +125 °C
Thermal Shock5 cycles
.....-55 °C to +125 °C
Seal Test85 °C Fluorinert†

Mechanical Characteristics

Stop Strength3.5 N.cm
Positions2

Environmental Characteristics

Vibration30 G
Shock100 G
Thermal Shock(5 cycles)
.....-55 °C to +125 °C

Humidity
Insulation Resistance
.....10 megohms min.

Rotational Life
-05150 Cycles
-0232000 Cycles

Maximum Soldering Heat245 °C
Standard Packaging50 pcs/tube

How to Order

7829 H - 1 - 051 LF

Model _____
Terminal _____
Switch Type _____
1 = SPDT
Rotational Life _____
-051 = 50 Cycles
-023 = 2000 Cycles
Terminations _____
LF = 100 % Tin-plated (RoHS compliant)
Blank = 90 % Tin / 10 % Lead-plated (Standard)

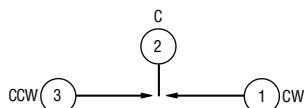

Product Dimensions

7829H

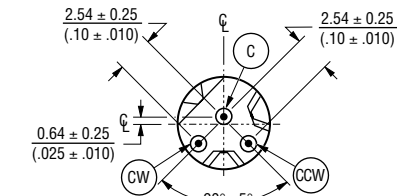
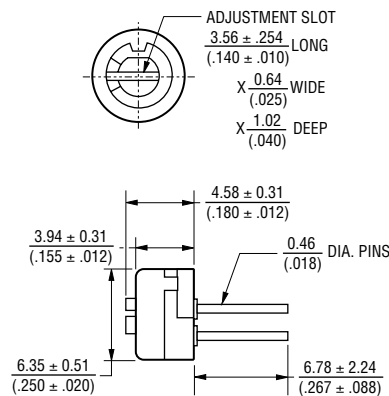

RECOMMENDED PCB LAYOUT

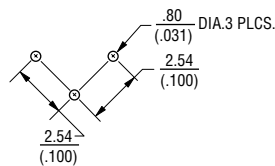

DIMENSIONS ARE: MM
(INCHES)

TOLERANCES: ±.2 EXCEPT WHERE NOTED.

Reflow Soldering Profile

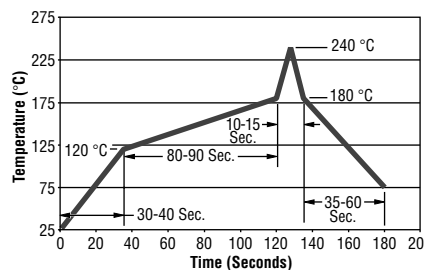

7829S

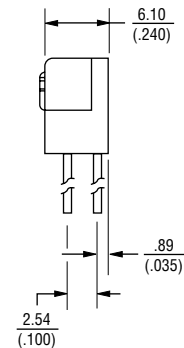
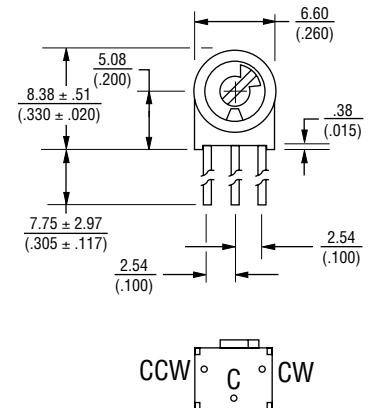

Packaging Specifications

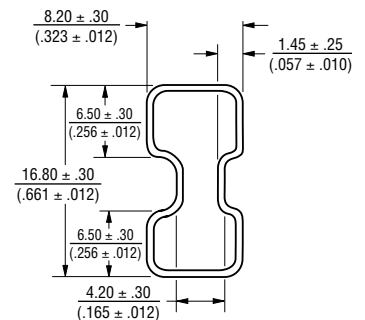

TUBE LENGTH - 356 ± 1.50 MM.
UNITS PACKAGED 50 PIECES PER TUBE.

†"Fluorinert" is a registered trademark of 3M Co.

*RoHS Directive 2002/95/EC Jan 27 2003 including Annex.
Specifications are subject to change without notice.

Customers should verify actual device performance in their specific applications.