



6 AMP SILICON BRIDGE RECTIFIERS

FEATURES

- VOID FREE VACUUM DIE SOLDERING FOR MAXIMUM MECHANICAL STRENGTH AND HEAT DISSIPATION (Solder Voids: Typical < 2%, Max. < 10% of Die Area)
- BUILT-IN STRESS RELIEF MECHANISM FOR SUPERIOR RELIABILITY AND PERFORMANCE
- SURGE OVERLOAD RATING TO 250 AMPS PEAK
- **UL RECOGNIZED - FILE #E124962**

MECHANICAL DATA

- Case: Molded plastic, U/L Flammability Rating 94V-0
- Terminals: Round silver plated copper pins
- Soldering: Per MIL-STD 202 Method 208 guaranteed
- Polarity: Marked on side of case; positive lead at beveled corner
- Mounting Position: Any. Through hole provided for #6 screw
- Weight: 0.13 Ounces (3.6 Grams)

MECHANICAL SPECIFICATION

ACTUAL SIZE

DT
DB602

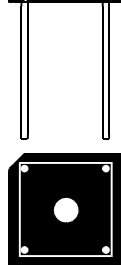

SERIES DB600 - DB610 and ADB604 - ADB608

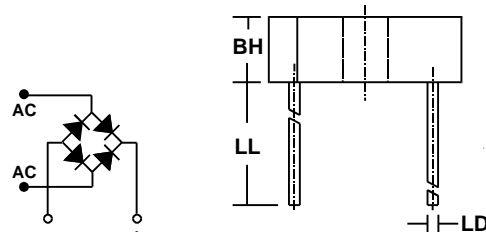

SYM	MILLIMETERS		INCHES	
	MIN	MAX	MIN	MAX
BL	14.7	15.7	0.58	0.62
BH	5.8	6.9	0.23	0.27
D1	10.3	11.3	0.405	0.445
LL	19.0	n/a	0.75	n/a
LD	1.0	1.1	0.039	0.042

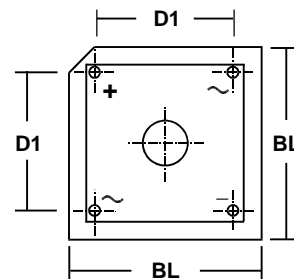

MAXIMUM RATINGS & ELECTRICAL CHARACTERISTICS

Ratings at 25 °C ambient temperature unless otherwise specified. Single phase, 60Hz, resistive or inductive load. For capacitive loads, derate current by 20%.

PARAMETER (TEST CONDITIONS)	SYMBOL	RATINGS										UNITS
		CONTROLLED AVALANCHE			NON-CONTROLLED AVALANCHE							
Series Number		ADB 604	ADB 606	ADB 608	DB 600	DB 601	DB 602	DB 604	DB 606	DB 608	DB 610	
Maximum DC Blocking Voltage	V _{RM}	400	600	800	50	100	200	400	600	800	1000	VOLTS
Working Peak Reverse Voltage	V _{RWM}											
Maximum Peak Recurrent Reverse Voltage	V _{RRM}											
RMS Reverse Voltage	V _R (RMS)	280	420	560	35	70	140	280	420	560	700	
Power Dissipation in V _(BR) Region for 100 μS Square Wave	P _{RM}	400			n/a							WATTS
Continuous Power Dissipation in V _(BR) Region @ T _{HS} =80 °C (Heat Sink Temp)	P _R	2			n/a							
Thermal Energy (Rating for Fusing) t < 8.3mSec	I ² t	127										AMPS ² SEC
Peak Forward Surge Current. Single 60Hz Half-Sine Wave Superimposed on Rated Load (JEDEC Method). T _c = 60° C	I _{FSM}	250										AMPS
Average Forward Rectified Current, T _c = 60° C (Note 2)	I _o	6										
Junction Operating and Storage Temperature Range	T _J , T _{STG}	-55 to +150										°C
Minimum Avalanche Voltage	V _(BR) Min	See Note 5			n/a							VOLTS
Maximum Avalanche Voltage	V _(BR) Max	See Note 5			n/a							
Maximum Forward Voltage (Per Diode) at 6 Amps DC	V _{FM}	0.95 (Typical < 0.9)										
Typical Junction Capacitance (Note 4)	C _J	21										pF
Maximum Reverse Current at Rated V _{RM} @ T _A = 25° C @ T _A = 125° C	I _{RM}	1 50										μA
Minimum Insulation Breakdown Voltage (Circuit to Case)	V _{ISO}	2500										VOLTS
Typical Thermal Resistance, Junction to Case (Note 2)	R _{θJC}	8.0										°C/W

NOTES: (1) Bolt bridge on heat sink with #6 screw, using silicon thermal compound between bridge and mounting surface for maximum heat transfer.
(2) Bridge mounted on 4.0" sq. x 0.11" thick (10.5cm sq. x 0.3cm) aluminum plate
(3) Bridge mounted on PC Board with 0.5" sq. (12mm sq.) copper pads and bridge lead length of 0.375" (9.5mm)
(4) Measured at 1.0 MHz and applied reverse voltage of 4.0 Volts
(5) These bridges exhibit the avalanche characteristic at breakdown. If your application requires a specific breakdown voltage range, please contact us.

3.01 06db

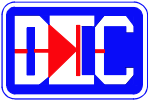

6 AMP SILICON BRIDGE RECTIFIERS

RATING & CHARACTERISTIC CURVES FOR SERIES DB600 - DB610 and SERIES ADB604 - ADB608

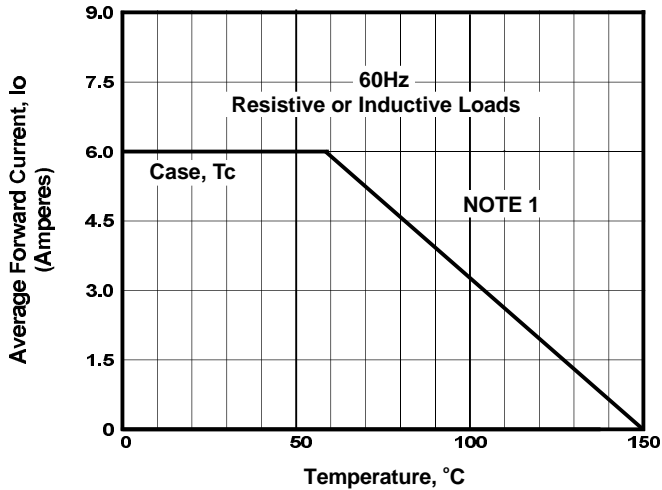

FIGURE 1. FORWARD CURRENT DERATING CURVE

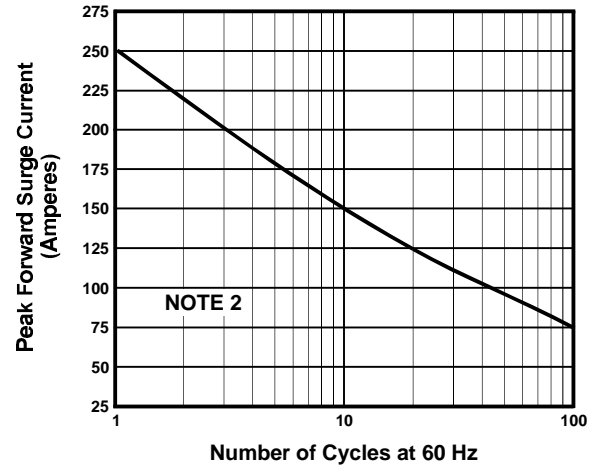

FIGURE 2. MAXIMUM NON-REPETITIVE SURGE CURRENT

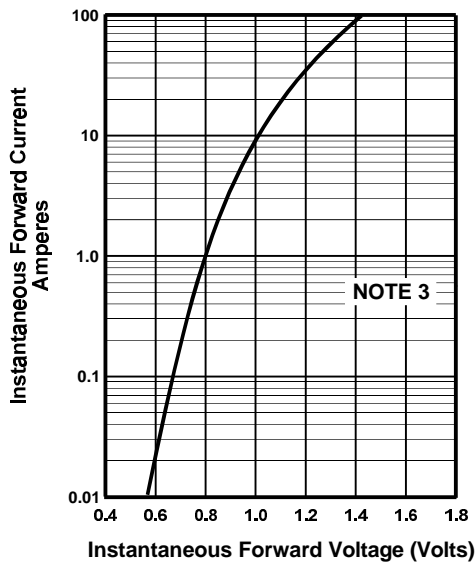

FIGURE 3. TYPICAL FORWARD CHARACTERISTIC PER DIODE

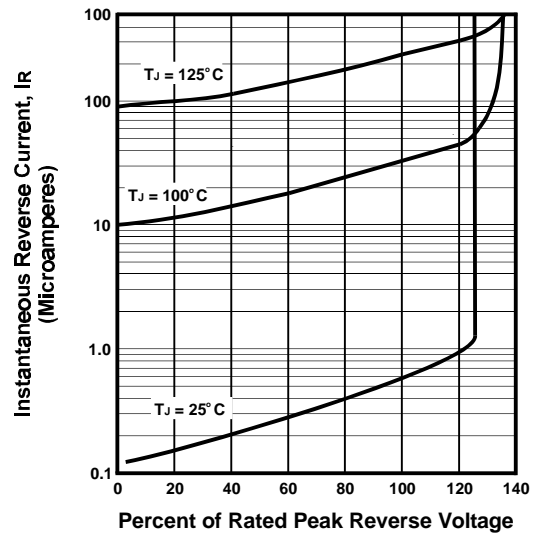

FIGURE 4. TYPICAL REVERSE CHARACTERISTICS PER DIODE

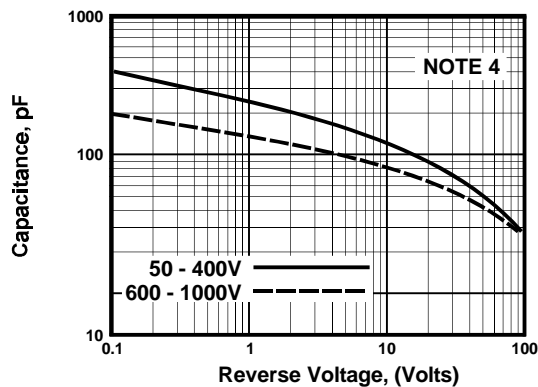

FIGURE 5. TYPICAL JUNCTION CAPACITANCE PER DIODE

NOTES

- (1) Case Temperature, T_c , With Bridge Mounted on 4"Sq. x 0.11" Thick (10.5cm Sq. x 0.3cm) Aluminum Plate
- (2) $T_J = 150^\circ\text{C}$
- (3) $T_J = 25^\circ\text{C}$; Pulse Width = 300μSec; 1% Duty Cycle
- (4) $T_J = 25^\circ\text{C}$; $f = 1\text{ MHz}$; $V_{sig} = 50\text{mVp-p}$