

GENERAL DESCRIPTION

This high voltage MOSFET uses an advanced termination scheme to provide enhanced voltage-blocking capability without degrading performance over time. In addition, this advanced MOSFET is designed to withstand high energy in avalanche and commutation modes. The new energy efficient design also offers a drain-to-source diode with a fast recovery time. Designed for high voltage, high speed switching applications in power supplies, converters and PWM motor controls, these devices are particularly well suited for bridge circuits where diode speed and commutating safe operating areas are critical and offer additional and safety margin against unexpected voltage transients.

FEATURES

- ◆ Robust High Voltage Termination
- ◆ Avalanche Energy Specified
- ◆ Source-to-Drain Diode Recovery Time Comparable to a Discrete Fast Recovery Diode
- ◆ Diode is Characterized for Use in Bridge Circuits
- ◆ I_{DSS} Specified at Elevated Temperature

PIN CONFIGURATION

TO-220/TO-220FP
Front View

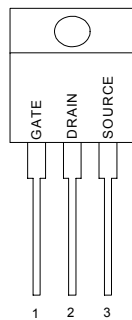

SYMBOL

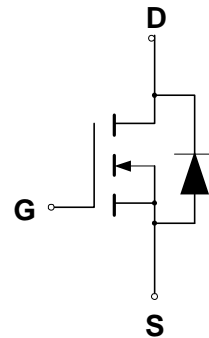

N-Channel MOSFET

ABSOLUTE MAXIMUM RATINGS

Rating	Symbol	Value	Unit
Drain to Current — Continuous	I_D	7.0	A
— Pulsed	I_{DM}	20	
Gate-to-Source Voltage — Continue	V_{GS}	± 20	V
— Non-repetitive	V_{GSM}	± 40	V
Total Power Dissipation	P_D		W
TO-220		147	
TO-220FP		50	
Operating and Storage Temperature Range	T_J, T_{STG}	-55 to 150	$^{\circ}\text{C}$
Single Pulse Drain-to-Source Avalanche Energy — $T_J = 25^{\circ}\text{C}$ ($V_{DD} = 100\text{V}$, $V_{GS} = 10\text{V}$, $I_L = 7\text{A}$, $L = 10\text{mH}$, $R_G = 25\Omega$)	E_{AS}	245	mJ
Thermal Resistance — Junction to Case	θ_{JC}	1.0	$^{\circ}\text{C}/\text{W}$
— Junction to Ambient	θ_{JA}	62.5	
Maximum Lead Temperature for Soldering Purposes, 1/8" from case for 10 seconds	T_L	260	$^{\circ}\text{C}$

(1) $V_{DD} = 50\text{V}$, $I_D = 10\text{A}$

(2) Pulse Width and frequency is limited by $T_J(\text{max})$ and thermal response

ORDERING INFORMATION

Part Number	Package
CMT07N60	TO-220
CMT07N60FP	TO-220 Full Pak

ELECTRICAL CHARACTERISTICS

Unless otherwise specified, $T_J = 25^\circ\text{C}$.

		CMT07N60			
Characteristic	Symbol	Min	Typ	Max	Units
Drain-Source Breakdown Voltage ($V_{GS} = 0\text{ V}$, $I_D = 250\text{ }\mu\text{A}$)	$V_{(BR)DSS}$	600			V
Drain-Source Leakage Current ($V_{DS} = 600\text{ V}$, $V_{GS} = 0\text{ V}$) ($V_{DS} = 480\text{ V}$, $V_{GS} = 0\text{ V}$, $T_J = 125^\circ\text{C}$)	I_{DSS}			100 100	μA
Gate-Source Leakage Current-Forward ($V_{gsf} = 20\text{ V}$, $V_{DS} = 0\text{ V}$)	I_{GSSF}			100	nA
Gate-Source Leakage Current-Reverse ($V_{gsr} = 20\text{ V}$, $V_{DS} = 0\text{ V}$)	I_{GSSR}			100	nA
Gate Threshold Voltage ($V_{DS} = V_{GS}$, $I_D = 250\text{ }\mu\text{A}$)	$V_{GS(th)}$	2.0		4.0	V
Static Drain-Source On-Resistance ($V_{GS} = 10\text{ V}$, $I_D = 3.5\text{ A}$) *	$R_{DS(on)}$			1.2	Ω
Forward Transconductance ($V_{DS} = 40\text{ V}$, $I_D = 3.5\text{ A}$) *	g_{FS}	4.0			mhos
Input Capacitance	$(V_{DS} = 25\text{ V}$, $V_{GS} = 0\text{ V}$, $f = 1.0\text{ MHz}$)	C_{iss}	1380	1800	pF
Output Capacitance		C_{oss}	115	150	pF
Reverse Transfer Capacitance		C_{rss}	23	30	pF
Turn-On Delay Time	$(V_{DD} = 300\text{ V}$, $I_D = 7.0\text{ A}$, $V_{GS} = 10\text{ V}$, $R_G = 9.1\Omega$) *	$t_{d(on)}$	30	70	ns
Rise Time		t_r	80	170	ns
Turn-Off Delay Time		$t_{d(off)}$	125	260	ns
Fall Time		t_f	85	180	ns
Total Gate Charge	$(V_{DS} = 480\text{ V}$, $I_D = 7.0\text{ A}$, $V_{GS} = 10\text{ V}$) *	Q_g	38	50	nC
Gate-Source Charge		Q_{gs}	6.4		nC
Gate-Drain Charge		Q_{gd}	15		nC
Internal Drain Inductance (Measured from the drain lead 0.25" from package to center of die)	L_D		4.5		nH
Internal Drain Inductance (Measured from the source lead 0.25" from package to source bond pad)	L_S		7.5		nH
SOURCE-DRAIN DIODE CHARACTERISTICS					
Forward On-Voltage(1)	$(I_S = 7.0\text{ A}$, $d_{IS}/d_t = 100\text{ A}/\mu\text{s}$)	V_{SD}		1.4	V
Forward Turn-On Time		t_{on}	**		ns
Reverse Recovery Time		t_{rr}	415		ns

* Pulse Test: Pulse Width $\leq 300\mu\text{s}$, Duty Cycle $\leq 2\%$

** Negligible, Dominated by circuit inductance

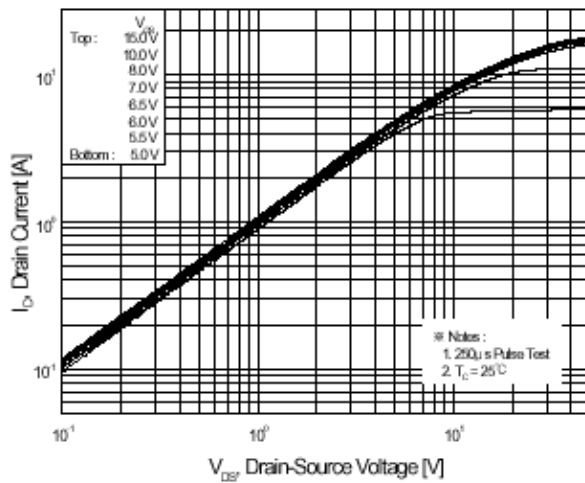
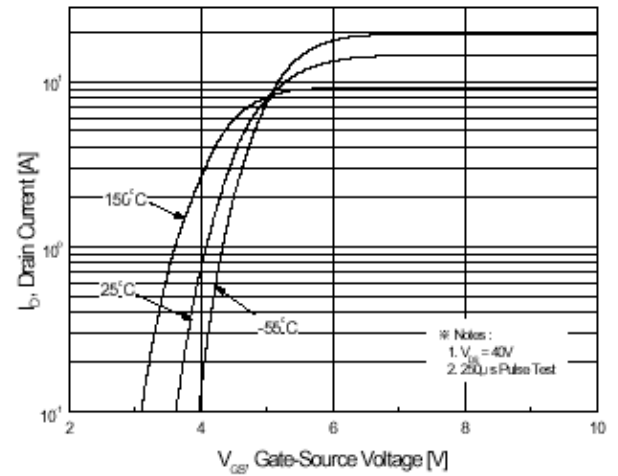
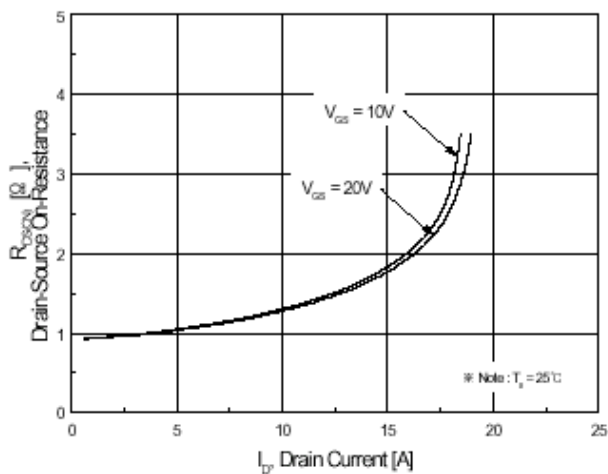
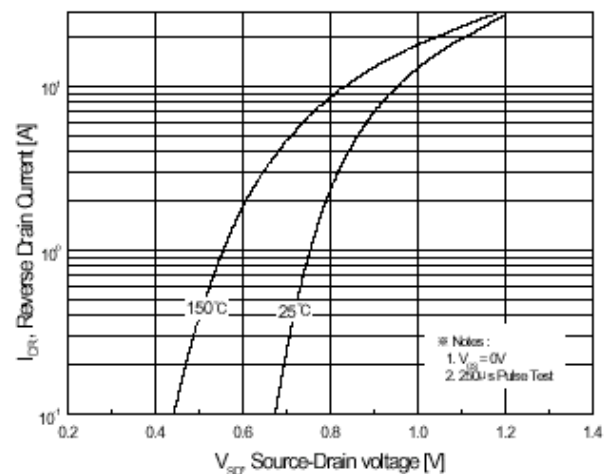
TYPICAL ELECTRICAL CHARACTERISTICS

Figure 1. On-Region Characteristics

Figure 2. Transfer Characteristics

Figure 3. On-Resistance Variation vs Drain Current and Gate Voltage

Figure 4. Body Diode Forward Voltage Variation with Source Current and Temperature

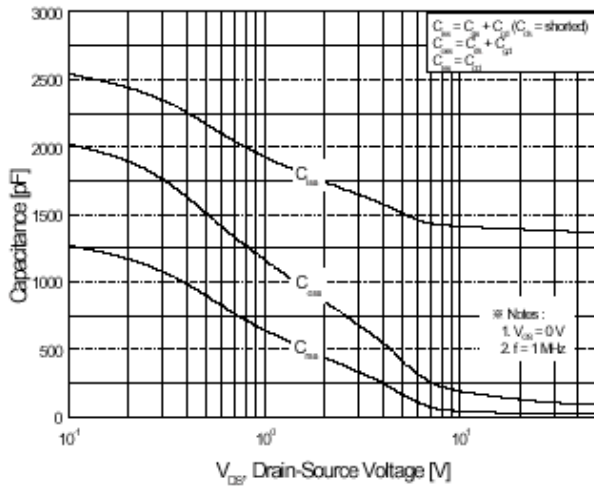

Figure 5. Capacitance Characteristics

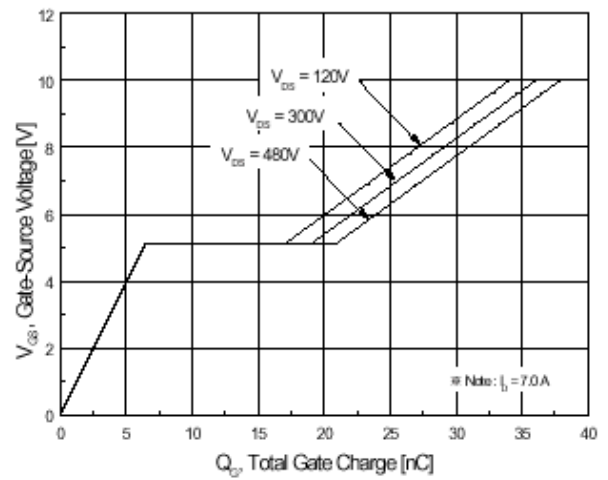

Figure 6. Gate Charge Characteristics

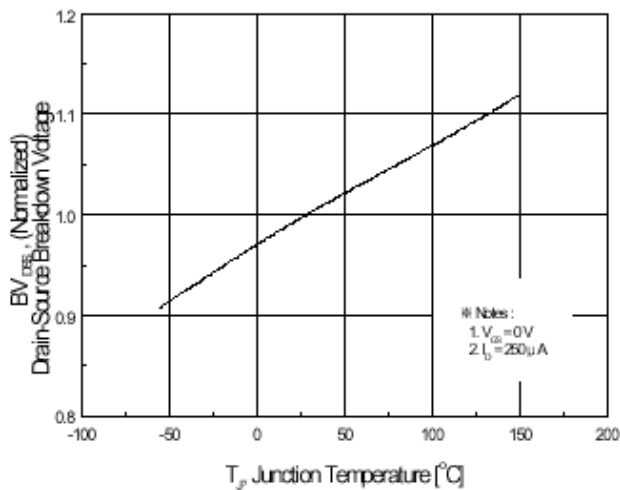

Figure 7. Breakdown Voltage Variation vs Temperature

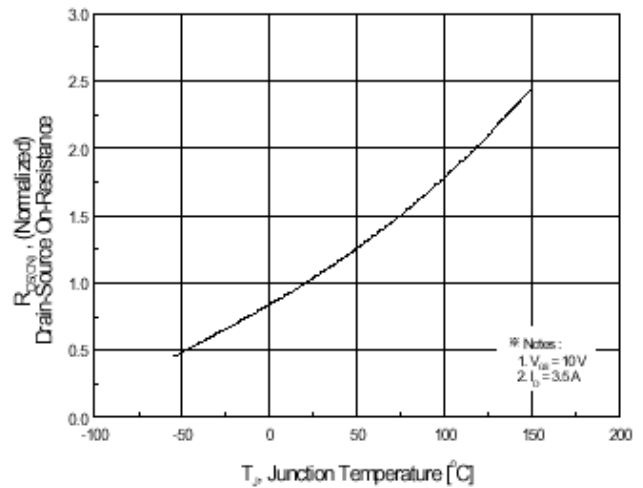

Figure 8. On-Resistance Variation

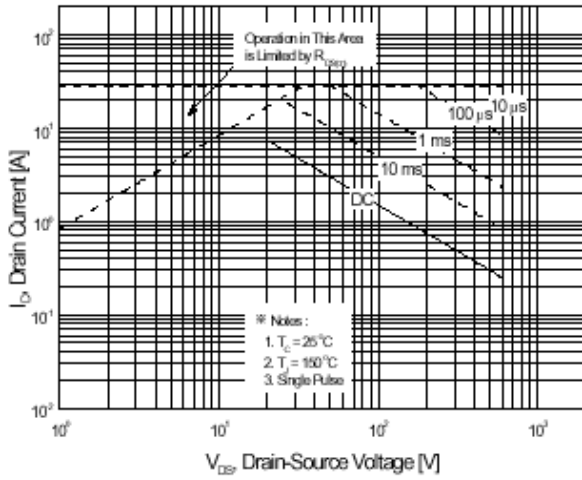

Figure 9-1. Maximum Safe Operating Area

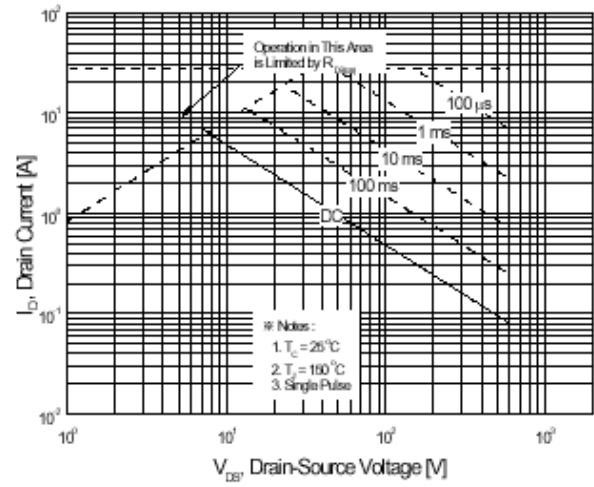

Figure 9-2. Maximum Safe Operating Area

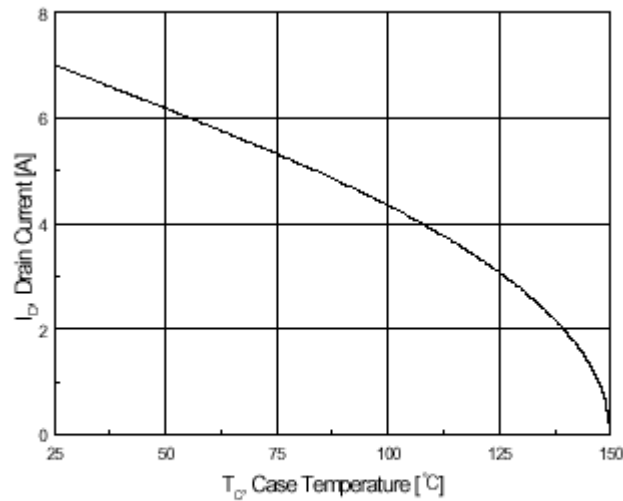
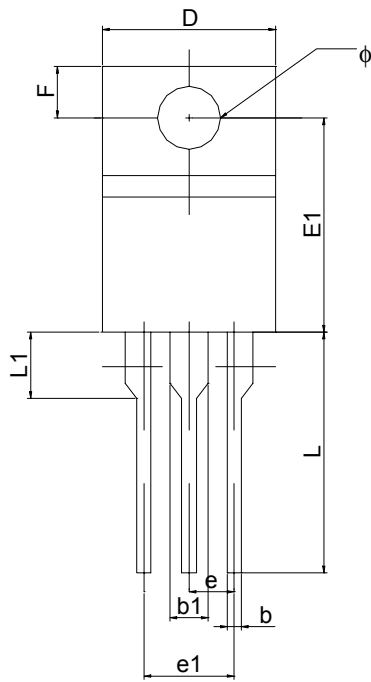
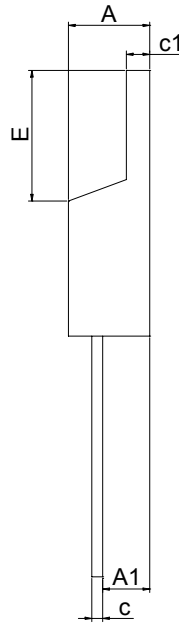

Figure 10. Maximum Drain Current vs Case Temperature

PACKAGE DIMENSION
TO-220

Front View



Side View

PIN 1: GATE
PIN 2: DRAIN
PIN 3: SOURCE

SYMBOLS	DIMENSIONS IN MILLIMETERS			DIMENSIONS IN INCHES		
	MIN	NOM	MAX	MIN	NOM	MAX
A	4.47	---	4.67	0.176	---	0.184
A1	2.52	---	2.62	0.099	---	0.111
b	0.71	---	0.91	0.028	---	0.036
b1	1.17	---	1.37	0.046	---	0.054
c	0.31	---	0.53	0.012	---	0.021
c1	1.17	---	1.37	0.046	---	0.054
D	10.01	---	10.31	0.394	---	0.406
E	8.50	---	8.90	0.335	---	0.350
E1	12.06	---	12.46	0.475	---	0.491
e	---	2.54	---	---	0.100	---
e1	4.98	---	5.18	0.196	---	0.204
F	2.59	---	2.89	0.102	---	0.114
L	13.40	---	13.80	0.528	---	0.543
L1	3.56	---	3.96	0.140	---	0.156
Φ	3.79	---	3.89	0.149	---	0.153

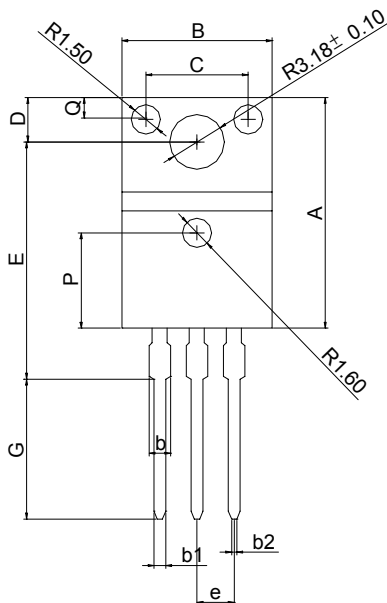
TO-220FP

Front View

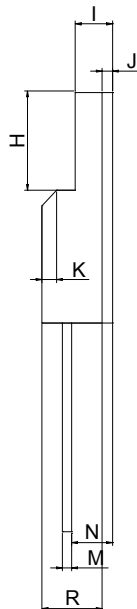

Side View

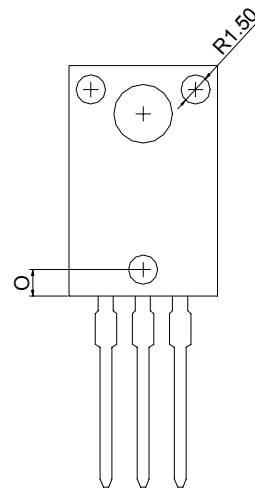

Back View

SYMBOLS	DIMENSIONS IN MILLIMETERS			DIMENSIONS IN INCHES		
	MIN	NOM	MAX	MIN	NOM	MAX
A	15.67	---	16.07	0.617	---	0.633
B	9.96	---	10.36	0.392	---	0.408
C	---	7.00	---	---	0.275	---
D	3.20	---	3.40	0.126	---	0.134
E	15.60	---	16.00	0.614	---	0.630
G	9.45	---	10.05	0.372	---	0.396
H	6.48	---	6.88	0.255	---	0.279
I	2.34	---	2.74	0.092	---	0.108
J	---	0.70	---	---	0.028	---
K	---	1.00	---	---	0.039	---
M	0.45	---	0.60	0.018	---	0.024
N	2.56	---	2.96	0.101	---	0.117
O	---	1.80	---	---	0.071	---
P	---	6.50	---	---	0.256	---
Q	---	1.50	---	---	0.059	---
R	4.50	---	4.90	0.177	---	0.193
b	---	---	1.47	---	---	0.058
b1	0.70	---	0.90	0.028	---	0.035
b2	0.25	---	0.45	0.010	---	0.018
e	---	2.54	---	---	0.100	---

IMPORTANT NOTICE

Champion Microelectronic Corporation (CMC) reserves the right to make changes to its products or to discontinue any integrated circuit product or service without notice, and advises its customers to obtain the latest version of relevant information to verify, before placing orders, that the information being relied on is current.

A few applications using integrated circuit products may involve potential risks of death, personal injury, or severe property or environmental damage. CMC integrated circuit products are not designed, intended, authorized, or warranted to be suitable for use in life-support applications, devices or systems or other critical applications. Use of CMC products in such applications is understood to be fully at the risk of the customer. In order to minimize risks associated with the customer's applications, the customer should provide adequate design and operating safeguards.

HsinChu Headquarter

5F-1, No. 11, Park Avenue II,
Science-Based Industrial Park,
HsinChu City, Taiwan
TEL: +886-3-567 9979
FAX: +886-3-567 9909

Sales & Marketing

11F, No. 306-3, SEC. 1, Ta Tung Road,
Hsichih, Taipei Hsien 221, Taiwan
TEL: +886-2-8692 1591
FAX: +886-2-8692 1596
