

### SPECIFICATIONS

Contact Rating:	As per individual switch
Initial Contact Resistance:	Less than 20 milliohms
Insulation Resistance:	500VDC – 100 milliohms
Dielectric Strength:	500V AC for 1 minute between any terminal and frame
Operating Temperature:	-20°C to +70°C (-4°F to +158°F)
Soldering:	Auto 270 ± 5°C/3 seconds; Manual 350 ± 10°C/3 seconds
Life:	10,000 cycles minimum
Timing:	See individual specifications
	For special applications, contact factory

### MATERIALS

Contact:	Silver plated copper alloy
----------	----------------------------

### HOW TO ORDER

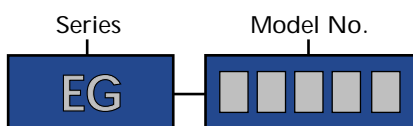

EXAMPLE

EG → 1201A

SPECIFICATIONS SUBJECT TO CHANGE WITHOUT NOTICE.

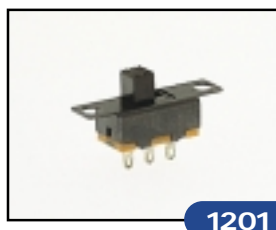

1201

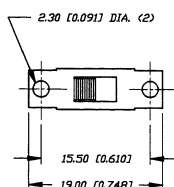

Model No.	L
EG1201	4
EG1201A	5.5

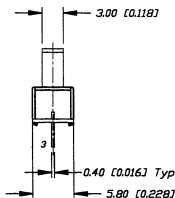
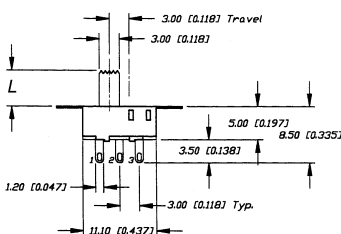

### PANEL MOUNT

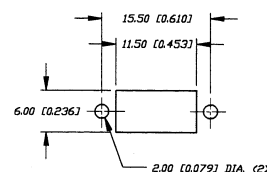

### Schematic

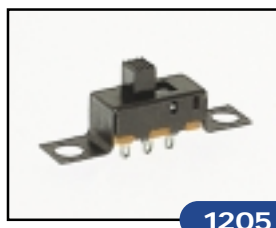
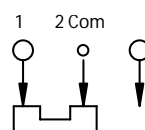

1205

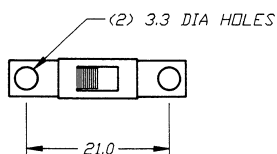

Model No.	L
EG1205	4
EG1205A	5.5

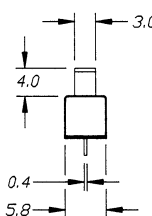
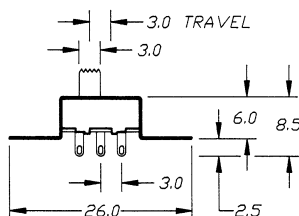

### P.C. MOUNTING

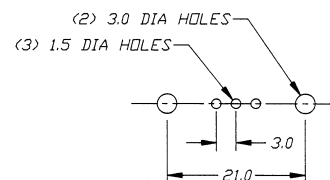

### Schematic

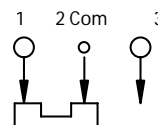

# SERIES E G SWITCHES

## SLIDE SWITCHES

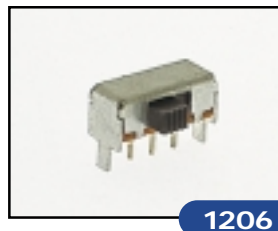

1206

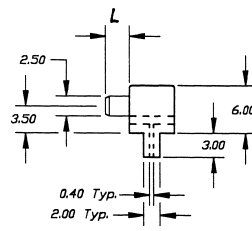
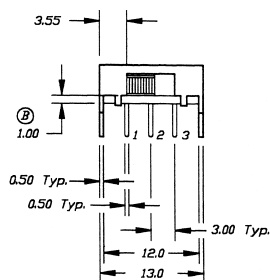
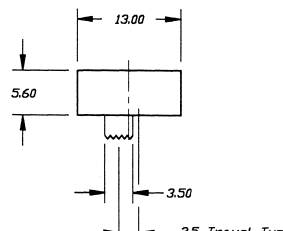

### P.C. MOUNTING

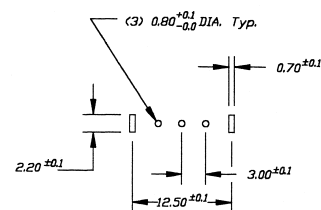

### Schematic

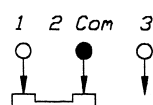

1213

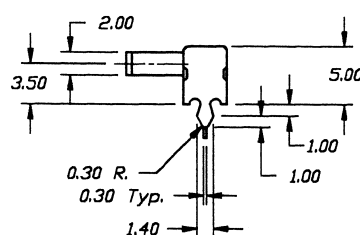
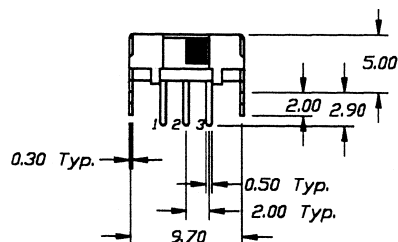
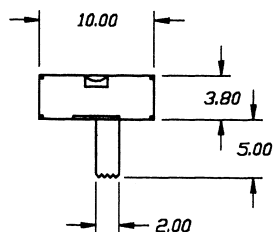

### P.C. MOUNTING

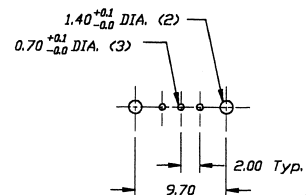

### Schematic

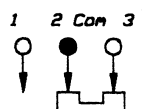

1218

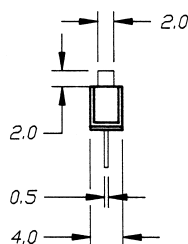
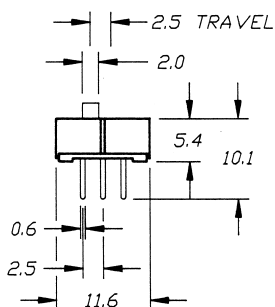

### P.C. MOUNTING

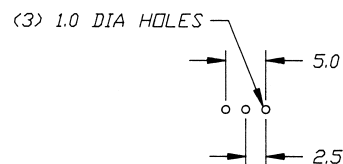

### Schematic

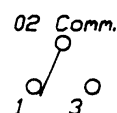

SPECIFICATIONS SUBJECT TO CHANGE WITHOUT NOTICE.

# SERIES E G SWITCHES

## SLIDE SWITCHES

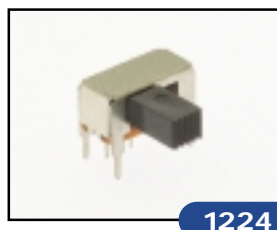

1224

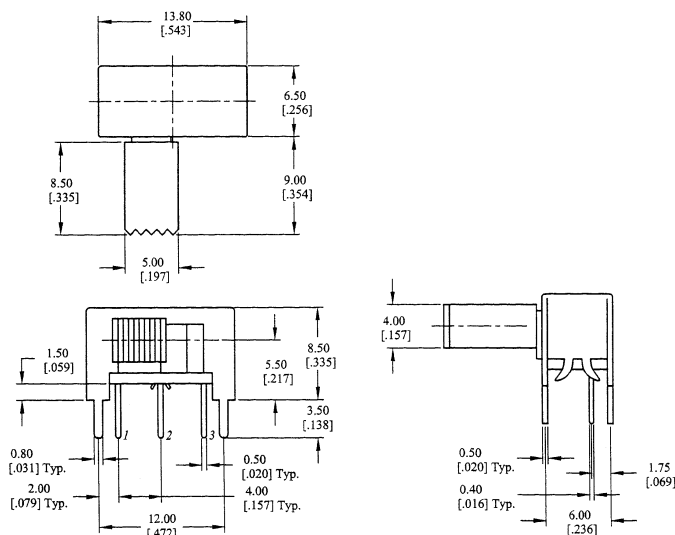

### P.C. MOUNTING

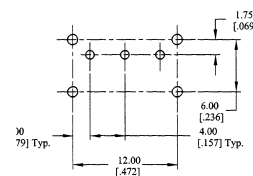

### Schematic

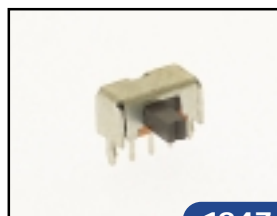
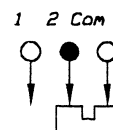

1247

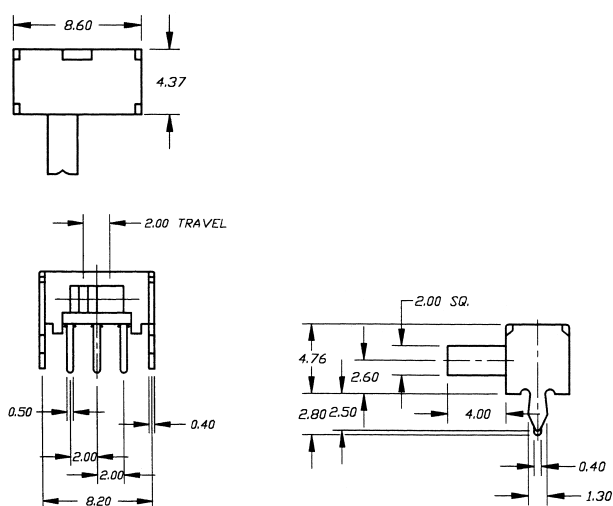

### P.C. MOUNTING

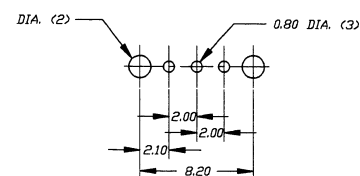

### Schematic

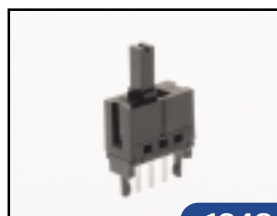
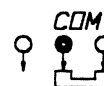

1248

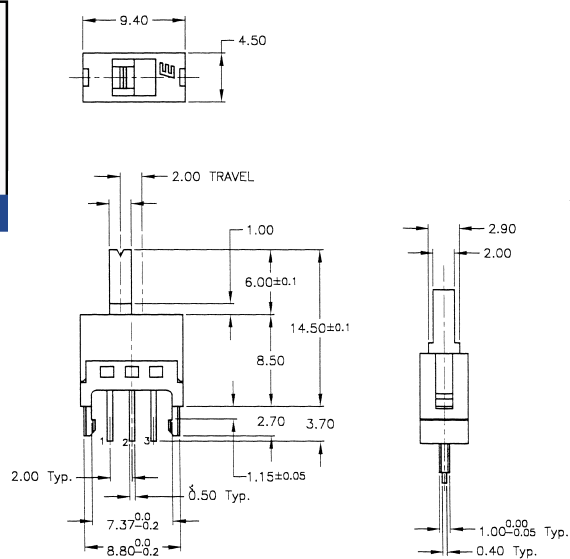

### P.C. MOUNTING

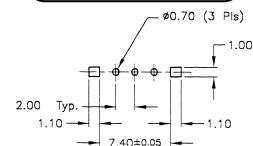

### Schematic

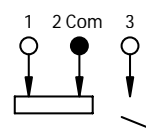

SPECIFICATIONS SUBJECT TO CHANGE WITHOUT NOTICE.

## SLIDE SWITCHES

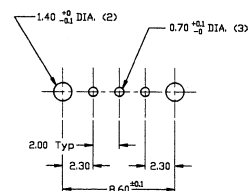

## Schematic

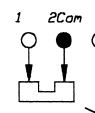

## P.C. MOUNTING

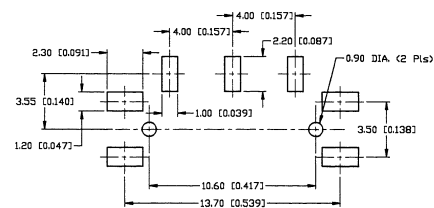

## Schematic

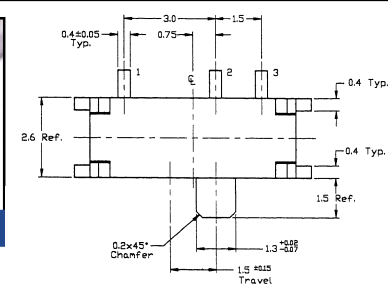
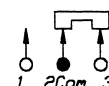

## P.C. MOUNTING

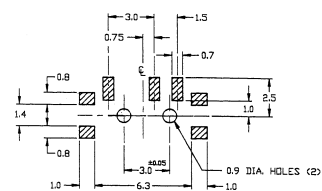

## Schematic

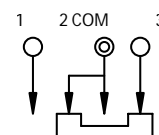

SPECIFICATIONS SUBJECT TO CHANGE WITHOUT NOTICE.

# SERIES E G SWITCHES

## SLIDE SWITCHES



1270

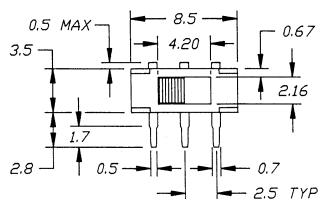

### P.C. MOUNTING

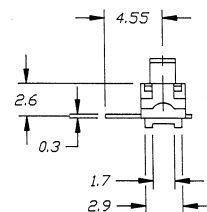
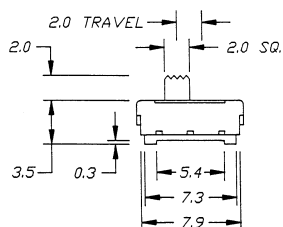
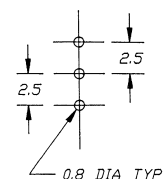

### Schematic

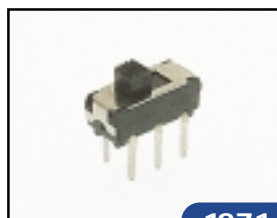

1271

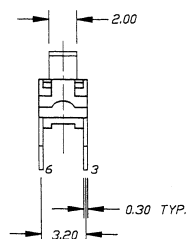
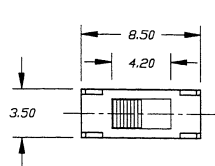

### P.C. MOUNTING

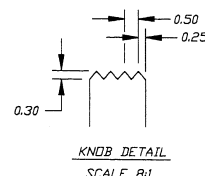
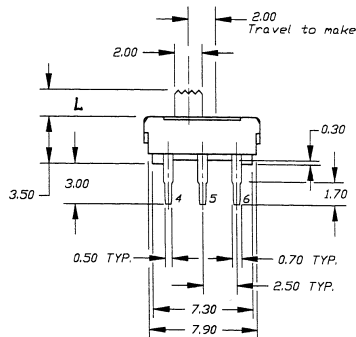
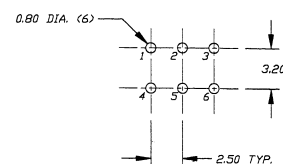

### Schematic

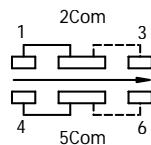

Model No.	L
EG1271	2
EG1271A	4.4



1302

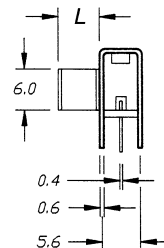
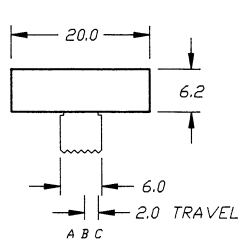

### P.C. MOUNTING

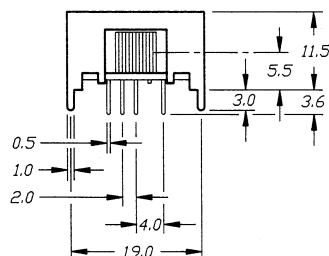
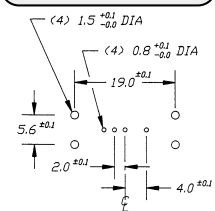

### Schematic

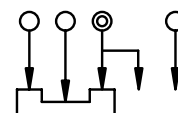

Model No.	L
EG1302	6
EG1302A	9

SPECIFICATIONS SUBJECT TO CHANGE WITHOUT NOTICE.