



# EVERLIGHT ELECTRONICS CO.,LTD.

Device Number : DAE-069-421 REV: 1.0

MODEL NO : A694B/SURSYGW/S530-A2 ECN :            Page: 1/7

## ■ Package Dimensions:

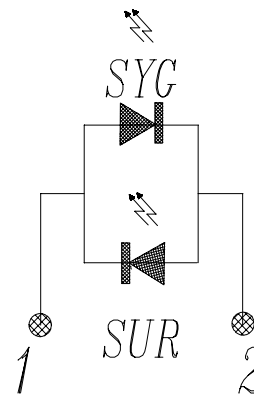
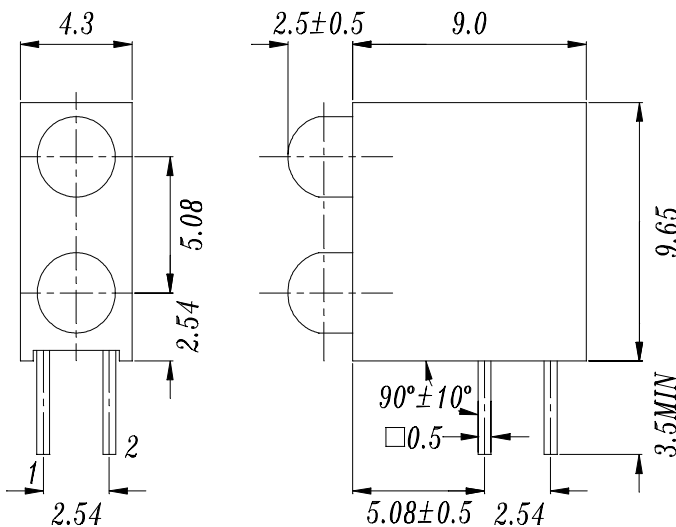

## ■ Notes:

- 1.All dimensions are in millimeters, tolerance is 0.25mm except be specified
- 2.Lead spacing is measured where the lead emerge from the package

LED PART NO	CHIP		Lens Color
	Material	Emitted Color	
234SURSYGW/S530-A2	AlGaInP	Hyper Red	White Diffused
	AlGaInP	Super Yellow Green	

B89030470,890378

Office : NO 25,Lane 76, Chung Yang Rd, Sec.3, Tucheng, Taipei 236, Taiwan, R.O.C.

TEL : 886-2-2267-2000,2266-9936(22 Lines)

FAX : 886-2-2267-6189

http: //www.everlight.com



## ■ Descriptions:

- 1.ARRAY=Plastic Holder+Combinations of Lamp
- 2.The array will easily mount the applicable lamps on any panel

## ■ Features:

- 1.Low power consumption
- 2.High efficiency and low cost
- 3.Good control and free combinations on the colors of LED lamps
- 5.Good lock and easy to assembly
- 6.Stackable and easy to assembly
- 7.Stackable vertically and easy to assembly
- 8.Versatile mounting on PCB or panel
- 9.Stackable horizontally and easy to assembly

## ■ Applications:

- 1.Used as indicators of indicating the degree, functions, positions etc, in electronic instruments.



EVERLIGHT ELECTRONICS CO.,LTD.

Device Number : DAE-069-421 REV: 1.0

MODEL NO : A694B/SURSYGW/S530-A2 ECN :            Page: 3/7

■ LED LAMP ARRAYS SELECTION GUIDE:

A      694      B /      SURSYGW/S530-A2

SYG: Super Yellow Green

UY: Super Yellow

SUR: Hyper Red

COLOR OF HOLDER(BLACK)

MODEL

ARRAY

**Absolute Maximum Ratings at Ta = 25°C****SUR**

Parameter	Symbol	Rating	Unit
Forward Current	If	25	mA
Operating Temperature	Topr	-40 to +85	°C
Storage Temperature	Tstg	-40 to +100	°C
Soldering Temperature	Tsol	260 ± 5	°C
Electrostatic Discharge	ESD	2000	V
Power Dissipation	Pd	60	mW
Peak Forward Current(Duty 1/10 @ 1KHZ)	If(Peak)	160	mA
Reverse Voltage	Vr	5	V

**Electronic Optical Characteristics :**

Parameter	Symbol	MIN.	TYP.	MAX.	Unit	Condition
Luminous intensity	Iv	---- 16	1.5 25	/	mcd	If= 20 mA
Viewing Angle	2 θ 1/2	/	45	/	deg	If= 20 mA
Peak Wavelength	λ p	/	632	/	nm	If= 20 mA
Dominant Wavelength	λ d	/	624	/	nm	If= 20 mA
Spectrum Radiation Bandwidth	△ λ	/	20	/	nm	If= 20 mA
Forward Voltage	Vf	/	2.0	2.4	V	If= 20 mA
Reverse Current	Ir	/	/	10	μ A	Vr= 5 V



## ■ Absolute Maximum Ratings at Ta = 25°C

SYG

Parameter	Symbol	Rating	Unit
Forward Current	If	25	mA
Operating Temperature	Topr	-40 to +85	°C
Storage Temperature	Tstg	-40 to +100	°C
Soldering Temperature	Tsol	260 ± 5	°C
Electrostatic Discharge	ESD	2000	V
Power Dissipation	Pd	60	mW
Peak Forward Current(Duty 1/10 @ 1KHZ)	If(Peak)	160	mA
Reverse Voltage	Vr	5	V

## ■ Electronic Optical Characteristics :

Parameter	Symbol	MIN.	TYP.	MAX.	Unit	Condition
Luminous intensity	Iv	----- 16	1.5 25	/	mcd	If= 20 mA
Viewing Angle	2 θ 1/2	/	45	/	deg	If= 20 mA
Peak Wavelength	λ p	/	575	/	nm	If= 20 mA
Dominant Wavelength	λ d	/	573	/	nm	If= 20 mA
Spectrum Radiation Bandwidth	△ λ	/	20	/	nm	If= 20 mA
Forward Voltage	Vf	/	2.0	2.4	V	If= 20 mA
Reverse Current	Ir	/	/	10	μ A	Vr= 5 V



## ■ Typical Electro-Optical Characteristic Curves

SUR

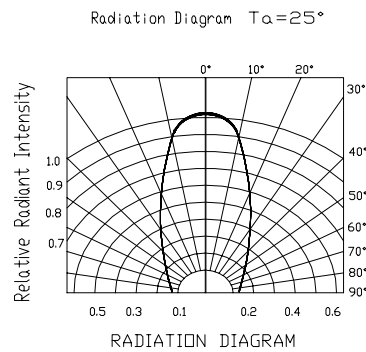
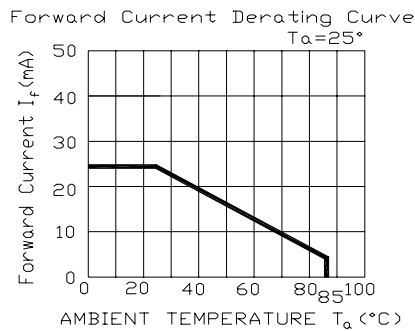
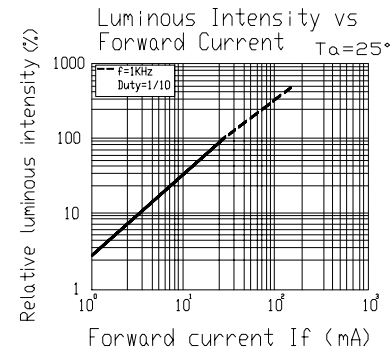
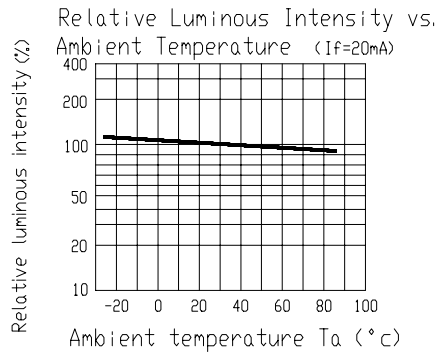
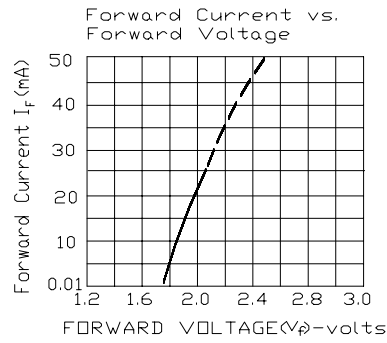
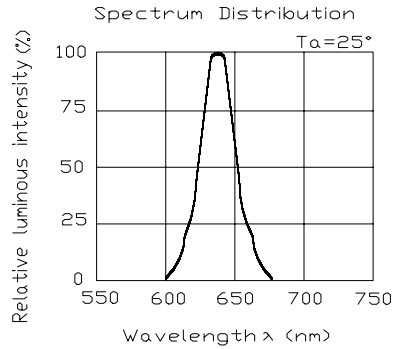



## ■ Typical Electro-Optical Characteristic Curves

SYG

