

Technical Data Sheet

0.4" Dual Digit Displays

ELD-425GWA

■ Features :

- Industrial standard size.
- Low power consumption.
- Categorized for luminous intensity.
- Pb free

■ Descriptions :

- The ELD-425 series is a large 10.16 mm (0.4") high seven segment display designed for viewing distances up to 7 meters.
- These displays provide excellent reliability in bright ambient light.
- These devices are made with white segments and gray surface.

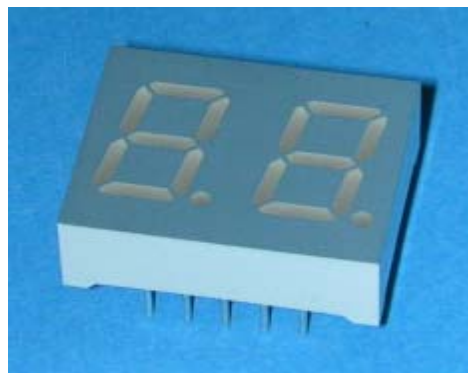

■ Applications :

- Audio equipment
- Instrument panels
- Digital read out display

| PART NO. | Chip | |
|------------|----------|---------------|
| | Material | Emitted Color |
| ELD-425GWA | GaP | Green |



Technical Data Sheet 0.4" Dual Digit Displays

ELD-425GWA

Package Dimensions

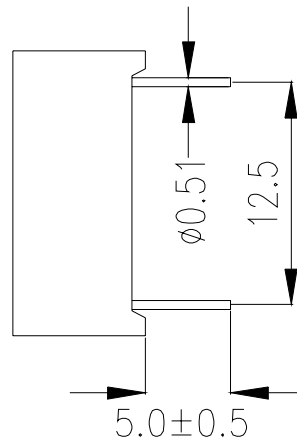
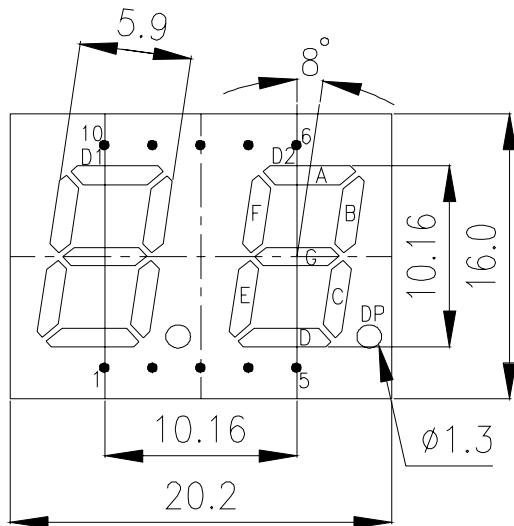

COMMON CATHODE

- 1 ANODE D
- 2 ANODE DP
- 3 ANODE E
- 4 ANODE C
- 5 COMMON CATHODE D2
- 6 ANODE B
- 7 ANODE A
- 8 ANODE F
- 9 ANODE G
- 10 COMMON CATHODE D1

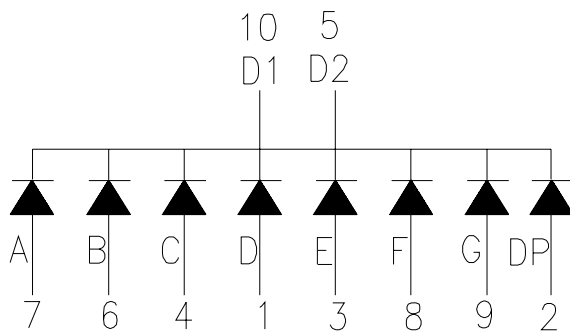
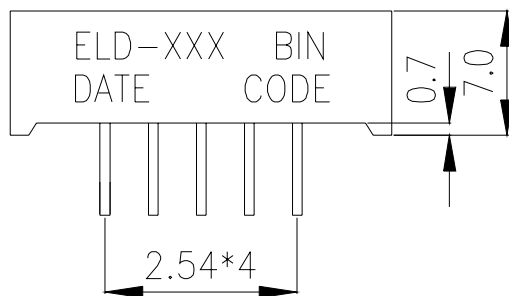

Notes: 1.All dimensions are in millimeters , tolerance is 0.25mm unless otherwise noted.

2.Above specification may be changed without notice.

Supplier will reserve authority on material change for above specification.

**Technical Data Sheet**
0.4" Dual Digit Displays**ELD-425GWA**

■ Absolute maximum ratings at Ta = 25°C :

| Parameter | Symbol | Rating | Unit |
|----------------------------------------|-----------------------|-------------|------|
| Reverse Voltage | V _R | 5 | V |
| Forward Current | I _F | 30 | mA |
| Operating Temperature | T _{opr} | -40 to +85 | °C |
| Storage Temperature | T _{stg} | -40 to +100 | °C |
| Soldering Temperature | T _{sol} | 260 ± 5 | °C |
| Power Dissipation | P _d | 100 | mW |
| Peak Forward Current(Duty 1/10 @ 1KHZ) | I _F (Peak) | 160 | mA |

■ Electronic optical characteristics :

| Parameter | | Symbol | Min. | Typ. | Max. | Unit | Condition |
|------------------------------|-------------------|----------------|------|------|------|------|----------------------|
| Luminous Intensity | Per segment | I _v | 1.1 | 2.8 | ---- | mcd | I _F =10mA |
| | Per decimal point | | 0.5 | 1.0 | ---- | mcd | I _F =10mA |
| Peak Wavelength | | λ _p | ---- | 565 | ---- | nm | I _F =20mA |
| Dominant Wavelength | | λ _d | ---- | 570 | ---- | nm | I _F =20mA |
| Spectrum Radiation Bandwidth | | Δλ | ---- | 30 | ---- | nm | I _F =20mA |
| Forward Voltage | | V _F | 1.7 | 2.1 | 2.4 | V | I _F =20mA |
| Reverse Current | | I _R | ---- | ---- | 10 | μA | V _R =5V |



Technical Data Sheet 0.4" Dual Digit Displays

ELD-425GWA

■ Typical Electro-Optical Characteristic Curves:

GHIP Material:Gap
Emitted Color:Yellow Green

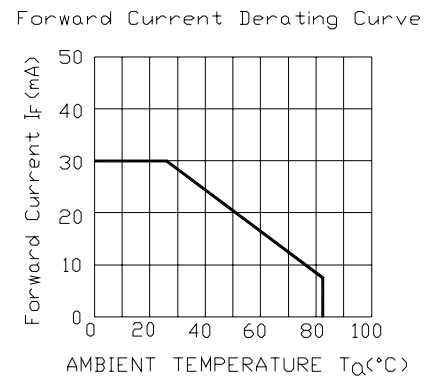
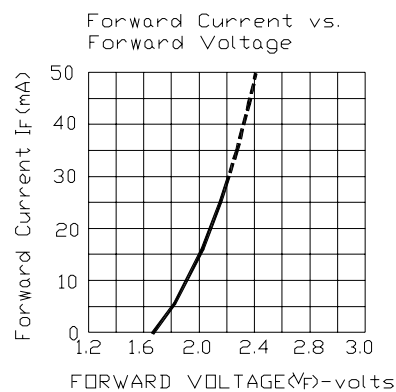
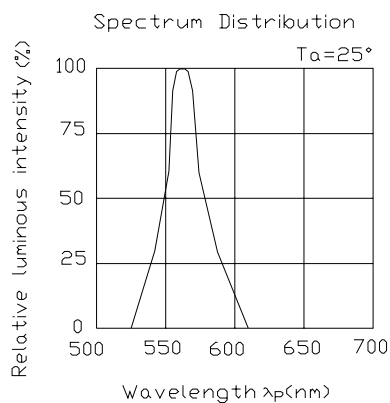

**Technical Data Sheet**
0.4" Dual Digit Displays**ELD-425GWA****■ Reliability test items and conditions:**

| NO | Item | Test Conditions | Test Hours/Cycle | Sample Size | Ac/Re |
|----|----------------------------------|-----------------------------------------------|------------------|-------------|-------|
| 1 | Solder Heat | TEMP : 260°C ± 5 °C | 5 SEC | 76 PCS | 0/1 |
| 2 | Temperature Cycle | H : +85°C 30min § 5 min L : -55°C 30min | 50 CYCLE | 76 PCS | 0/1 |
| 3 | Thermal Shock | H : +100°C 5min § 10 sec L : -10°C 5min | 50 CYCLE | 76 PCS | 0/1 |
| 4 | High Temperature Storage | TEMP : 100°C | 1000 HRS | 76 PCS | 0/1 |
| 5 | Low Temperature Storage | TEMP : -55°C | 1000 HRS | 76 PCS | 0/1 |
| 6 | DC Operating Life | IF = 10 mA | 1000 HRS | 76 PCS | 0/1 |
| 7 | High Temperature / High Humidity | 85°C/85% RH | 1000 HRS | 76 PCS | 0/1 |