

8.0 Amp SINGLE PHASE SILICON BRIDGE

KBU800 . . . 810 Series

Description



Mechanical Dimensions

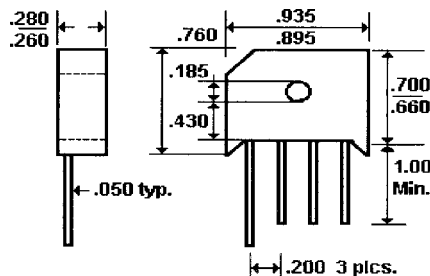

Mechanical Data: Weight - 0.3 Ounces. Mounting Torque - 5.1 lbs. Mounting Position - Any.

Features

- **COMPACT SIZE**
- **300 AMP SURGE OVERLOAD RATING**
- **LOW LEAKAGE CURRENT**
- **MEETS UL SPECIFICATION 94V-0**

Electrical Characteristics @ 25°C.		KBU800 . . . 810 Series							Units
Maximum Ratings		KBU800	KBU801	KBU802	KBU804	KBU806	KBU808	KBU810	
Peak Repetitive Reverse Voltage... V_{RRM}		50	100	200	400	600	800	1000	Volts
RMS Reverse Voltage... $V_{R(rms)}$		35	70	140	280	420	560	700	Volts
DC Blocking Voltage... V_{DC}		50	100	200	400	600	800	1000	Volts
Average Forward Rectified Current... $I_{F(av)}$ $T_A = 25^\circ\text{C}$		8.0							Amps
Non-Repetitive Peak Forward Surge Current... I_{FSM} 8.3 mS Single ½ Sine Wave Imposed on Rated Load		300							Amps
Rating for Fusing ($T < 8.3\text{mS}$)		167							A°S
Forward Voltage... V_F Per Leg @ 8.0 Amps		1.0							Volts
DC Reverse Current... I_R @ Rated DC Blocking Voltage	$T_A = 25^\circ\text{C}$	10							μAmps
	$T_A = 125^\circ\text{C}$	1.0							mAmps
Typical Thermal Resistance... $R_{\theta JC}$ (Alum Heat Sink)		6.0							°C / W
Thermal Resistance... $R_{\theta JA}$ (Free Air)		8.0							°C / W
Typical Junction Capacitance... C_j		< 210				< 90			pF
Operating & Storage Temperature Range... T_J, T_{STRG}		-55 to 150							°C

8.0 Amp SINGLE PHASE SILICON BRIDGE

KBU800 ... 810 Series

Forward Current Derating Curve

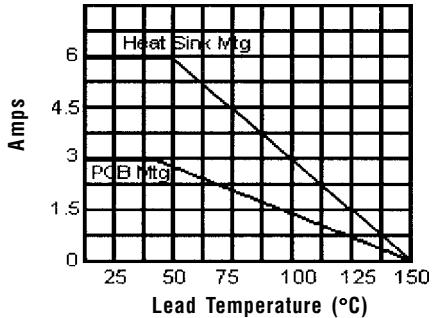

**Non-Repetitive
Peak Forward Surge Current**

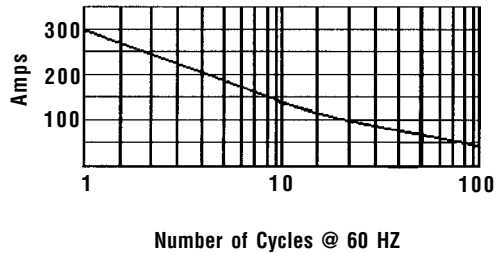

Typical Instantaneous Forward Characteristics

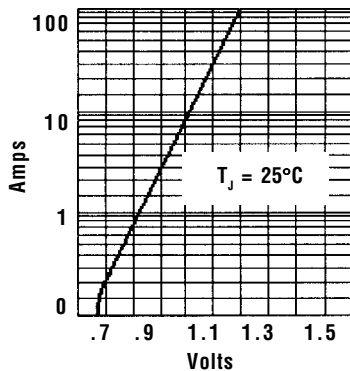

Typical Reverse Characteristics

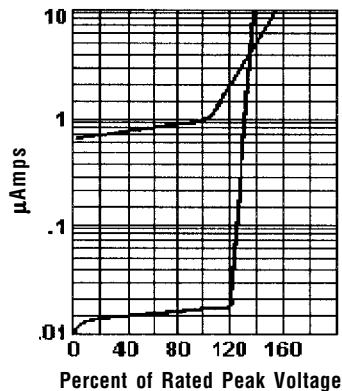

Typical Junction Capacitance

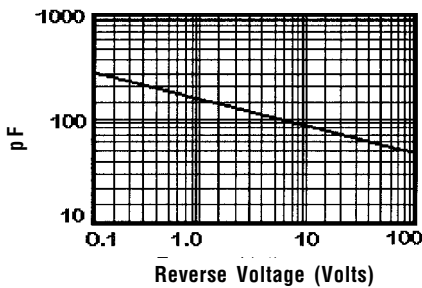

Electrical Description

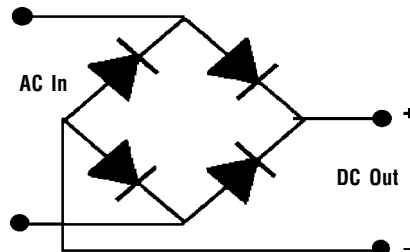

Ratings at
25 Deg. C ambient
temperature
unless otherwise
specified.

Single Phase Half
Wave, 60 HZ
Resistive or
Inductive Load.

For Capacitive
Load, Derate
Current by 20%.