

4mm SQUARE THIN TYPE ISOLATOR

MODEL **ESI-4DC** **[]** **0911** **M** **01-** **T**

(1) (2) (3) (4) (5) (6)

(1) Series ESI-4DC ; 1.8mm Height

(2) Rotating Direction (R or L)

(3) Center Frequency

(4) M ; MHz

(5) Control No.

(6) T ; Taping

Blank ; Bulk

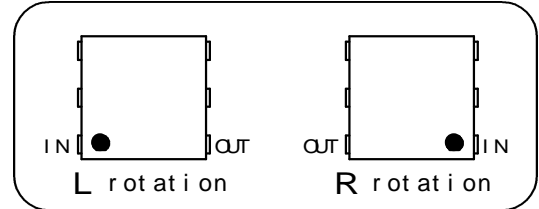

Target Specification

Frequency (MHz)	Ins. Loss Max. (dB)	Isolation Min. (dB)	V.S.W.R. Max.	Attenuation		Handling Power Max. (W)	Reflection Power Max. (W)
				at 2f Min. (dB)	at 3f Min. (dB)		
898-925	0.75	12	1.6	15	15	5.0	1.0

Operating Temperature(deg.C) ; -35 to +85

Impedance ; 50 ohms Typ.

Shape & Size

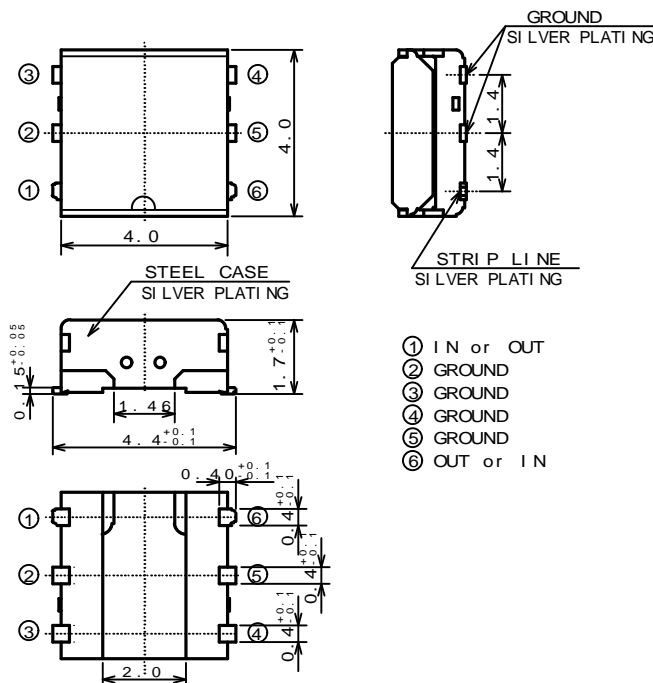

UNLESS OTHERWISE SPECIFIED
ALL DIMENSIONS ARE IN mm
TOLERANCES ARE +/-0.2mm

TBE128

Note) This is tentative specifications under development.

There is some possibility which the specifications might be modified including mechanical dimensions.



Hitachi Metals, Ltd. Tottori Works