

# Ledtech ALPHANUMERIC DISPLAY

## 0.39" SINGLE ALPHANUMERIC DISPLAY Electrical/Optical Characteristics at T<sub>A</sub>=25°C & I<sub>F</sub>=20mA

PART NUMBER	CHIP COLOR	λ <sub>p</sub> (nm)	V <sub>F</sub> (V)		I <sub>v</sub> (mcd)	
COMMON ANODE (COMMON CATHODE)		TYP.	TYP.	MAX.	MIN.	TYP.
LA(C)3921-11BEWAK	GREEN	572	2.1	2.4	3.9	6.5
LA(C)3931-11BEWAK	YELLOW	589	2.1	2.4	3.1	5.2
LA(C)3941-11BEWAK	ORANGE	630	2.1	2.4	4.5	7.4
LA(C)3941R-11BRRAK	ORANGE	630	2.1	2.4	4.5	7.4
LA(C)3951-11BEWAK	RED	700	2.1	2.4	1.1	1.8

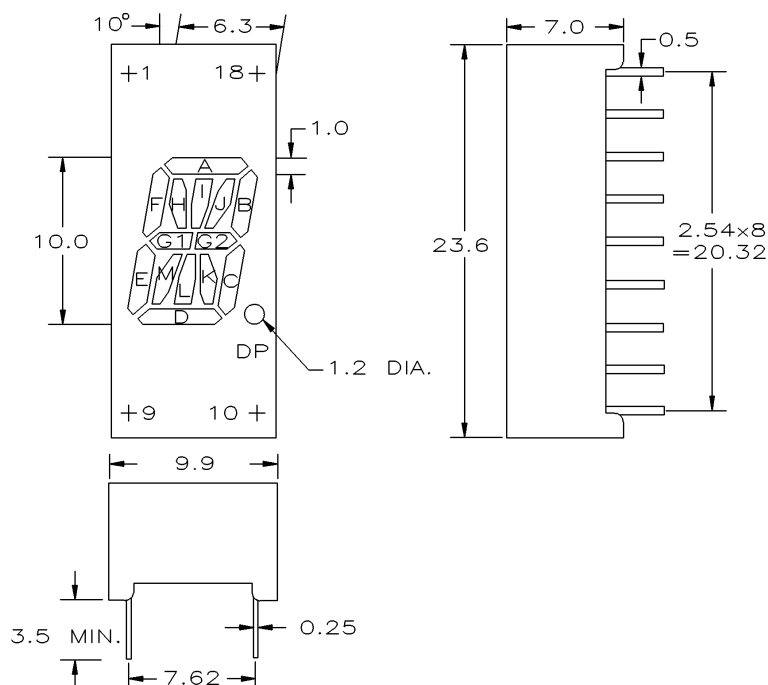

LA39X1-11B  
COMMON ANODE

PIN NO.	FUNCTION	PIN NO.	FUNCTION
1. CATHODE	I	10. CATHODE	K
2. CATHODE	H	11. CATHODE	C
3. CATHODE	F	12. CATHODE	DP
4. COMMON ANODE		13. COMMON ANODE	
5. CATHODE	G1	14. CATHODE	G2
6. CATHODE	E	15. CATHODE	B
7. CATHODE	M	16. CATHODE	J
8. CATHODE	D	17. COMMON ANODE	
9. CATHODE	L	18. CATHODE	A

LC39X1-11B  
COMMON CATHODE

PIN NO.	FUNCTION	PIN NO.	FUNCTION
1. ANODE	I	10. ANODE	K
2. ANODE	H	11. ANODE	C
3. ANODE	F	12. ANODE	DP
4. COMMON CATHODE		13. COMMON CATHODE	
5. ANODE	G1	14. ANODE	G2
6. ANODE	E	15. ANODE	B
7. ANODE	M	16. ANODE	J
8. ANODE	D	17. COMMON CATHODE	
9. ANODE	L	18. ANODE	A