

Ledtech SINGLE DIGIT DISPLAY

0.8" SINGLE DIGIT DISPLAY Electrical/Optical Characteristics at T_A=25°C & I_F=20mA

CHIP COLOR	0.8 inch SINGLE DIGIT		0.8 inch SINGLE DIGIT		λ p (nm)	V _F (V)	I _V (mcd)	
	COMMON ANODE	COMMON CATHODE	COMMON ANODE	COMMON CATHODE	TYP.	TYP.	MIN.	TYP.
GREEN	LA8021-11	LC8021-11	LA8021-21	LC8021-21	572	2.1	4.5	7.4
YELLOW	LA8031-11	LC8031-11	LA8031-21	LC8031-21	589	2.1	3.7	6.1
ORANGE	LA8041-11	LC8041-11	LA8041-21	LC8041-21	630	2.1	5.1	8.6
ORANGE	LA8041R-11	LC8041R-11	LA8041R-21	LC8041R-21	630	2.1	5.1	8.6
RED	LA8071-11-M1	LC8071-11-M1	LA8071- 21-M1	LC8071- 21-M1	660	1.7	12.1	20.1
RED	LA8051-11	LC8051-11	LA8051- 21	LC8051- 21	700	2.1	1.4	2.3

LA80X1-11 COMMON ANODE PIN

NO.	FUNCTION
1. CATHODE	A
2. CATHODE	F
3. COMMON	ANODE
4. CATHODE	E
5. COMMON	ANODE
6. CATHODE	LHDP
7. NO PIN	
8. NO PIN	
9. CATHODE	RHDP
10. CATHODE	D
11. COMMON	ANODE
12. CATHODE	C
13. CATHODE	G
14. CATHODE	B
15. NO PIN	
16. COMMON	ANODE

LC80X1-11 COMMON CATHODE PIN

NO.	FUNCTION
1. ANODE	A
2. ANODE	F
3. COMMON	CATHODE
4. ANODE	E
5. COMMON	CATHODE
6. ANODE	LHDP
7. NO PIN	
8. NO PIN	
9. ANODE	RHDP
10. ANODE	D
11. COMMON	CATHODE
12. ANODE	C
13. ANODE	G
14. ANODE	B
15. NO PIN	
16. COMMON	CATHODE

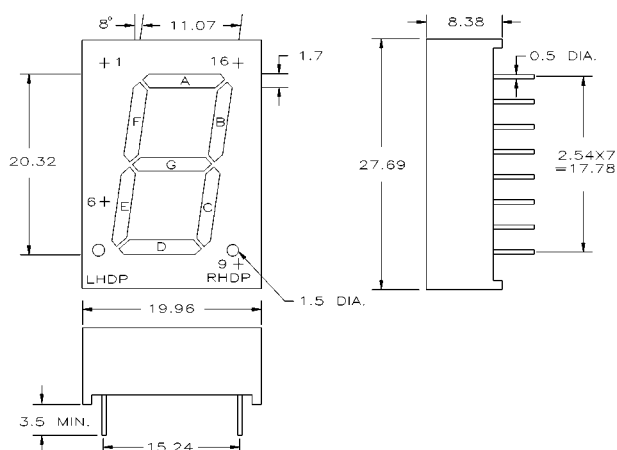

LA80X1- 21 COMMON ANODE PIN

NO.	FUNCTION
1. NO PIN	
2. CATHODE	A
3. CATHODE	F
4. COMMON	ANODE
5. CATHODE	E
6. NO PIN	
7. CATHODE	E
8. NO PIN	
9. CATHODE	D
10. CATHODE	DP
11. CATHODE	D
12. COMMON	ANODE
13. CATHODE	C
14. CATHODE	G
15. CATHODE	B
16. NO PIN	
17. COMMON	ANODE
18. NO PIN	

LC80X1- 21 COMMON CATHODE PIN

NO.	FUNCTION
1. NO PIN	
2. ANODE	A
3. ANODE	F
4. COMMON	CATHODE
5. ANODE	E
6. NO PIN	
7. ANODE	E
8. NO PIN	
9. COMMON	CATHODE
10. ANODE	DP
11. ANODE	D
12. COMMON	CATHODE
13. ANODE	C
14. ANODE	G
15. ANODE	B
16. NO PIN	
17. COMMON	CATHODE
18. NO PIN	

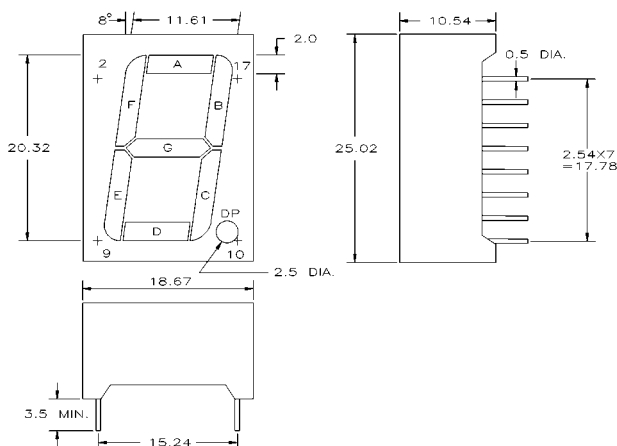

NOTES : 1.ALL DIMENSIONS ARE IN mm, TOLERANCE IS $\pm 0.25\text{mm}$ (0.01") UNLESS OTHERWISE NOTED.
2.THE SLOPE ANGLE OF ANY PIN MAY BE $\pm 5^\circ$ MAX.