

DATE	REVISIONS	REV
5-27-93	ADDED NOTES/	A
6-17-93	ADDED NOTE 4/	B
7-15-93	ADDED MATERIAL NOTES/	C
8-2-93	CHG'D NOTE 4/	D

DRAWING NUMBER SSI-LXN730SRD	REV D
---------------------------------	----------

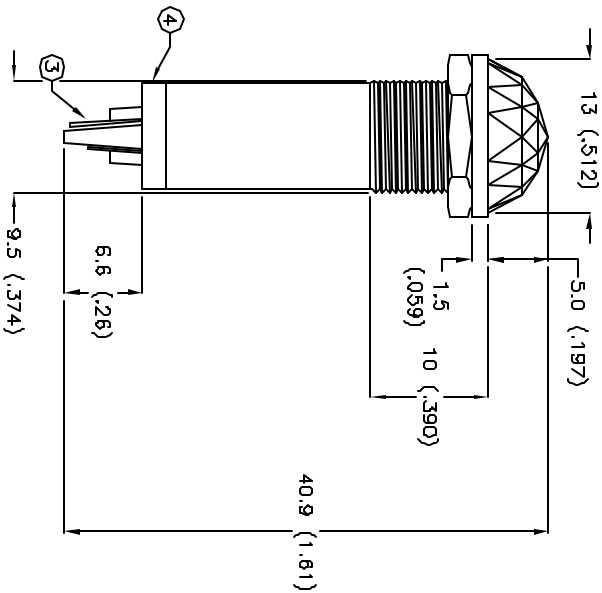
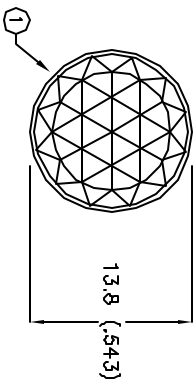

PANEL CUTOUT: 9.9⁺⁰_{-0.2} (3/8").

NOTES:

- SSI-LXN730R HOUSING & BUSHING KIT.
HOUSING MATERIAL: ACRYLIC
BUSHING MATERIAL: PHENOLIC
- SSL-LX5093SRT OR SSL-LX5093SRC.
- LONG LEAD DENOTES ANODE.
- BOND LED BASE AND LENS WITH LOCTITE #454 OR EQUIVALENT.

UNLESS OTHERWISE SPECIFIED TOLERANCE IS $\pm .25\text{mm}$ ($\pm 0.010"$)

ELECTRO-OPTICAL CHARACTERISTICS TA=25 °C If=20mA

PARAMETER	MIN	TYP	MAX	UNITS	TEST COND
PEAK WAVELENGTH		660 (RED)		nm	
FORWARD VOLTAGE		1.7	2.2	V _f	
REVERSE VOLTAGE	4.0			V _r	If=100uA
EMITTED COLOR:	RED				
HOUSING COLOR:	RED				

LIMITS OF SAFE OPERATION AT 25 DEG. C

PARAMETER	MAX	UNITS
PEAK FORWARD CURRENT*	155	mA
STEADY CURRENT	30	mA
POWER DISSIPATION	55	mW
DERATE FROM 25 °C	-1.3	mW/°C
OPERATING, STORAGE TEMP.	-25 TO +85	°C

*t<10US

LUMEX
OPTO COMPONENTS INC.

290 E. HELLEN ROAD
PALATINE, ILLINOIS 60067
(847) 359-2790

CONFIDENTIAL INFORMATION
THE INFORMATION CONTAINED IN THIS DOCUMENT IS THE PROPERTY OF LUMEX OPTO/COMPONENTS, INC. EXCEPT AS SPECIFICALLY AUTHORIZED IN WRITING BY LUMEX OPTO/COMPONENTS, INC., THE HOLDER OF THIS DOCUMENT SHALL KEEP ALL INFORMATION CONTAINED HEREIN CONFIDENTIAL AND SHALL PROTECT SAME IN WHOLE OR IN PART FROM DISCLOSURE AND DISSEMINATION TO ALL THIRD PARTIES.

DATE: 5-29-92	DWN:	CHK'D:	APP'D:
SCALE: N/A			

T-13 DIAMOND CUT LENS LED
PANEL INDICATOR

PAGE 1 OF 1	DRAWING NUMBER SSI-LXN730SRD	REV D
-------------	---------------------------------	----------