

### LC503PPG1-30Q

#### Features

5mm Package  
High Optical Power  
High Luminous Intensity  
Water Clear Lens  
All Plastic Mold Type  
PRELIMINARY SPEC

#### Applications

Outdoor Message Centers  
VMS  
Automotive Interior Lighting  
Traffic Signals  
Pedestrian Signals  
Decorative Lighting



### ATTENTION

OBSERVE PRECAUTIONS  
ELECTROSTATIC  
SENSITIVE DEVICES

#### Maximum Ratings (Ta=25°C)

Characteristic	Symbol	Max.	Unit
Forward Current	I <sub>F</sub>	25	mA
Reverse Voltage	V <sub>R</sub>	5	V
Power Dissipation	P <sub>D</sub>	120.00	mW
Operating Temperature	T <sub>opr</sub>	-20 ~ +75	°C
Storage Temperature	T <sub>stg</sub>	-30 ~ +80	°C
Soldering Temperature	T <sub>sol</sub>	260	°C
Soldering Time	—	for 3 sec. max	—

#### Opto-Electrical Characteristics (Ta=25°C)

Characteristic	Symbol	Test Condition	Min	Typ	Max	Unit
Forward Voltage	V <sub>F</sub>	I <sub>F</sub> =20mA	3.20	3.60	4.20	V
Reverse Current	I <sub>R</sub>	V <sub>R</sub> =5V	—	—	100	μA
Luminous Intensity	I <sub>v</sub>	I <sub>F</sub> =20mA	3000.00	4800.00	—	mcd
Viewing Angle	2θ <sup>1/2</sup>	—	—	30°	—	deg.
Peak Wavelength	λ <sub>p</sub>	I <sub>F</sub> =20mA	—	520	—	nm
Dominant Wavelength	λ <sub>d</sub>	I <sub>F</sub> =20mA	—	525	—	nm
Spectral Line Half Width	Δλ	I <sub>F</sub> =20mA	—	38	—	nm

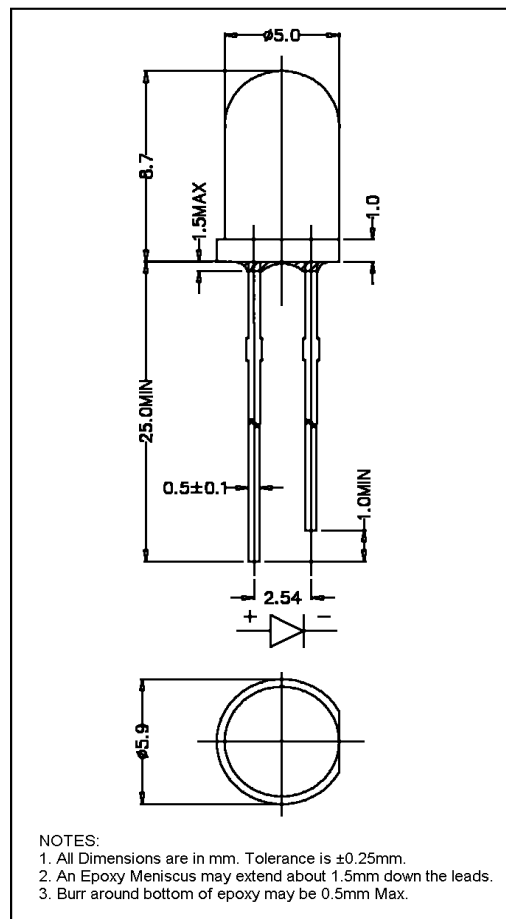

#### Company Headquarters

120 Broadway  
Menands, New York 12204  
Toll Free: 800.984.5337  
Fax: 518.432.7454



Web: [www.marktechopto.com](http://www.marktechopto.com) | Email: [info@marktechopto.com](mailto:info@marktechopto.com)

#### West Coast Sales Office

100 Oceangate Blvd. #1200  
Long Beach, CA 90802  
Toll Free: 800.984.5337  
Fax: 562.628.5572

### LC503PPG1-30Q Graphs

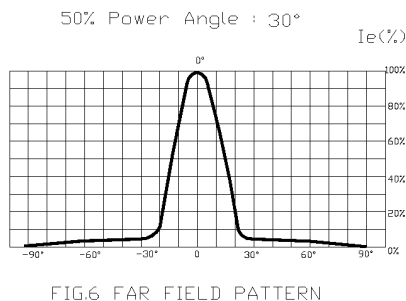
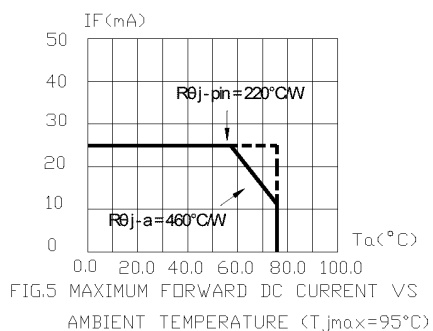
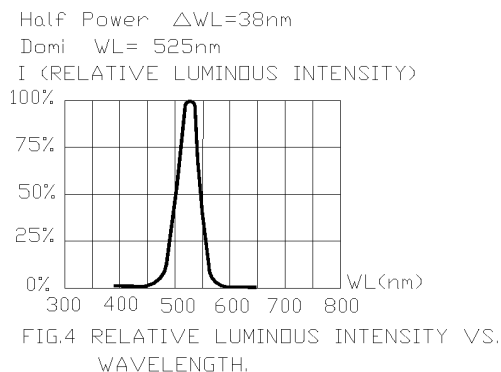
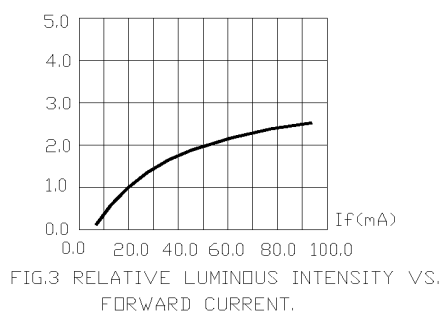
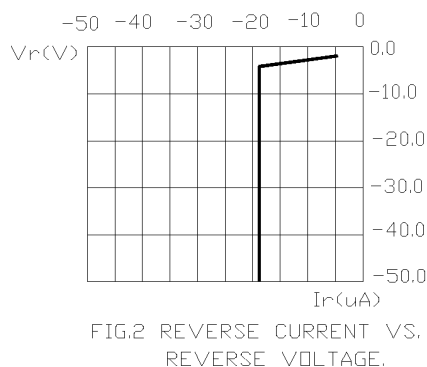
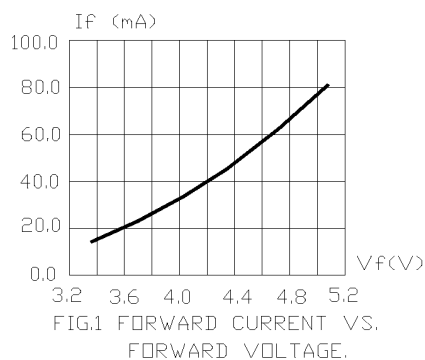

1. Cathode PAD Area ( $0.18 \times 0.18\text{inch}^2$ )
2. Height above nominal seating plane in inches (0.3inch)