

SMD POWER INDUCTORS

MODEL NO. : SPC-1004P SERIES (CD104 COMPATIBLE)

FEATURES:

- * SUPERIOR QUALITY FOR AN AUTOMATED PRODUCTION LINE.
- * PICK AND PLACE COMPATIBLE.
- * TAPE AND REEL PACKING.

APPLICATION :

- * NOTEBOOK COMPUTERS.
- * DC-DC CONVERTORS.
- * DC-AC INVERTERS.



ELECTRICAL SPECIFICATION:

(UNIT:mm)

PART NO.	INDUCTANCE (uH)	D.C.R. MAX (Ω)	RATED CURRENT (A)
SPC-1004P-100	10	0.05	2.38
SPC-1004P-120	12	0.06	2.13
SPC-1004P-150	15	0.07	1.87
SPC-1004P-180	18	0.08	1.73
SPC-1004P-220	22	0.09	1.60
SPC-1004P-270	27	0.12	1.44
SPC-1004P-330	33	0.15	1.26
SPC-1004P-390	39	0.17	1.20
SPC-1004P-470	47	0.19	1.10
SPC-1004P-560	56	0.22	1.01
SPC-1004P-680	68	0.25	0.91
SPC-1004P-820	82	0.30	0.85
SPC-1004P-101	100	0.37	0.74
SPC-1004P-121	120	0.45	0.69
SPC-1004P-151	150	0.54	0.61
SPC-1004P-181	180	0.62	0.56
SPC-1004P-221	220	0.72	0.53
SPC-1004P-271	270	0.95	0.45
SPC-1004P-331	330	1.10	0.42
SPC-1004P-391	390	1.24	0.38
SPC-1004P-471	470	1.53	0.35
SPC-1004P-561	560	1.90	0.32

PHYSICAL DIMENSION :

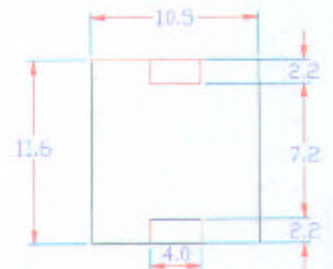
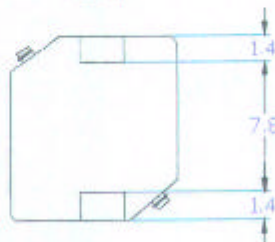
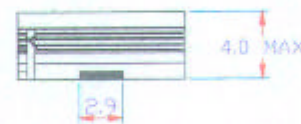
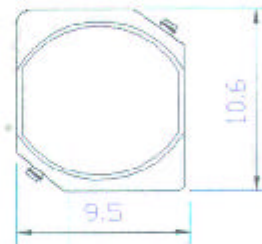

TOLERANCE : ± 0.3

PCB PATTERN

NOTE(1) : TEST FREQUENCY: 100 kHz, 1 VRMS.

NOTE(2) : 10~47uH $\pm 20\%$, 56~560uH $\pm 10\%$.

NOTE (3): THIS INDICATES THE VALUE OF DC CURRENT WHICH THE INDUCTANCE IS 10% LOWER THAN ITS INITIAL VALUE AND/OR $\Delta T=40^{\circ}\text{C}$ UNDER THIS DC CURRENT BIAS.