

SMD POWER INDUCTORS

MODEL NO. : SPC-1005P SERIES (CD105 COMPATIBLE)

FEATURES:

- * SUPERIOR QUALITY FOR AN AUTOMATED PRODUCTION LINE.
- * PICK AND PLACE COMPATIBLE.
- * TAPE AND REEL PACKING.

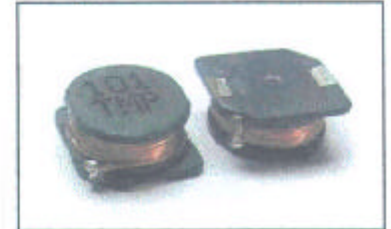

APPLICATION :

- * NOTEBOOK COMPUTERS.
- * DC-DC CONVERTORS.
- * DC-AC INVERTERS.

ELECTRICAL SPECIFICATION: PHYSICAL DIMENSION : (UNIT:mm)

PART NO.	INDUCTANCE (uH)	D.C.R. MAX (Ω)	RATED CURRENT (A)
SPC-1005P-100	10	0.06	2.60
SPC-1005P-120	12	0.07	2.45
SPC-1005P-150	15	0.08	2.27
SPC-1005P-180	18	0.09	2.15
SPC-1005P-220	22	0.10	1.95
SPC-1005P-270	27	0.11	1.76
SPC-1005P-330	33	0.12	1.50
SPC-1005P-390	39	0.14	1.37
SPC-1005P-470	47	0.17	1.28
SPC-1005P-560	56	0.19	1.17
SPC-1005P-680	68	0.22	1.11
SPC-1005P-820	82	0.25	1.00
SPC-1005P-101	100	0.35	0.97
SPC-1005P-121	120	0.40	0.89
SPC-1005P-151	150	0.47	0.78
SPC-1005P-181	180	0.63	0.72
SPC-1005P-221	220	0.73	0.66
SPC-1005P-271	270	0.97	0.57
SPC-1005P-331	330	1.15	0.52
SPC-1005P-391	390	1.30	0.48
SPC-1005P-471	470	1.48	0.42
SPC-1005P-561	560	1.90	0.33
SPC-1005P-681	680	2.25	0.28
SPC-1005P-821	820	2.55	0.24

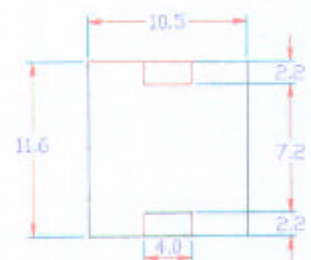
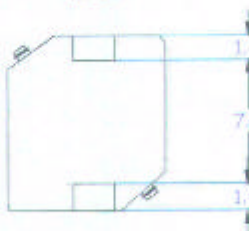
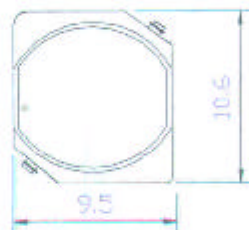

TOLERANCE : ± 0.3

PCB PATTERN

NOTE(1) :TEST FREQUENCY: 100 kHz,1 VRMS.

NOTE(2) :10~39uH $\pm 20\%$,47~820uH $\pm 10\%$.

NOTE (3): THIS INDICATES THE VALUE OF DC CURRENT WHICH THE INDUCTANCE IS 10% LOWER THAN ITS INITIAL VALUE
AND/OR $\Delta T=40^{\circ}\text{C}$ UNDER THIS DC CURRENT BIAS.