

# Military Silicon Power Rectifier

## 1N1202A–1N1206A, 1N3671A–1N3673A

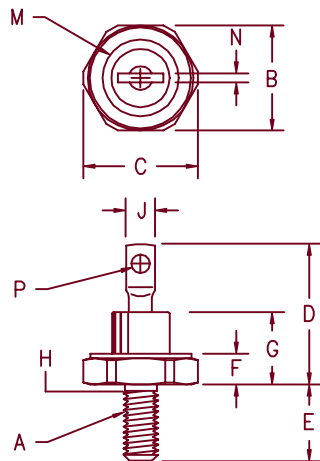

### Notes:

1. 10–32 UNF3A
2. Full threads within 2 1/2 threads
3. Standard Polarity: Stud is Cathode  
Reverse Polarity: Stud is Anode

Dim.	Inches		Millimeter		Notes
	Minimum	Maximum	Minimum	Maximum	
A	---	---	---	---	1
B	.424	.437	10.77	11.10	
C	---	.505	---	12.83	
D	---	.800	---	20.32	
E	.422	.453	10.72	11.51	
F	.075	.175	1.91	4.44	
G	---	.405	---	10.29	
H	.163	.189	4.15	4.80	2
J	.100	.140	2.54	3.56	
M	---	.350	---	8.89	Dia
N	.020	.065	.510	1.65	
P	.070	.100	1.78	2.54	Dia

## D0203AA (D04)

- Available in JAN, JANTX and JANTXV
- MIL-PRF-19500/260
- Glass passivated die
- Glass to metal seal construction
- 240 Amps surge rating
- $V_{RRM}$  to 1000 volts

### Microsemi Catalog Number

### Peak Reverse Voltage

Standard	Reverse
1N1202A	1N1202RA
1N1204A	1N1204RA
1N1206A	1N1206RA
1N3671A	1N3671RA
1N3673A	1N3673RA

200V  
400V  
600V  
800V  
1000V

## Electrical Characteristics

Average forward current	$I_F(AV)$ 12 Amps	$T_C = 150^\circ C$ , half sine wave, $R_{\theta JC} = 2.0^\circ C/W$
Maximum surge current	$I_{FSM}$ 240 Amps	8.3ms, half sine, $T_C = 200^\circ C$
Max $I^2 t$ for fusing	$I^2 t$ 240 A <sup>2</sup> s	
Max peak forward voltage	$V_{FM}$ 1.35 Volts	$I_{FM} = 38A; T_J = 25^\circ C^*$
Max peak reverse current	$V_{FM}$ 2.30 Volts	$I_{FM} = 240A; T_J = 25^\circ C$
Max peak reverse current	$I_{RM}$ 5 $\mu A$	$V_{RRM}, T_J = 25^\circ C$
Max peak reverse current	$I_{RM}$ 1.0 mA	$V_{RRM}, T_J = 150^\circ C$
Max Recommended Operating Frequency	10kHz	

\*Pulse test: Pulse width 300  $\mu$ sec. Duty cycle 2%

## Thermal and Mechanical Characteristics

Storage temperature range	$T_{STG}$	$-65^\circ C$ to $200^\circ C$
Operating case temp range	$T_C$	$-65^\circ C$ to $150^\circ C$
Maximum thermal resistance	$R_{\theta JC}$	$2.0^\circ C/W$ Junction to Case
Mounting torque		15 inch pounds maximum
Weight		.16 ounces (5.0 grams) typical

11–27–00 Rev. 1

# MILITARY

## 1N1202A-1N1206A, 1N3671A-1N3673A

Figure 1  
Typical Forward Characteristics

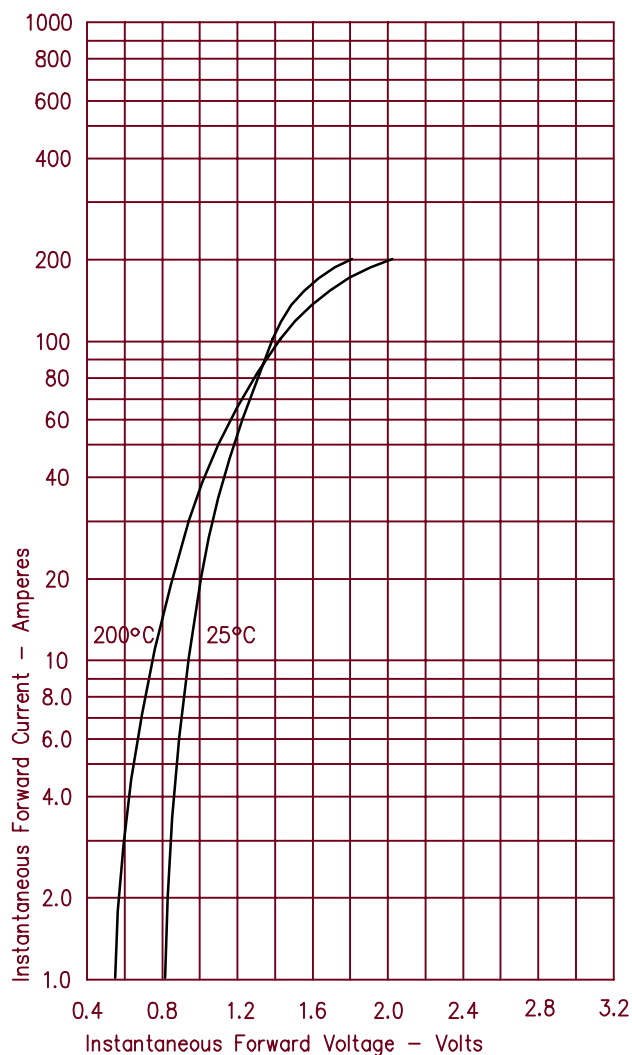

Figure 3  
Forward Current Derating

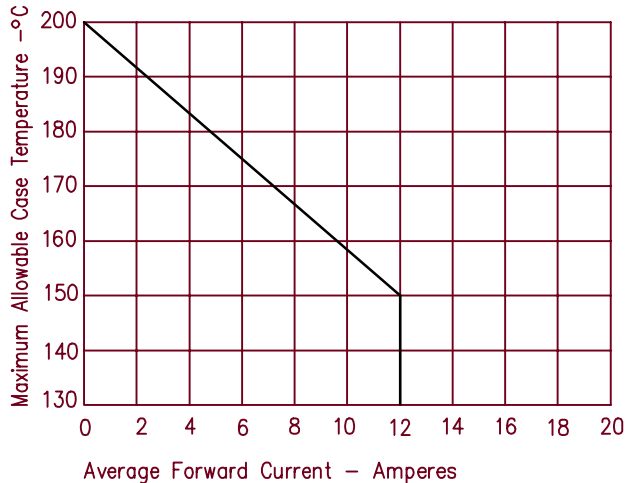

Figure 5  
Transient Thermal Impedance

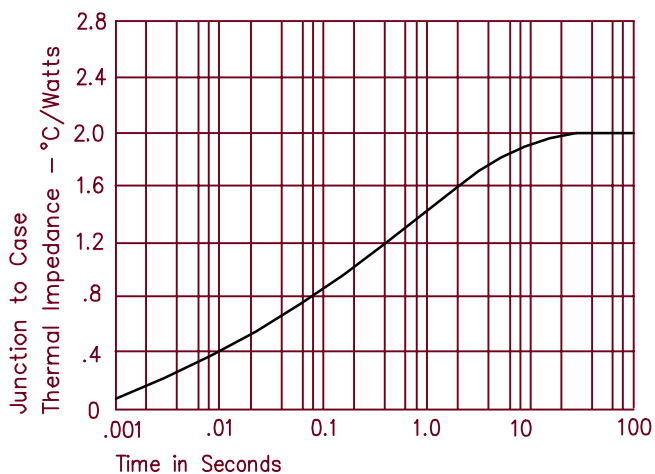

Figure 2  
Typical Reverse Characteristics

