

Coaxial

# Frequency Multiplier

Output 10 to 1000 MHz

## Maximum Ratings

Operating Temperature	-55°C to 100°C
Storage Temperature	-55°C to 100°C
RF Input Power	200mW

## Features

- wideband, 10 to 1000 MHz
- low conversion loss, 13.5 dB typ.
- rugged, shielded case

## Applications

- synthesizers
- local oscillators

MK-2



CASE STYLE: L19

Connectors	Model	Price	Qty.
SMA	MK-2	\$52.95	(1-9)
BRACKET (OPTION "B")		\$5.00	(1+)
BRACKET (OPTION "BR")		\$1.50	(1+)

## Outline Drawing

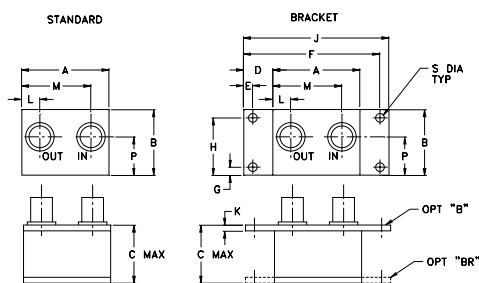

## Outline Dimensions (inch/mm)

A	B	C	D	E	F	G	H
1.50	1.13	1.00	.50	.155	2.345	.138	.987
38.10	28.70	25.40	12.70	3.94	59.56	3.51	25.07

J	K	L	M	N	P	S	wt
2.50	.10	.31	1.19	--	.66	.150	grams
33.50	2.54	7.87	30.23	--	16.76	3.81	37.0

## Frequency Multiplier Electrical Specifications

MODEL NO.	MULTIPLICATION FACTOR	FREQUENCY (MHz)		INPUT POWER (dBm)		CONVERSION LOSS (dB)		*HARMONIC OUTPUT (dBc)					
		Input	Output	Min.	Max.	Typ.	Max.	F1 Typ.	F1 Min.	F3 Typ.	F3 Min.	F4 Typ.	F4 Min.
MK-2	2	5-100	10-200	1	15	13.0	16.0	40	30	50	40	16	12
		100-300	200-600	1	15	13.5	15.5	25	20	40	30	16	12
		300-500	600-1000	1	15	14.0	16.5	20	15	30	25	16	12

\*Harmonic output below power level of F2

## Typical Performance Data

Output Frequency (MHz)	Conversion Loss (dB)	Harmonic Output (-dBc)		
		F1	F3	F4
2.00	15.26	48.20	57.00	13.70
10.00	13.06	48.70	57.80	13.80
20.00	12.72	49.80	59.00	16.00
50.00	13.52	43.60	58.00	16.20
100.00	12.74	39.00	52.20	16.90
200.00	13.04	33.60	43.60	17.00
400.00	13.06	27.20	36.40	20.60
600.00	13.28	23.70	31.60	24.20
800.00	14.00	18.90	32.20	25.90
1000.00	15.04	16.00	33.70	26.20

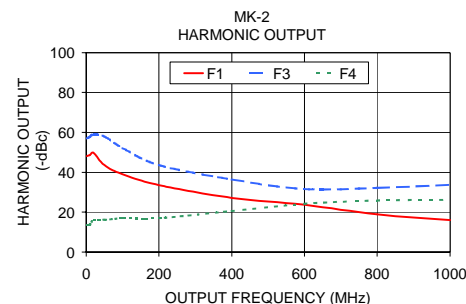
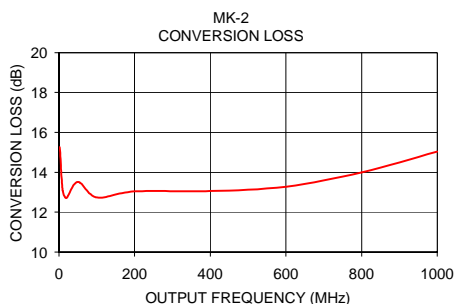

Distribution Centers NORTH AMERICA 800-654-7949 • 417-335-5935 • Fax 417-335-5945 • EUROPE 44-1252-832600 • Fax 44-1252-837010

Mini-Circuits ISO 9001 &amp; ISO 14001 Certified

INTERNET <http://www.minicircuits.com>
 REV. OR  
M96953  
FK-3000  
AD/CP  
050906