

## The RF Line Wideband Linear Amplifier

... designed for amplifier applications in 50 to 100 ohm systems requiring wide bandwidth, low noise and low distortion. This hybrid provides excellent gain stability with temperature and linear amplification as a result of the push-pull circuit design.

- Specified Characteristics at  $V_{CC} = 24\text{ V}$ ,  $T_C = 25^\circ\text{C}$ :  
 Frequency Range — 10–400 MHz  
 Output Power — 1580 mW Typ @ 1 dB Compression,  $f = 200\text{ MHz}$ ,  
 $V_{CC} = 28\text{ V}$   
 Power Gain — 22 dB Typ @  $f = 100\text{ MHz}$   
 PEP — 650 mW Min @ –32 dB IMD  
 Noise Figure — 4 dB Typ @  $f = 100\text{ MHz}$   
 ITO — 46 dBm @  $f = 300\text{ MHz}$
- All Gold Metallization for Improved Reliability
- Unconditional Stability Under All Load Conditions

### MAXIMUM RATINGS

Rating	Symbol	Value	Unit
DC Supply Voltage	$V_{CC}$	28	Vdc
RF Power Input	$P_{in}$	+14	dBm
Operating Case Temperature Range	$T_C$	–20 to +100	$^\circ\text{C}$
Storage Temperature Range	$T_{stg}$	–40 to +100	$^\circ\text{C}$

### ELECTRICAL CHARACTERISTICS ( $T_C = 25^\circ\text{C}$ , $V_{CC} = 24\text{ V}$ , 50 $\Omega$ system unless otherwise noted)

Characteristic	Symbol	Min	Typ	Max	Unit
Frequency Range	BW	10	—	400	MHz
Gain Flatness ( $f = 10\text{--}400\text{ MHz}$ )	—	—	$\pm 0.5$	$\pm 1$	dB
Power Gain ( $f = 100\text{ MHz}$ )	$P_G$	21	22	23	dB
Noise Figure, Broadband ( $f = 100\text{ MHz}$ )	NF	—	4	5	dB
Power Output — 1 dB Compression ( $f = 10\text{--}200\text{ MHz}$ , $V_{CC} = 28\text{ V}$ )	$P_{o1\text{ dB}}$	1260	1580	—	mW
Power Output — 1 dB Compression ( $f = 200\text{--}400\text{ MHz}$ , $V_{CC} = 28\text{ V}$ )	$P_{o1\text{ dB}}$	630	—	—	mW
Third Order Intercept (See Figure 10, $f_1 = 10\text{--}400\text{ MHz}$ , See Fig. 10)	ITO	42	44	—	dBm
Input/Output VSWR ( $f = 10\text{--}400\text{ MHz}$ )	VSWR	—	1.3:1	1.5:1	—
Second Harmonic Distortion ( $P_o = 100\text{ mW}$ , $f_{2H} = 300\text{ MHz}$ )	$d_{so}$	—	—	–50	dB
Peak Envelope Power (Two Tone Distortion Test — See Figure 10) ( $f = 200\text{ MHz}$ @ –32 dB IMD)	PEP	650	1000	—	mW
Supply Current	$I_{CC}$	200	230	250	mA

**CA2842C**

22 dB  
10–400 MHz  
1.2 WATTS  
WIDEBAND  
LINEAR AMPLIFIER

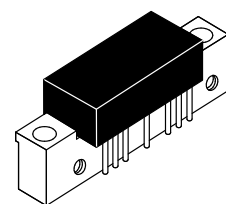

CASE 714F–03, STYLE 1  
[CA (POS. SUPPLY)]

## TYPICAL CHARACTERISTICS

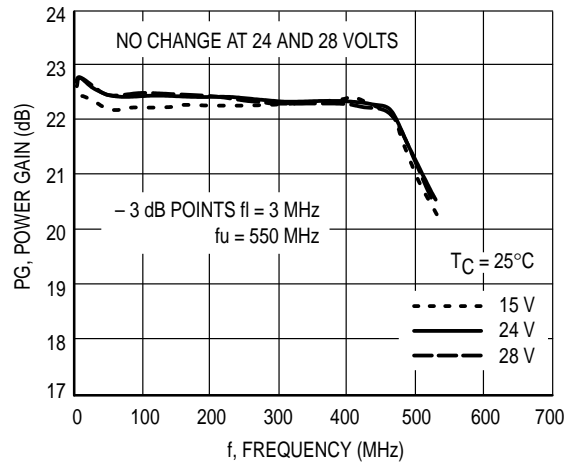

Figure 1. Power Gain versus Voltage

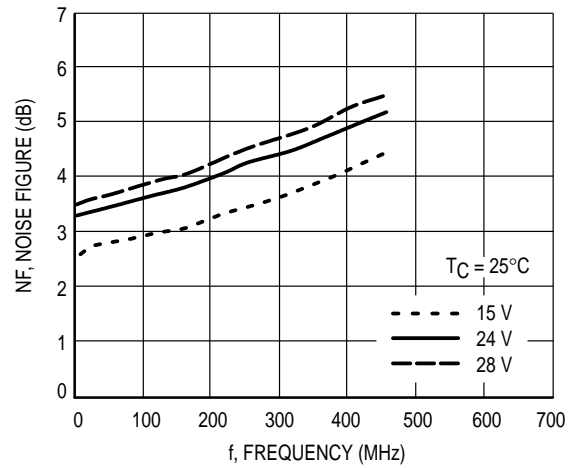

Figure 4. Noise Figure versus Voltage

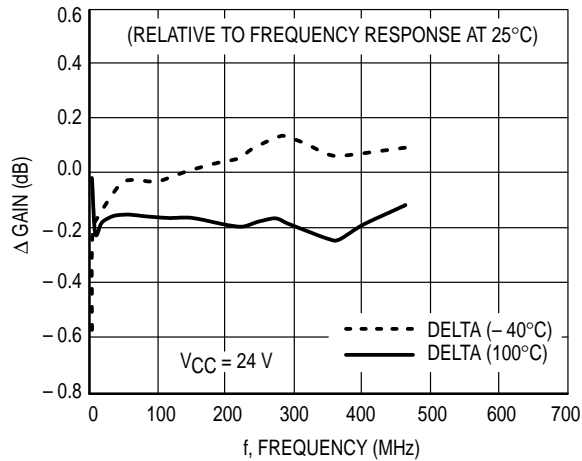

Figure 2. Relative Power Gain versus Temperature

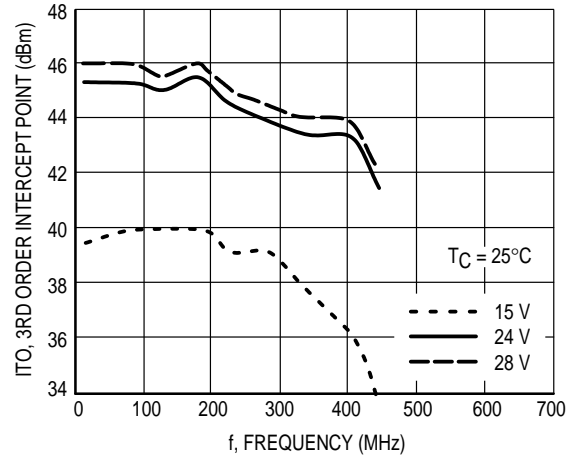

Figure 5. Third Order Intercept versus Voltage

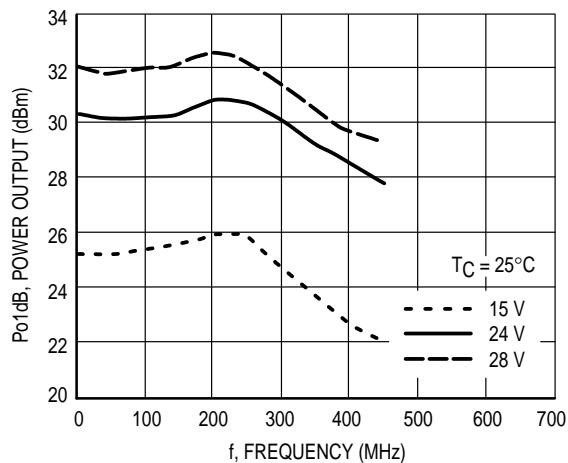

Figure 3. 1 dB Compression versus Voltage

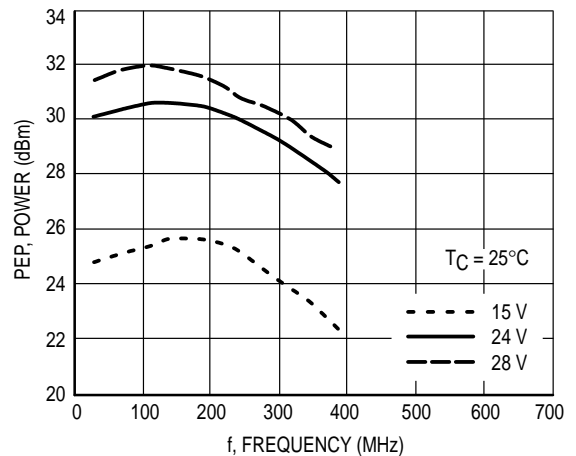

Figure 6. Peak Envelope Power versus Voltage

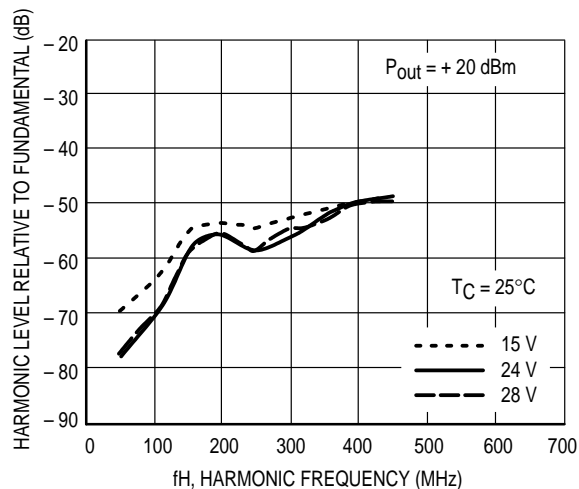

Figure 7. Second Harmonic Distortion versus Voltage

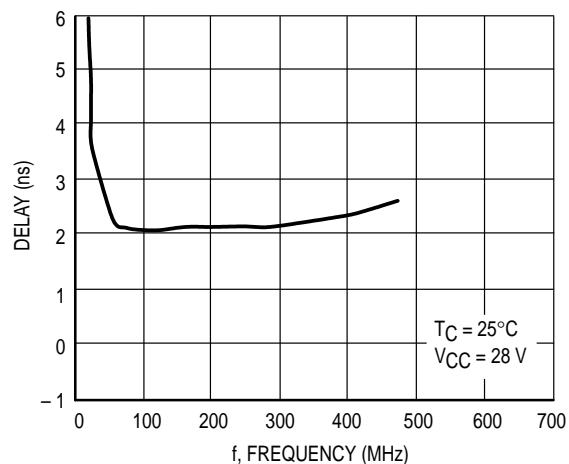

Figure 8. Group Delay versus Frequency

Biased at 24 Volts

$T_C = 25^\circ\text{C}$   $Z_o = 50\Omega$

Frequency (MHz)	S11		S21		S12		S22	
	Mag	Ang	Mag	Ang	Mag	Ang	Mag	Ang
10	-15.8	62	22.8	-168	-27	15	-20.2	29
50	-26.5	20	22.5	146	-27	-25	-24	15
100	-25.5	25	22.5	111	-27.5	-56	-22.5	-16
200	-20.5	-7	22.5	26	-27.9	-117	-18.1	-73
300	-17.2	-48	22.5	-51	-28.5	-170	-16.5	-125
400	-18.8	-129	22.4	-126	-28.3	114	-22.5	156

Magnitude in dB, Phase Angle in degrees.

Table 1. S-Parameters

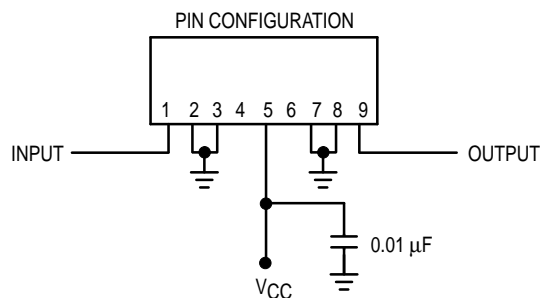
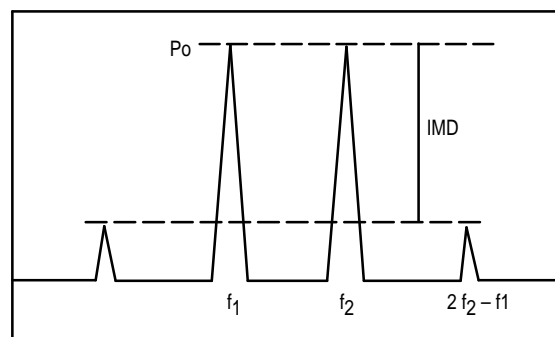

Figure 9. External Connections



$ITO = P_o + IMD / 2$  @  $IMD > 60$  dB  
 $PEP = 4 \times P_o$  @  $IMD = -32$  dB

Figure 10. Intermodulation Test

## PACKAGE DIMENSIONS

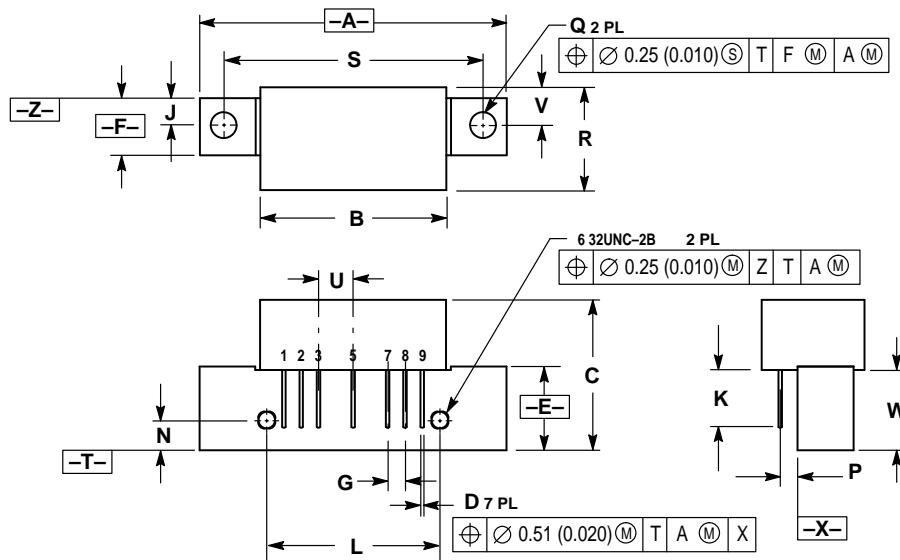

- NOTES:
1. DIMENSIONING AND TOLERANCING PER ANSI Y14.5M, 1982.
  2. CONTROLLING DIMENSION: INCH.

DIM	INCHES		MILLIMETERS	
	MIN	MAX	MIN	MAX
A	—	1.775	—	45.08
B	—	1.085	—	27.56
C	—	0.870	—	22.10
D	0.018	0.022	0.46	0.56
E	0.465	0.510	11.81	12.95
F	0.300	0.325	7.62	8.25
G	0.100 BSC	—	2.54 BSC	—
J	0.156 BSC	—	3.96 BSC	—
K	0.330	0.370	8.38	9.40
L	1.000 BSC	—	25.40 BSC	—
N	0.165 BSC	—	4.19 BSC	—
P	0.100 BSC	—	2.54 BSC	—
Q	0.148	0.168	3.76	4.27
R	—	0.595	—	15.11
S	1.500 BSC	—	38.10 BSC	—
U	0.200 BSC	—	5.08 BSC	—
V	0.209	0.239	5.31	6.07
W	0.425	—	10.80	—

- STYLE 1:
- PIN 1. RF INPUT
  - GROUND
  - GROUND
  - +V<sub>CC</sub>
  - GROUND
  - GROUND
  - RF OUTPUT

### CASE 714F-03 ISSUE C

Motorola reserves the right to make changes without further notice to any products herein. Motorola makes no warranty, representation or guarantee regarding the suitability of its products for any particular purpose, nor does Motorola assume any liability arising out of the application or use of any product or circuit, and specifically disclaims any and all liability, including without limitation consequential or incidental damages. "Typical" parameters can and do vary in different applications. All operating parameters, including "Typicals" must be validated for each customer application by customer's technical experts. Motorola does not convey any license under its patent rights nor the rights of others. Motorola products are not designed, intended, or authorized for use as components in systems intended for surgical implant into the body, or other applications intended to support or sustain life, or for any other application in which the failure of the Motorola product could create a situation where personal injury or death may occur. Should Buyer purchase or use Motorola products for any such unintended or unauthorized application, Buyer shall indemnify and hold Motorola and its officers, employees, subsidiaries, affiliates, and distributors harmless against all claims, costs, damages, and expenses, and reasonable attorney fees arising out of, directly or indirectly, any claim of personal injury or death associated with such unintended or unauthorized use, even if such claim alleges that Motorola was negligent regarding the design or manufacture of the part. Motorola and  are registered trademarks of Motorola, Inc. Motorola, Inc. is an Equal Opportunity/Affirmative Action Employer.

#### Literature Distribution Centers:

USA: Motorola Literature Distribution; P.O. Box 20912; Phoenix, Arizona 85036.

EUROPE: Motorola Ltd.; European Literature Centre; 88 Tanners Drive, Blakelands, Milton Keynes, MK14 5BP, England.

JAPAN: Nippon Motorola Ltd.; 4-32-1, Nishi-Gotanda, Shinagawa-ku, Tokyo 141, Japan.

ASIA PACIFIC: Motorola Semiconductors H.K. Ltd.; Silicon Harbour Center, No. 2 Dai King Street, Tai Po Industrial Estate, Tai Po, N.T., Hong Kong.



CA2842C/D

