

SBD Type : EA40QC04-F

OUTLINE DRAWING

FEATURES

- * TO-252AA Case, Surface Mount Device
- * Dual Diodes Cathode Common
- * Low Forward Voltage drop
- * Low Power Loss
- * High Surge Capability
- * 40 Volts thru 100 Volts Types Available
- * Packaged in 16mm Tape and Reel

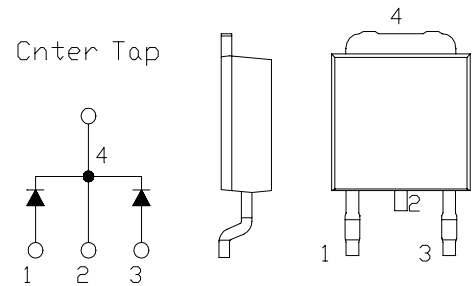

Maximum Ratings

Approx Net Weight:0.30g

Rating		Symbol	EA40QC04-F			Unit
Repetitive Peak Reverse Voltage		V _{RRM}	40			V
Non-repetitive Peak Reverse Voltage		V _{RSM}	45			V
Average Rectified Output Current	P.C.Board mounted *	I _O	1.8	Ta=30°C	50Hz Full Sine Wave Resistive Load	A
	-		4.0	Tc=129°C		
RMS Forward Current		I _{F(RMS)}	4.44			A
Surge Forward Current		I _{FSM}	40	50Hz Full Sine Wave,1cycle, Non-repetitive		A
Operating JunctionTemperature Range		T _{jw}	- 40 to + 150			°C
Storage Temperature Range		T _{stg}	- 40 to + 150			°C

Electrical • Thermal Characteristics

Characteristics		Symbol	Conditions	Min	Typ	Max	Unit
Peak Reverse Current		I_{RM}	$T_j=25^{\circ}\text{C}, V_{RM}=V_{RRM}$ per Arm	-	-	2.0	mA
Peak Forward Voltage		V_{FM}	$T_j=25^{\circ}\text{C}, I_{FM}= 2\text{A}$ per Arm	-	-	0.55	V
Thermal Resistance	Junction to Ambient	$R_{th(j-a)}$	P.C.Board mounted *	-	-	80	$^{\circ}\text{C/W}$
	Junction to Case	$R_{th(j-c)}$	-	-	-	5.5	$^{\circ}\text{C/W}$

* Print Land = 20x20 mm

EA40QC04-F OUTLINE DRAWING (Dimensions in mm)

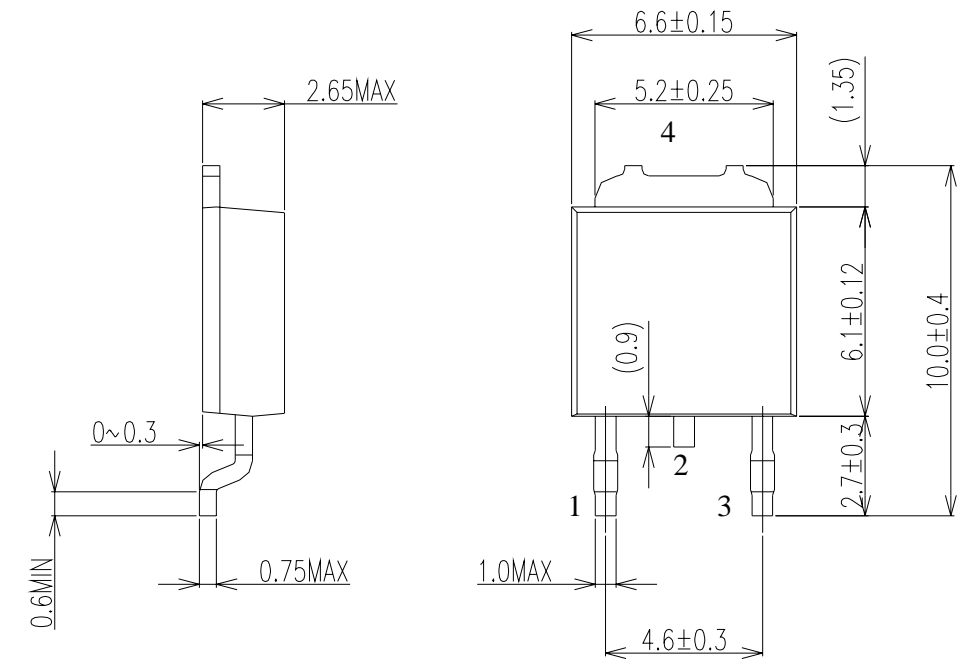

Soldering PAD

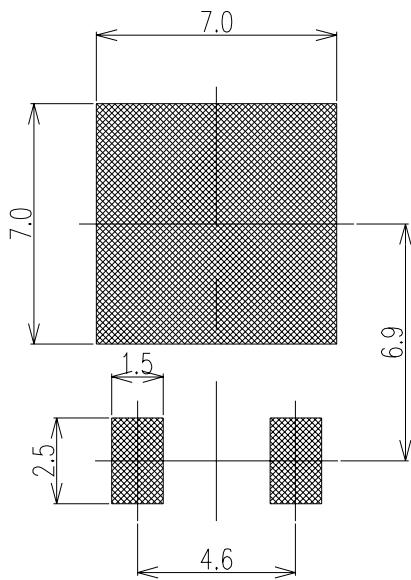

Center Tap

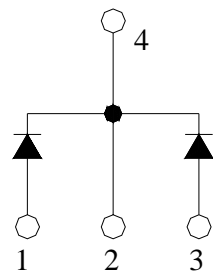

FORWARD CURRENT VS. VOLTAGE

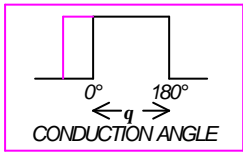
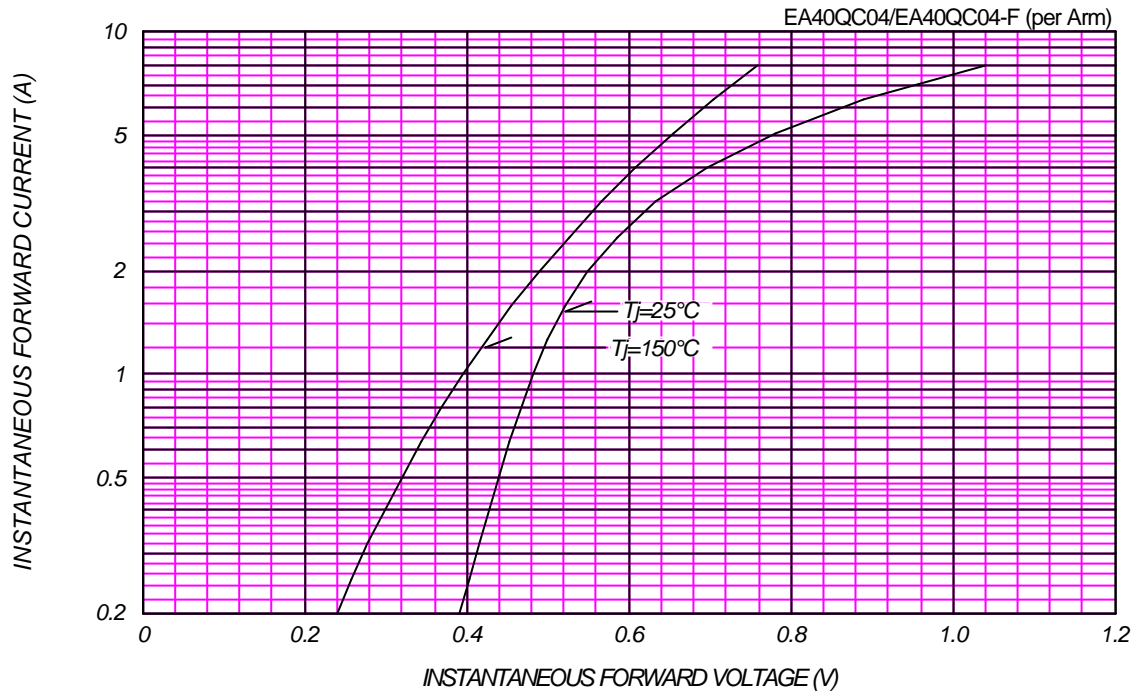

AVERAGE FORWARD POWER DISSIPATION

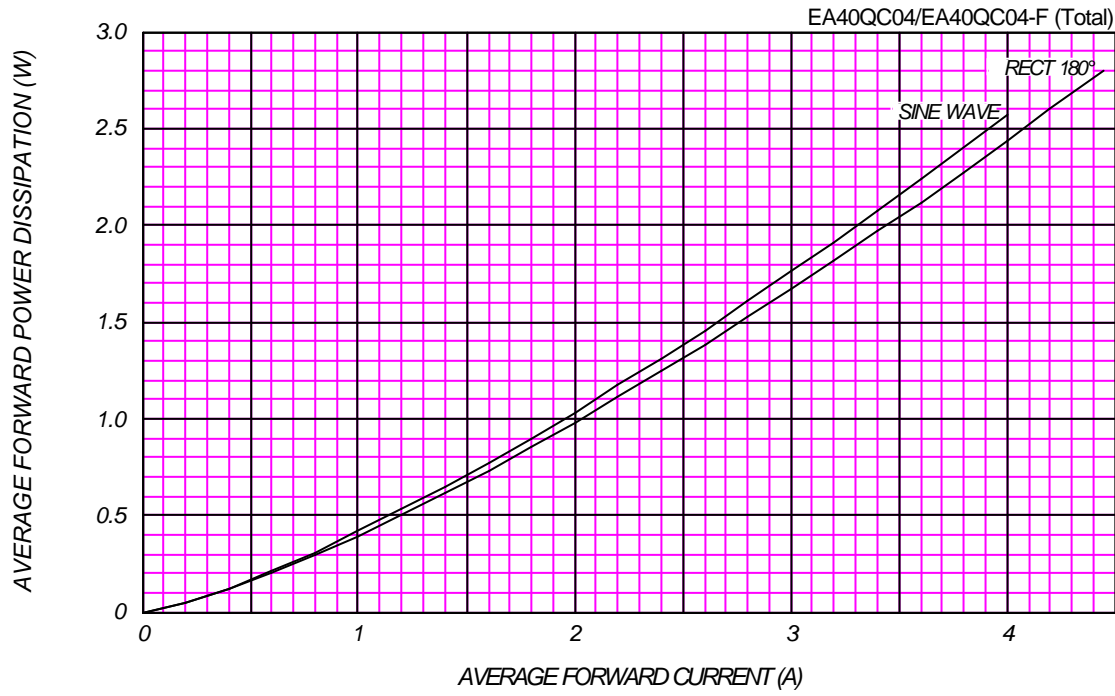

PEAK REVERSE CURRENT VS. PEAK REVERSE VOLTAGE

$T_j = 150^\circ\text{C}$

EA40QC04/EA40QC04-F (per Arm)

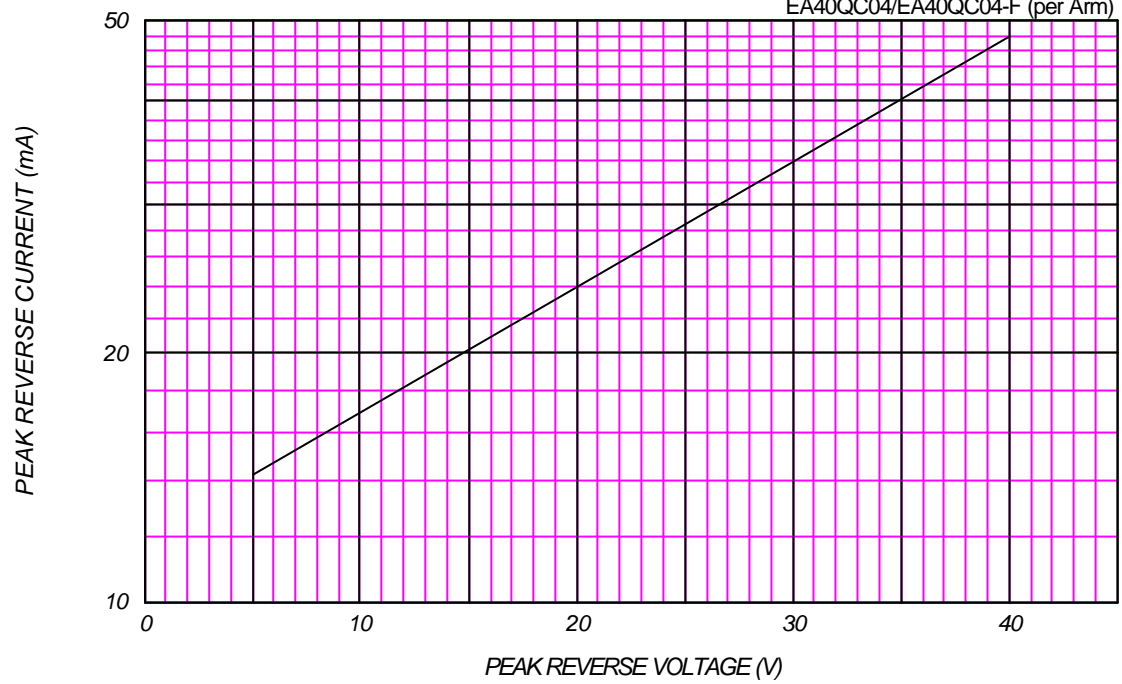

AVERAGE REVERSE POWER DISSIPATION

EA40QC04/EA40QC04-F (Total)

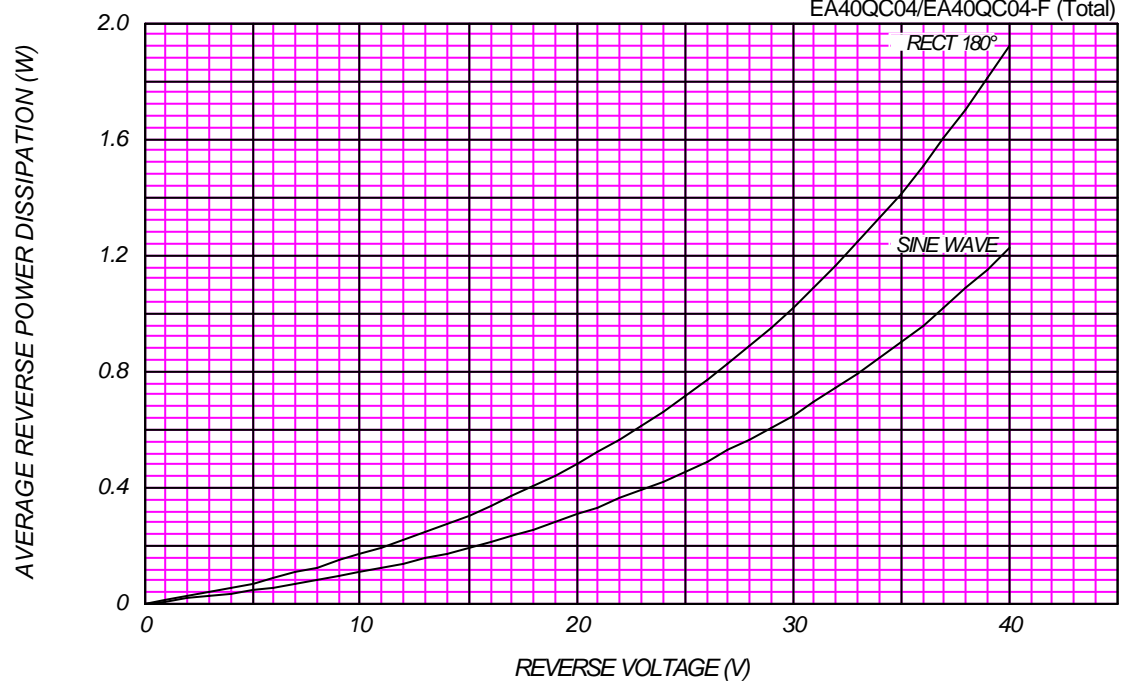

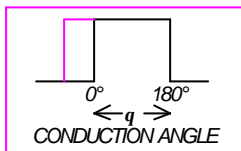

AVERAGE FORWARD CURRENT VS. CASE TEMPERATURE

$V_{RM}=40V$

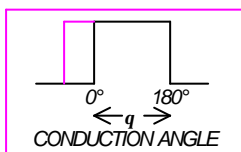
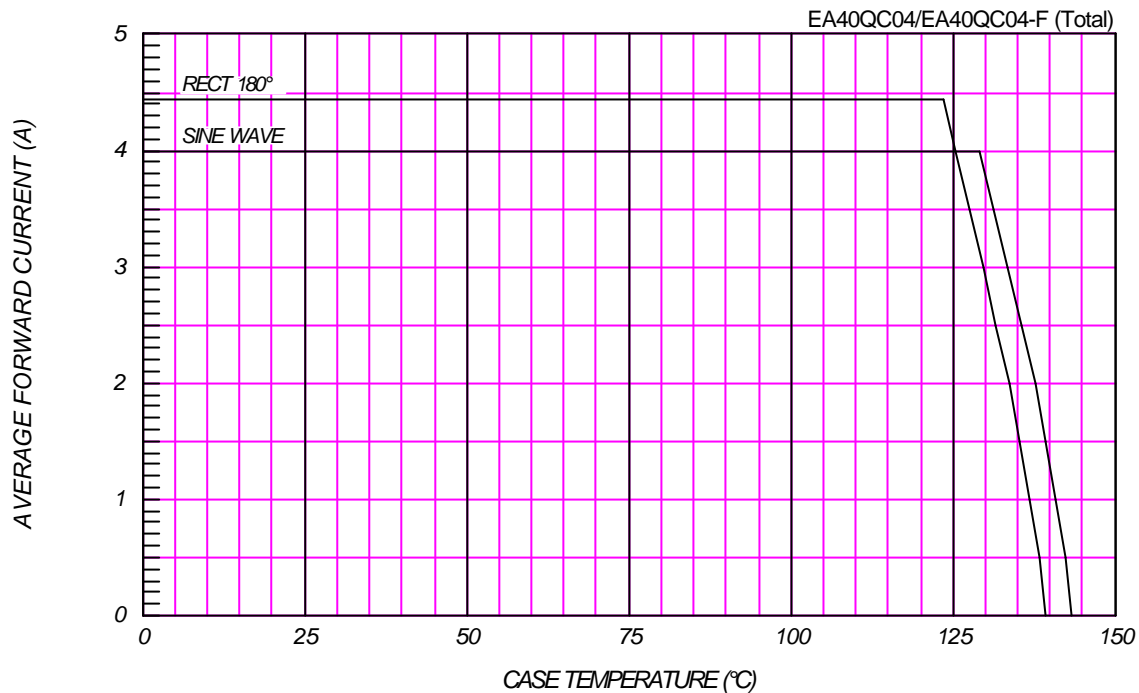

AVERAGE FORWARD CURRENT VS. AMBIENT TEMPERATURE

P.C. Board mounted (Print land=20x20mm)

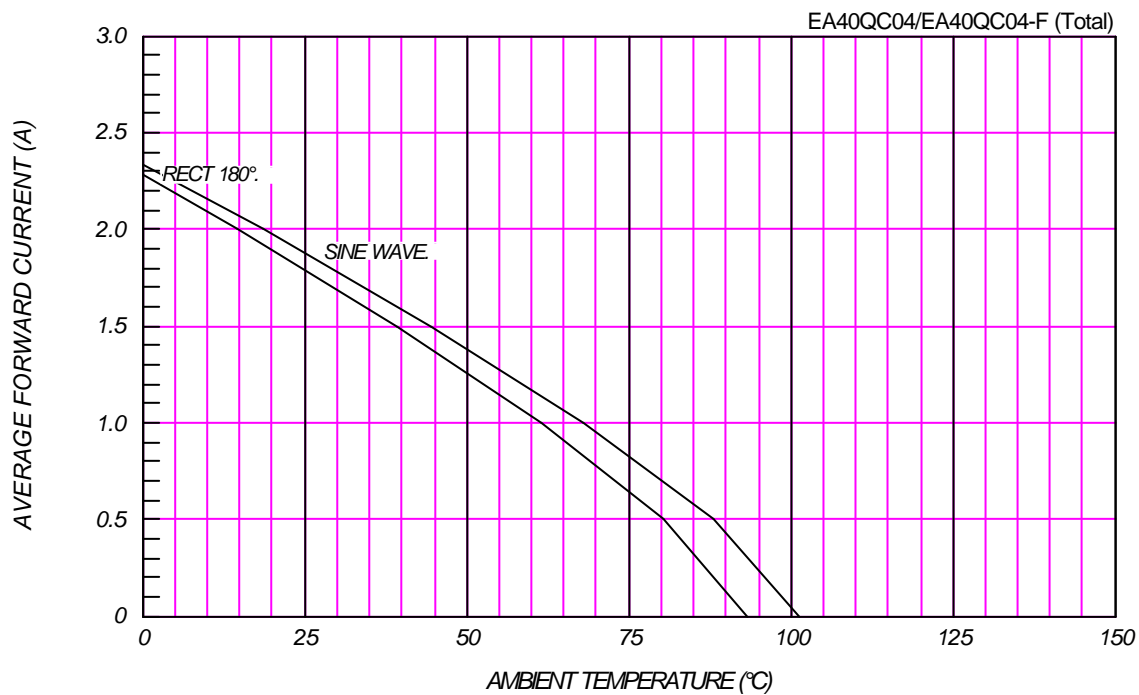

SURGE CURRENT RATINGS

f=50Hz,Sine Wave,Non-Repetitive,No Load

EA40QC04/EA40QC04-F

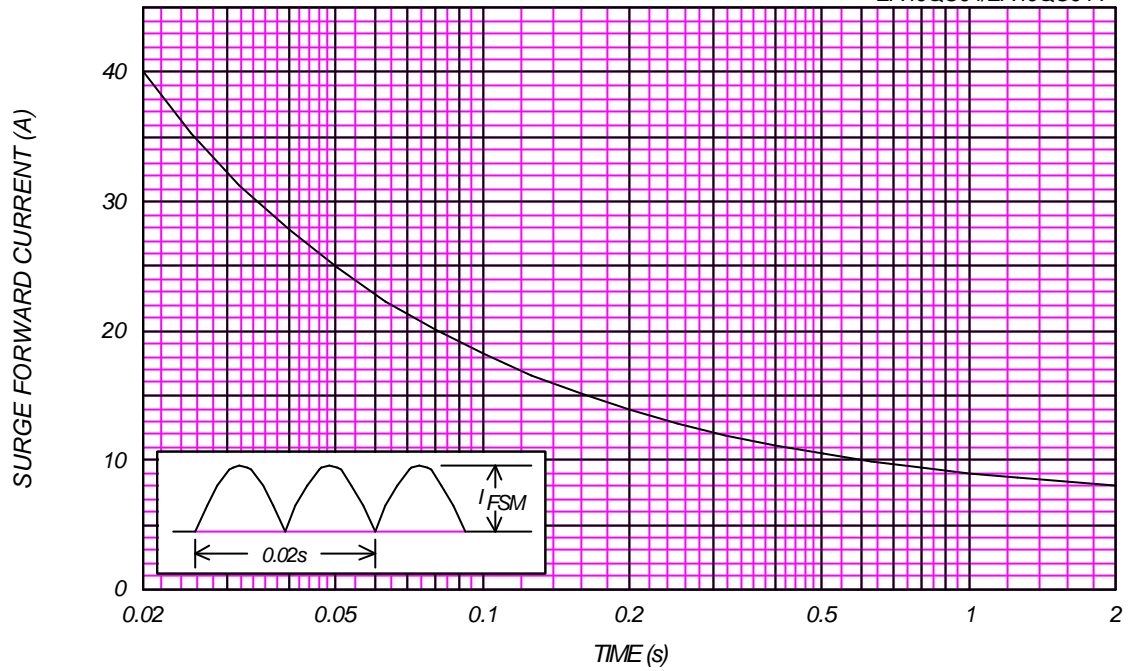

JUNCTION CAPACITANCE VS. REVERSE VOLTAGE

T_j=25° C,V_m=20mV_{RMS},f=100kHz,Typical Value

EA40QC04/EA40QC04-F (per Arm)

