

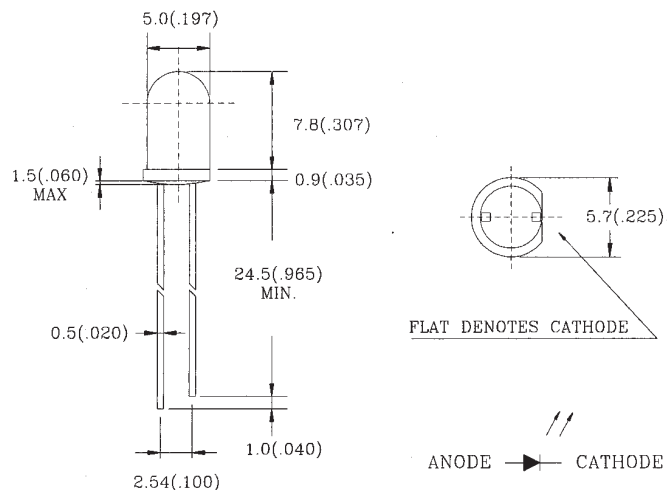

L-51XEIR2XX 5.0mm INFRARED EMITTING DIODE



1. ABSOLUTE MAXIMUM RATING: (Ta=25°C)

Part No.	P _D (mw)	V _{(BR)R} (V)	Topr	Tstg
L-51XEIR2XX	100	5	-35°C to 85°C	-35°C to 85°C
PARAMETER	Power Dissipation	Reverse Voltage	Operating Temperature Range	Storage Temperature Range
Lead Soldering Temperature {1.6mm(0.063 inch)From Body}250°C ±5°C For 3 Seconds				

1. ELECTRO-OPTICAL CHARACTERISTICS: (Ta=25°C)

Part No.	V _F (V)			I _R (μA)			λ _{fp} (nm)			2θ _{c1/2} (dgc)			I _e (mw/sr)		
	MIN	TYP	MAX	MIN	TYP	MAX	MIN	TYP	MAX	MIN	TYP	MAX	MIN	TYP	MAX
L-514EIR2BC		1.4 1.6	1.8			10		880			20		17	30	
L-516EIR2BC		1.4 1.6	1.8			10		880			30		12	23	
L-518EIR2BC		1.4 1.6	1.8			10		880			40		8	18	
L-516EIR2D2		1.4 1.6	1.8			10		880			30		10	20	
L-516EIR2D2-S		1.4 1.6	1.8			10		880			30		10	20	
TEST CONDITION	I _F =20mA I _F =100mA			V _R =5V			I _F =20mA			I _F =20mA			I _F =20mA		

D2=BLACK

1.All dimension are in millimeters(inches).

2.Tolerance is ±0.25mm(0.01")unless otherwise specified.