



PCB "Zero profile" receptacles

Accept pins \varnothing 0.40–0.56 mm



Single receptacle contacts for solder mount into PCB, supplied on disposable carriers.

For corresponding pin connectors see pages 43 to 46

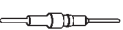
Platings	Sleeve 	Clip 	Pin 
91	5 μ m Sn Pb	0.25 μ m Au	
93	5 μ m Sn Pb	0.75 μ m Au	
99	5 μ m Sn Pb	5 μ m Sn Pb	

Ordering information

Replace **xx** with the number of poles, e.g. 714-91-2**xx**-41-001 for a double row version with 8 pins per row becomes:
714-91-2**16**-41-001

Option:

Double row, disposable carrier strip on request

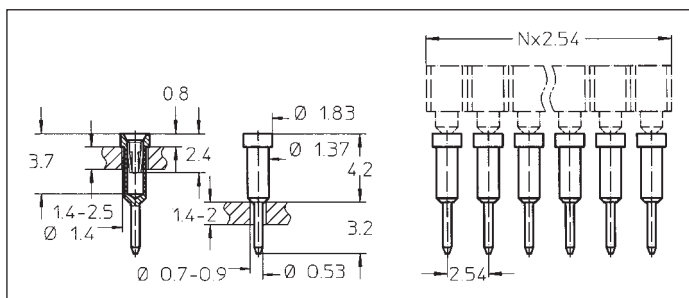

712-91-1xx-41-001

712-93-1xx-41-001

712-99-1xx-41-001

Straight receptacle contacts: solder mount, into PCB thickness 1.4 to 2 mm with hole \varnothing 0.7 to 0.9 mm

Availability: supplied on single row, disposable carrier strip, from 2 to 64 contacts
Standard number of contacts 5, 6, 8, 10, 14, 16, 20, 21, 25, 30, 32, 48, 56, 60, 64

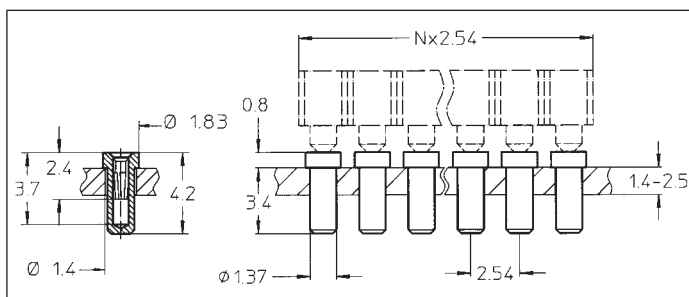

714-91-1xx-41-001

714-93-1xx-41-001

714-99-1xx-41-001

Straight receptacle contacts: solder mount into PCB thickness 1 to 2.6 mm with hole \varnothing 1.5 mm

Availability: supplied on single row, disposable carrier strip, from 2 to 64 contacts
Standard number of contacts 5, 6, 8, 10, 14, 16, 20, 21, 25, 30, 32, 48, 56, 60, 64

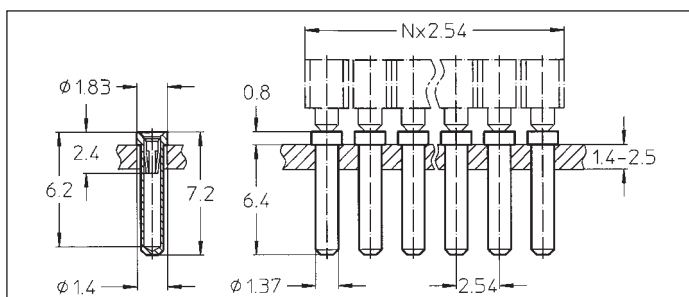

714-91-1xx-41-014 **B**

714-93-1xx-41-014 **B**

714-99-1xx-41-014 **B**

Straight receptacle contacts: solder mount into PCB thickness 1 to 4 mm with hole \varnothing 1.5 mm

Availability: supplied on single row, disposable carrier strip, from 2 to 64 contacts
Standard number of contacts 5, 6, 8, 10, 14, 16, 20, 21, 25, 30, 32, 48, 56, 60, 64