

Features

- For Telecom DSM, XDSL, Application
- Internal Pi Filter
- Multi-Outputs
- Overcurrent Protection
- High Efficiency to 80%

INNOLINE
DC/DC-Converter

High Voltage Input Series

Selection Guide

Part Number	Input Range (VDC)	Output Voltage (VDC)	Output Current (mA)	Efficiency (%)	Dimension
RP3.75D2/x1	28-60	5	750	78	D2
RP7.5D2/x1	40-140	5	1500	78	D2
RP7E1/x1	36-180	+5 ±15	1000 ±65	77	E1
RP8.7E1/x1	36-170	+5.1 ±12	1000 +100 -200	77	E1
RP14.7E1/x1	20-60	+5 ±12 -48	1500 +200 -50	76	E1
RP6.4E1/x1	95-190	±5 -35 70	+340 -35 -100 1W	77	E1
RP10E1/x1	90-270	±5 -28 -32 70	+560 -60 -155 -50 1W	76	E1

Note:

Case dimensions see High outputs series.

"For Package Style please see High Output Series. For detailed datasheets and pinning please check with our technical customer service."



Specifications (typical at nominal input and 25°C unless otherwise noted)

Input Voltage Range	See „Selection Guide“ Table
Input Filter	Pi Type
Voltage Accuracy	±2.0%, (main)
Line Regulation, Full Line	±0.2%, (main)
Load Regulation, FL-1/4FL	±0.25%, (main)
Temperature Coefficient	±0.02%/°C
Short Circuit Protection	Continuous
Isolation Voltage	1600VDC, min.
Isolation Resistance	10 ⁹ Ω
Operating Temperature Range	-25°C to +71°C
Storage Temperature Range	-40°C to +85°C
Cooling	Free-air Convection
Dimensions	See below „Package Style and Pinning“

Package Style and Pinning (mm)

"For detailed datasheets and pinning please ask at our technical customer service."

A2 Case: 31.8 x 20.3 x 10.2 mm

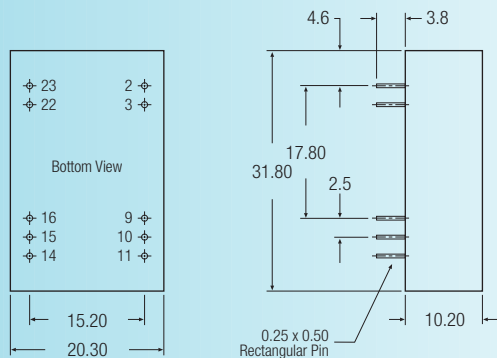

Pin Pitch Tolerance ± 0.35 mm

D2 Case: 50.8 x 25.4 x 9.5 mm

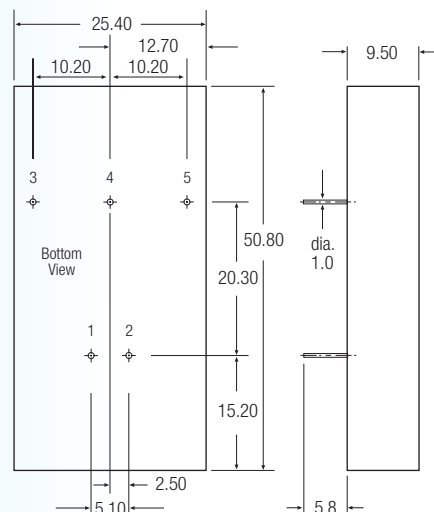

Pin Pitch Tolerance ± 0.5 mm

E1 Case: 50.8 x 50.8 x 18 mm

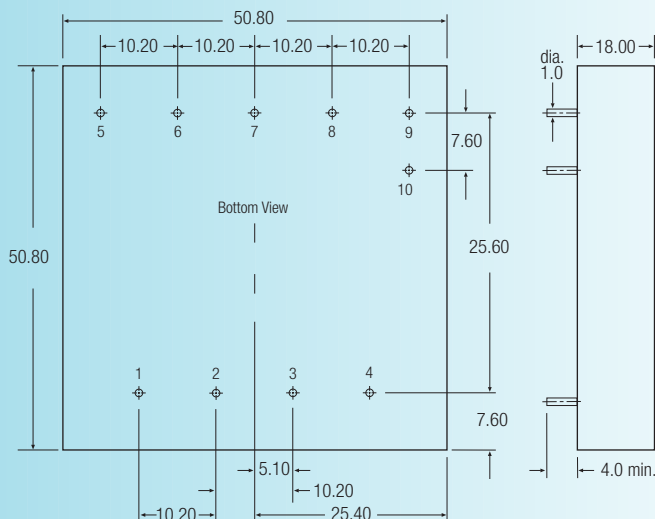

Pin Pitch Tolerance ± 0.4 mm

F2 Case: 50.1 x 40.6 x 10.2 mm

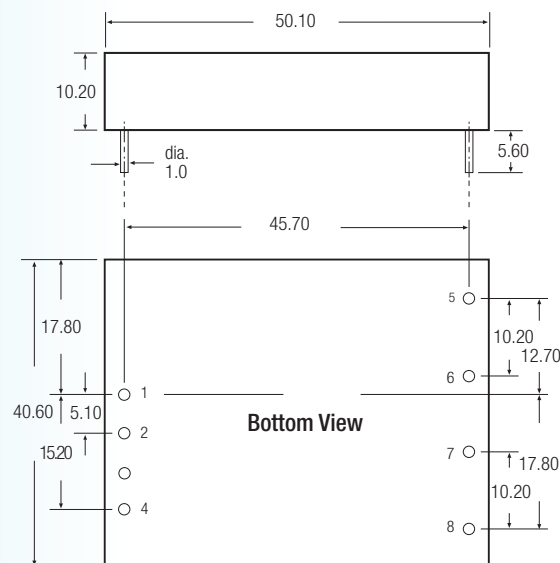

Pin Pitch Tolerance ± 0.5 mm