

**Viewing Angle: 15° (2θ1/2) ø5mm,  
Cylinder Type, Colorless  
Transparency Super-luminosity  
LED Lamps for Outdoor Use**

(Unit : mm)

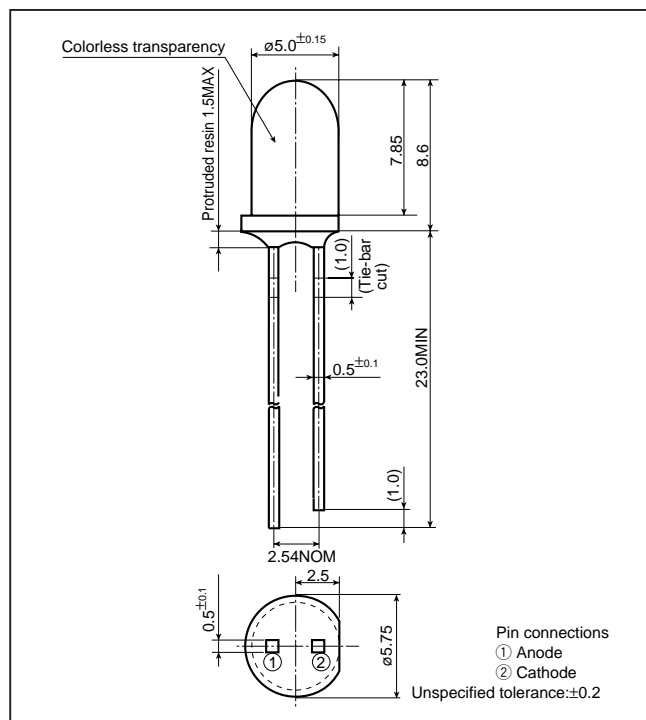
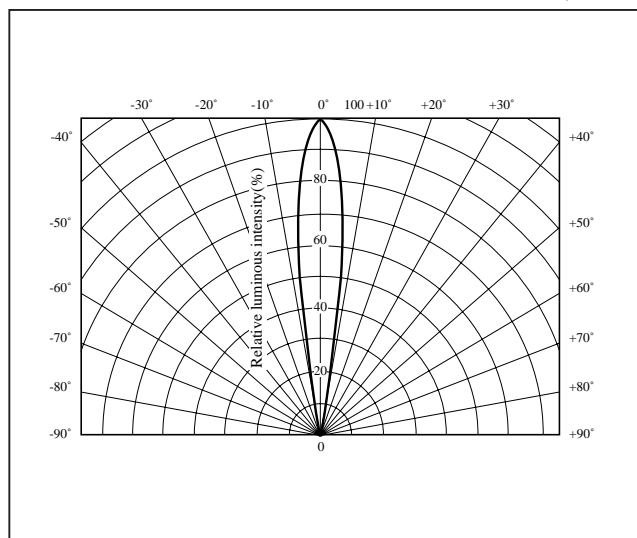

(T<sub>a</sub>=25°C)

 $(T_a=25^\circ\text{C})$ 

Model No.	Radiation color	Radiation material	Power dissipation P (mW)	Forward current I <sub>F</sub> (mA)	Peak forward current I <sub>FM</sub> <sup>1</sup> (mA)	Derating factor (mA/°C)		Reverse voltage V <sub>R</sub> (V)	Operating temperature T <sub>opr</sub> (°C)	Storage temperature T <sub>stg</sub> (°C)	Soldering temperature T <sub>sol</sub> <sup>2</sup> (°C)
						DC	Pulse				
GL5ZR44	Red	AlGaInP on GaAs	130	50	100	0.67	1.33	5	-40 to +85	-40 to +100	260
GL5ZJ44	Orange	AlGaInP on GaAs	130	50	100	0.67	1.33	5	-40 to +85	-40 to +100	260
GL5ZS44	Sunset orange	AlGaInP on GaAs	130	50	100	0.67	1.33	5	-40 to +85	-40 to +100	260
GL5ZV44	Amber	AlGaInP on GaAs	130	50	100	0.67	1.33	5	-40 to +85	-40 to +100	260
GL5ZE44	Yellow-green	AlGaInP on GaAs	130	50	100	0.67	1.33	5	-40 to +85	-40 to +100	260
GL5ZG44	Green	AlGaInP on GaAs	130	50	100	0.67	1.33	5	-40 to +85	-40 to +100	260

\*2 5s or less(At the position of 1.6mm or more from the bottom face of resin package)

(I<sub>F</sub>=20mA, T<sub>a</sub>=25°C)

Lens type	Model No.	Forward voltage V <sub>F</sub> (V)		Peak emission wavelength λ <sub>p</sub> (nm)	Dominant wavelength λ <sub>d</sub> (nm)	Luminous intensity I <sub>v</sub> (mcd)	Spectrum radiation bandwidth Δλ(nm)	Reverse current		Terminal capacitance		Page for characteristics diagrams
		TYP	MAX	TYP	TYP	TYP	TYP	I <sub>R</sub> (μA) MAX	V <sub>R</sub> (V)	C <sub>t</sub> (pF) TYP	(MHz)	
Colorless transparency	GL5ZR44	2.1	2.6	647	635	1 700	20	100	4	60	1	142
	GL5ZJ44	2.1	2.6	627	618	3 400	15	100	4	60	1	142
	GL5ZS44	2.1	2.6	609	605	4 200	15	100	4	60	1	143
	GL5ZV44	2.1	2.6	591	588	3 100	15	100	4	60	1	144
	GL5ZE44	2.1	2.6	570	570	700	15	100	4	60	1	144
	GL5ZG44	2.1	2.6	560	560	200	15	100	4	60	1	145

# General Description of Light Emitting Diodes

## A: Lead Pin Type

### ■ Lead Forming Method

Avoid forming a lead pin with the lead pin base as a fulcrum: be sure to hold a lead pin firmly when forming.

Lead pins should be formed before soldering.

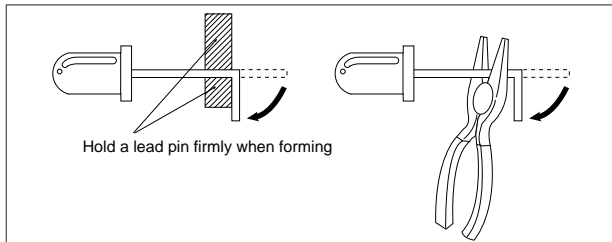

### ■ Installation

#### (1) Installation on a PWB

When mounting an LED lamp on a PWB, do not apply physical stress to the lead pins.

(Notes) • The lead pin pitch should match the PWB pin-hole pitch: absolutely avoid widening or narrowing the lead pins.

• When positioning an LED lamp, basically employ an LED with tie-bar cut or use a spacer.

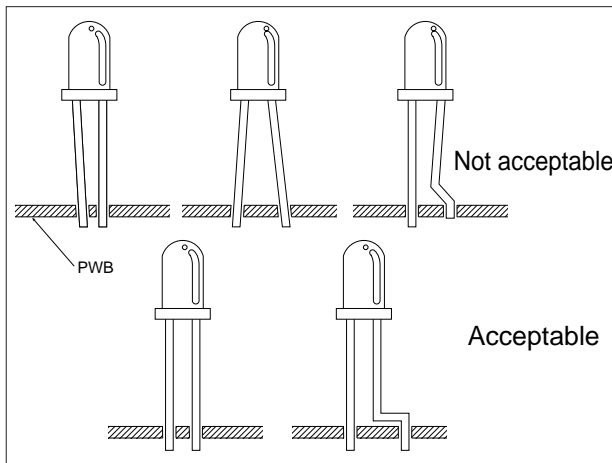

#### (2) When an LED lamp is mounted directly on a PWB

If the bottom face of an LED lamp is mounted directly on single-sided PWB, the base of the lead pins may be subjected to have physical stress due to PWB warp, cutting or clinching of lead pins. Prior to use, be sure to check that no disconnection inside of the resin or damage to resin etc., is found.

When an LED lamp is mounted on a double-sided PWB, the heat during soldering affects the resin; therefore, keep the LED lamp more than 1.6mm afloat above the PWB.

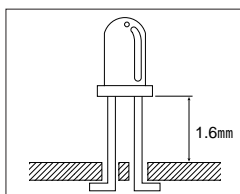

#### (3) Installation using a holder

During an LED lamp positioning, in case of using a holder, holder A should be designed to be smaller than the inside diameter of lead pins. Holder B should be designed to be larger than the outside diameter of lead pins.

(Notes) • Pay attention to the thermal expansion coefficient of the material used for the holder. Since the holder expands and contracts due to preheat and soldering heat, mechanical stress may be applied to the lead pins, resulting in disconnection.

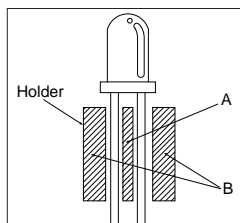

#### (4) Installation to the case

Do not fix part A with adhesives when fixed to the case as shown in the figure.

A hole of the case should be designed not to be smaller than the outside diameter of LED lamp resin.

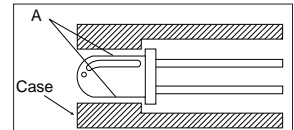

### ■ Soldering Conditions

Solder the lead pins under the following conditions.

Type of Soldering	Conditions
1. Manual soldering	295°C ± 5°C, within 3 seconds
2. Wave soldering	260°C ± 5°C, within 5 seconds
3. Reflow soldering	Preheating 70°C to 80°C, within 30 seconds Soldering 245°C ± 5°C, within 5 seconds

(Notes) • Avoid dipping resin into soldering bath.

• Avoid applying stress to lead pins while they are heated. For example, when the LED lamp is moved with the heat applied to the lead pins during manual soldering or solder repair, disconnection may occur.

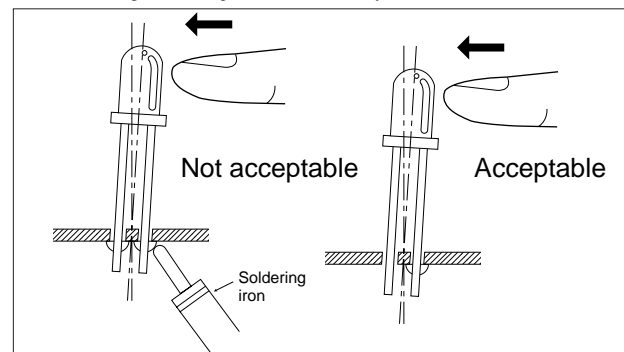

### ■ Cleaning

#### (1) Solvents

The package resin may be penetrated by solvents used in cleaning. Refer to the table below for usable solvents.

Solvent	Usable
Ethyl alcohol	○
Isopropyl alcohol	○
Chlorosen	×
Acetone	×
Trichloroethylene	×

○ : Acceptable

× : Not acceptable

(Notes) • There is a world-wide movement to restrict the use of chlorofluorocarbon (CFC) based solvents and we recommend that you avoid their use. However, before using a CFC substitute solvent, carefully check that it will not penetrate the package resin.

#### (2) Cleaning Methods

Cleaning Method	Usable	Remarks
Solvent cleaning	○	Immersion up to one minute at room temperature
Ultrasonic cleaning	△	Test the cleaning under actual conditions and check for abnormalities before actual use.

○ : Acceptable

△ : Acceptability depends on device type and conditions

(Notes) • The affect on the device from ultrasonic cleaning differs depending on the size of the cleaning bath, ultrasonic output, duration, board size and device mounting method. Test the cleaning method under actual conditions and check for abnormalities before actual use.

• Cleaning with water is not allowed with the lead pins resin-tubulated: water may remain, thus causing rust to the lead pins.

• Please contact our representative before using a cleaning solvent or method not given above.

# Tape-packaged Products

## General Description

Sharp can supply tape-packaged LED lamps for automatic mounting. They will contribute to the high-efficiency mounting, high-precision, power saving. Please confirm before use because some products are not available in taping package.

## Taping specification(Unit : mm)

### Forming type

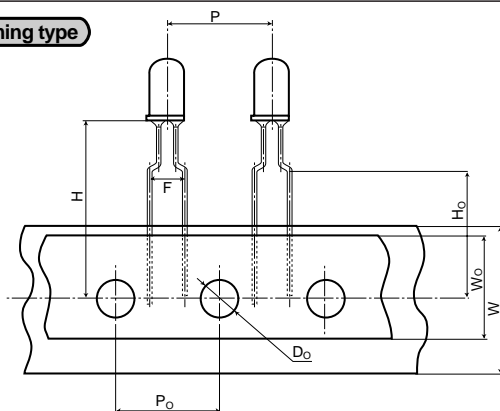

Parameter	Symbol	A	B	D
Case end height	H* <sup>1</sup>	23.35	19.5	21.5
Lead clinch height	H <sub>0</sub>	16.0 <sup>+0.5</sup> <sub>-0.5</sub>		
Tape width	W	18.0 <sup>+1</sup> <sub>-0.5</sub>		
Adhesive tape width	W <sub>0</sub>	13.0 <sup>+0.3</sup> <sub>-0.3</sub>		
Product pitch	P	12.7 <sup>±1</sup>		
Sprocket hole pitch	P <sub>0</sub>	12.7 <sup>±0.3</sup>		
Lead pitch	F	5.0 <sup>+0.8</sup> <sub>-0.2</sub>		
Sprocket hole diameter	D <sub>0</sub>	ø4.0 <sup>±0.2</sup>		

\*1. Tolerance : ±1mm

### Straight type

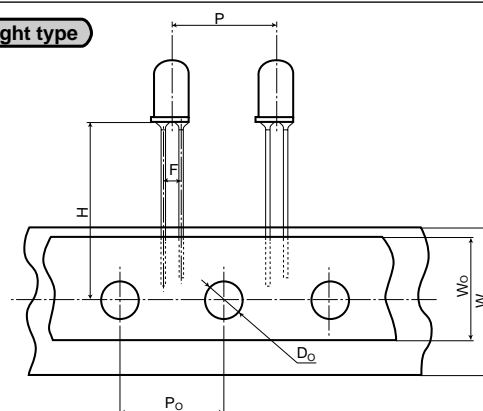

Parameter	Symbol	P	W
Case end height	H* <sup>1</sup>	18.0	23.35
Lead clinch height	H <sub>0</sub>	—	
Tape width	W	18.0 <sup>+1</sup> <sub>-0.5</sub>	
Adhesive tape width	W <sub>0</sub>	13.0 <sup>±0.3</sup>	
Product pitch	P	12.7 <sup>±1</sup>	
Sprocket hole pitch	P <sub>0</sub>	12.7 <sup>±0.3</sup>	
Lead pitch	F	2.54NOM	
Sprocket hole diameter	D <sub>0</sub>	ø4.0 <sup>±0.2</sup>	

\*1. Tolerance : ±1mm

### Dichromatic emission type

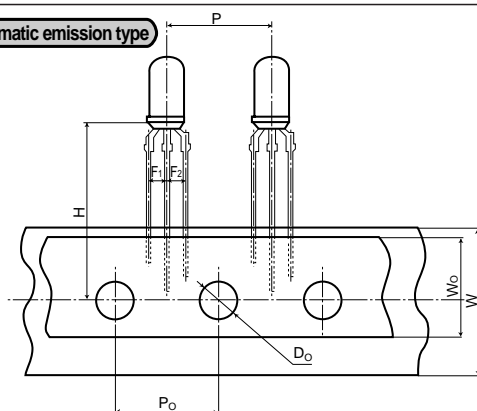

Parameter	Symbol	Size (mm)
Case end height	H* <sup>1</sup>	19.5 <sup>±1.0</sup>
Lead clinch height	H <sub>0</sub>	—
Tape width	W	18.0 <sup>+1.0</sup> <sub>-0.5</sub>
Adhesive tape width	W <sub>0</sub>	13.0 <sup>±0.3</sup>
Product pitch	P	12.7 <sup>±1.0</sup>
Sprocket hole pitch	P <sub>0</sub>	12.7 <sup>±0.3</sup>
Lead pitch	F <sub>1</sub> , F <sub>2</sub>	2.54NOM
Sprocket hole diameter	D <sub>0</sub>	ø4.0 <sup>±0.2</sup>

\*1. Tolerance : ±1mm

### NOTICE

- The circuit application examples in this publication are provided to explain representative applications of SHARP devices and are not intended to guarantee any circuit design or license any intellectual property rights. SHARP takes no responsibility for any problems related to any intellectual property right of a third party resulting from the use of SHARP's devices.
- Contact SHARP in order to obtain the latest device specification sheets before using any SHARP device. SHARP reserves the right to make changes in the specifications, characteristics, data, materials, structure, and other contents described herein at any time without notice in order to improve design or reliability. Manufacturing locations are also subject to change without notice.
- Observe the following points when using any devices in this publication. SHARP takes no responsibility for damage caused by improper use of the devices which does not meet the conditions and absolute maximum ratings to be used specified in the relevant specification sheet nor meet the following conditions:
  - (i) The devices in this publication are designed for use in general electronic equipment designs such as:
    - Personal computers
    - Office automation equipment
    - Telecommunication equipment [terminal]
    - Test and measurement equipment
    - Industrial control
    - Audio visual equipment
    - Consumer electronics
  - (ii) Measures such as fail-safe function and redundant design should be taken to ensure reliability and safety when SHARP devices are used for or in connection with equipment that requires higher reliability such as:
    - Transportation control and safety equipment (i.e., aircraft, trains, automobiles, etc.)
    - Traffic signals
    - Gas leakage sensor breakers
    - Alarm equipment
    - Various safety devices, etc.
  - (iii) SHARP devices shall not be used for or in connection with equipment that requires an extremely high level of reliability and safety such as:
    - Space applications
    - Telecommunication equipment [trunk lines]
    - Nuclear power control equipment
    - Medical and other life support equipment (e.g., scuba).
- Contact a SHARP representative in advance when intending to use SHARP devices for any "specific" applications other than those recommended by SHARP or when it is unclear which category mentioned above controls the intended use.
- If the SHARP devices listed in this publication fall within the scope of strategic products described in the Foreign Exchange and Foreign Trade Control Law of Japan, it is necessary to obtain approval to export such SHARP devices.
- This publication is the proprietary product of SHARP and is copyrighted, with all rights reserved. Under the copyright laws, no part of this publication may be reproduced or transmitted in any form or by any means, electronic or mechanical, for any purpose, in whole or in part, without the express written permission of SHARP. Express written permission is also required before any use of this publication may be made by a third party.
- Contact and consult with a SHARP representative if there are any questions about the contents of this publication.

# LED Lamp Characteristics Diagrams

## ZR series

Forward Current Derating Curve

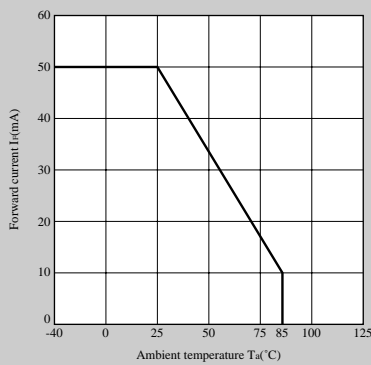

Forward Current vs. Forward Voltage(Note)

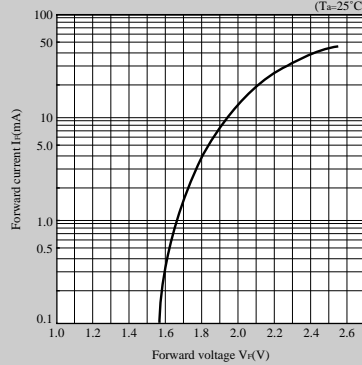

Luminous Intensity vs. Ambient Temperature(Note)

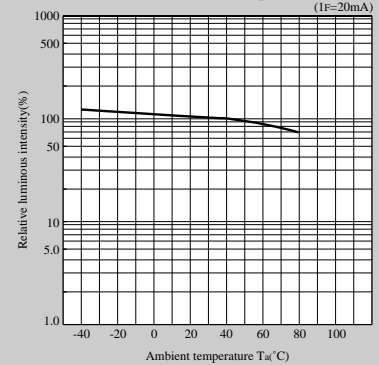

Peak Forward Current Derating Curve

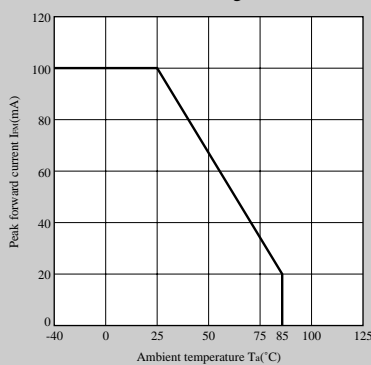

Luminous Intensity vs. Forward Current(Note)

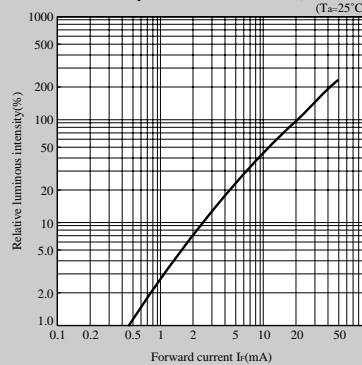

Duty Ratio vs. Peak Forward Current

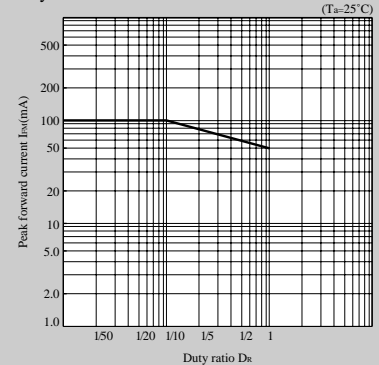

## ZJ series

Forward Current Derating Curve

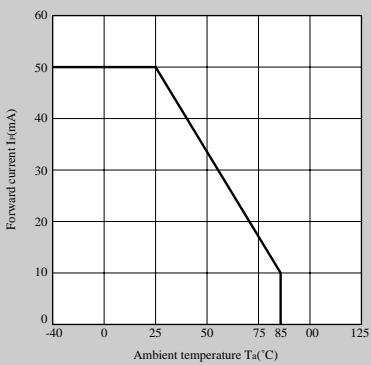

Forward Current vs. Forward Voltage(Note)

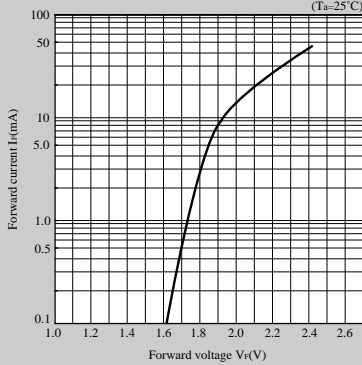

Luminous Intensity vs. Ambient Temperature(Note)

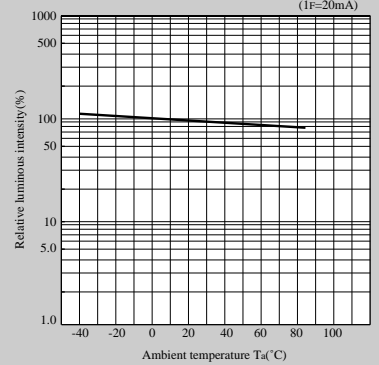

Peak Forward Current Derating Curve

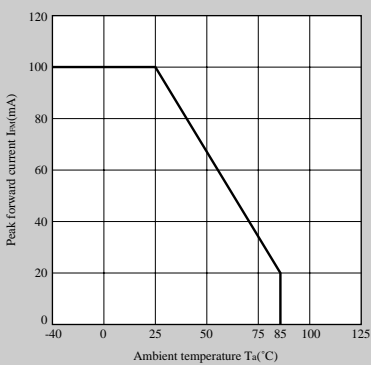

Luminous Intensity vs. Forward Current(Note)

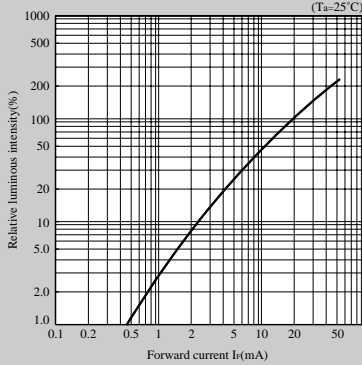

Duty Ratio vs. Peak Forward Current

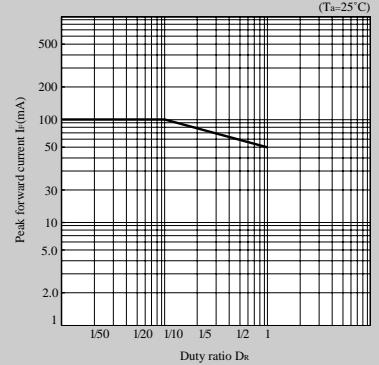

Note) Characteristics shown in diagrams are typical values. (not assurance value)

# LED Lamp Characteristics Diagrams

## ZS series

Forward Current Derating Curve

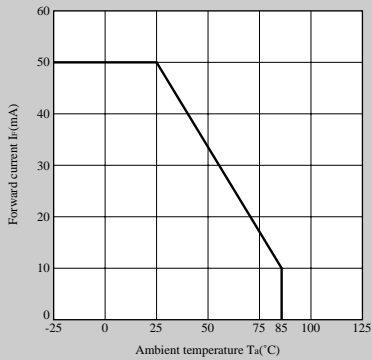

Forward Current vs. Forward Voltage(Note)

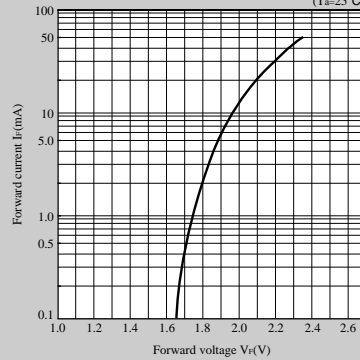

Luminous Intensity vs. Ambient Temperature(Note)

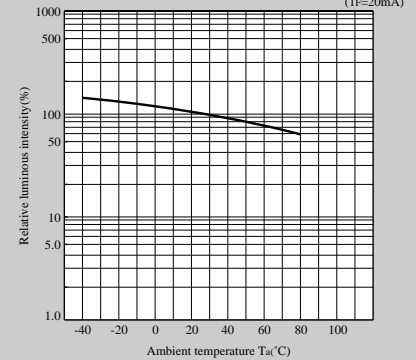

Peak Forward Current Derating Curve

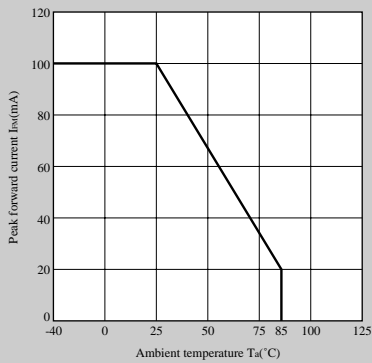

Luminous Intensity vs. Forward Current(Note)

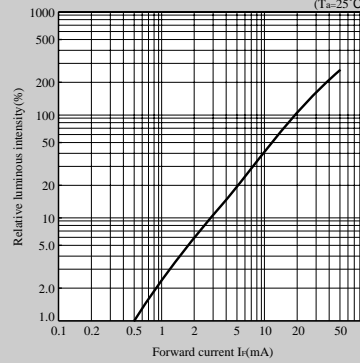

Duty Ratio vs. Peak Forward Current

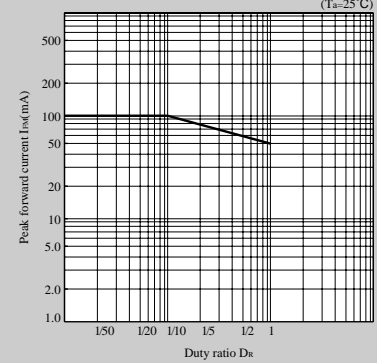

## GL5XS022BOS

Forward Current Derating Curve

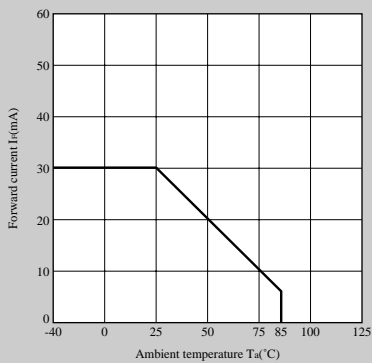

Forward Current vs. Forward Voltage(Note)

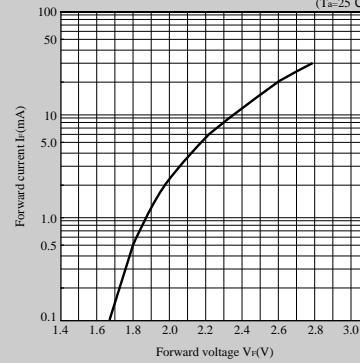

Luminous Intensity vs. Ambient Temperature(Note)

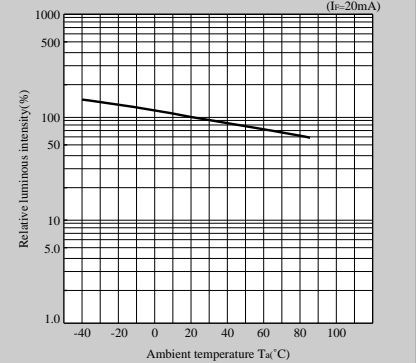

Peak Forward Current Derating Curve

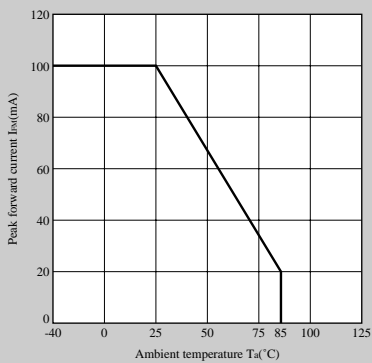

Luminous Intensity vs. Forward Current(Note)

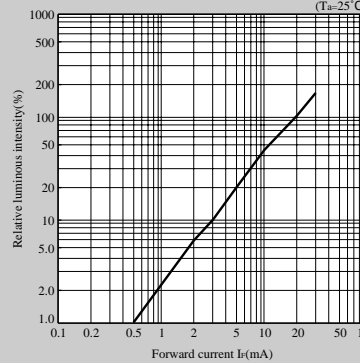

Duty Ratio vs. Peak Forward Current

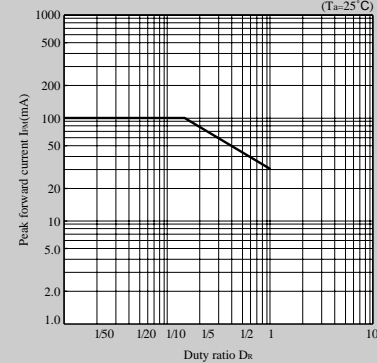

Note) Characteristics shown in diagrams are typical values. (not assurance value)

# LED Lamp Characteristics Diagrams

## ZV series

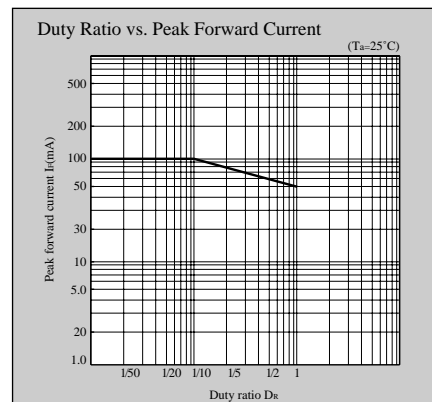
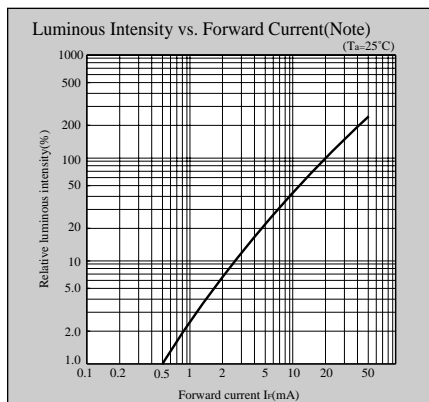
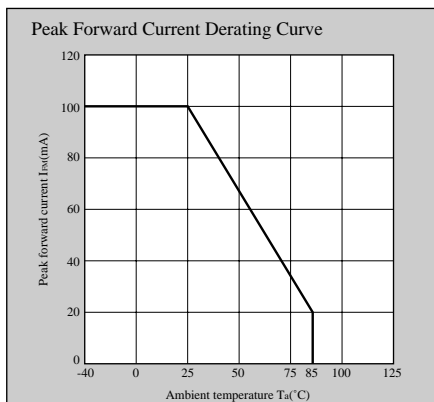
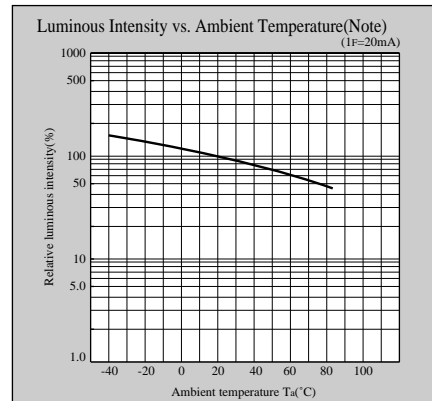
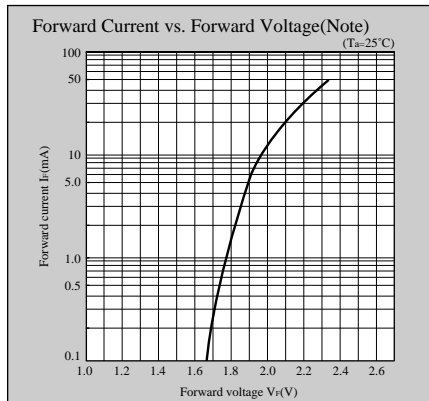
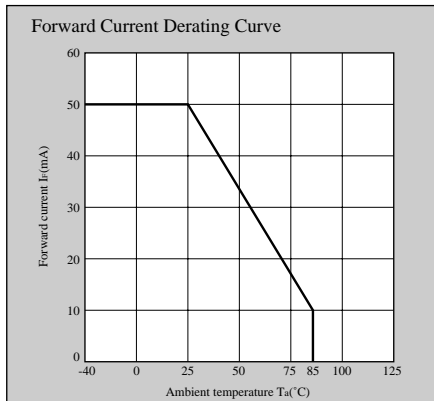

## ZE series

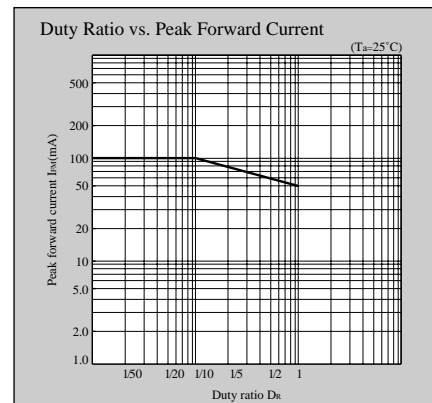
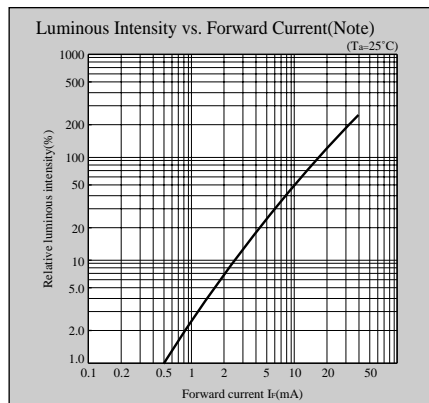
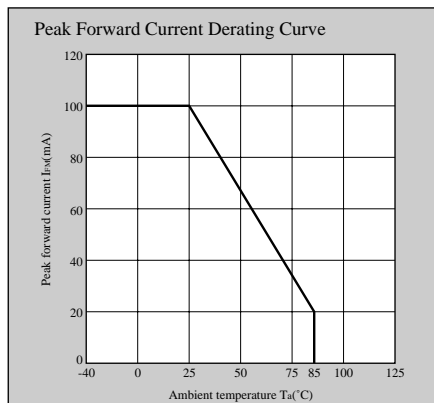
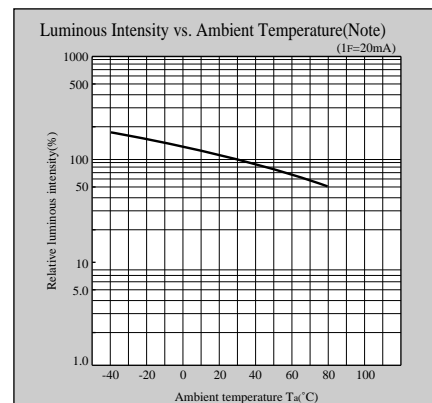
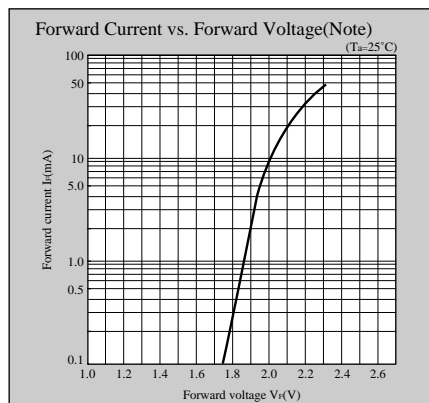
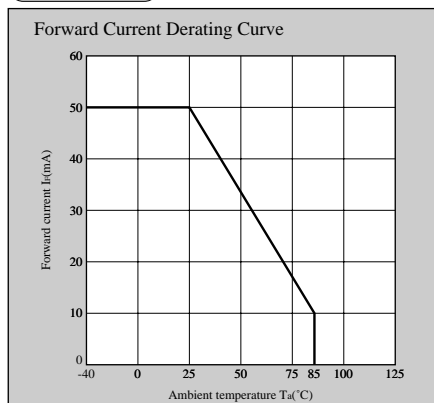

Note) Characteristics shown in diagrams are typical values. (not assurance value)

# LED Lamp Characteristics Diagrams

## ZG series

Forward Current Derating Curve

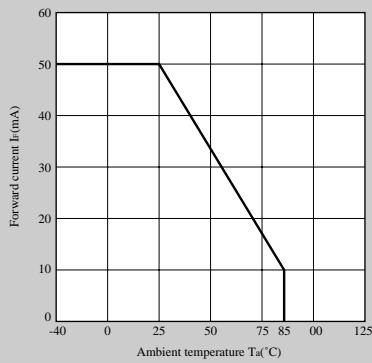

Forward Current vs. Forward Voltage(Note)

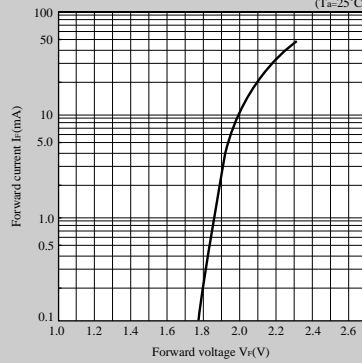

Luminous Intensity vs. Ambient Temperature(Note)

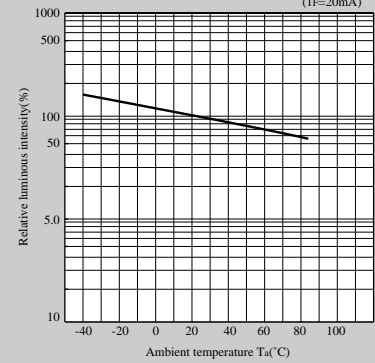

Peak Forward Current Derating Curve

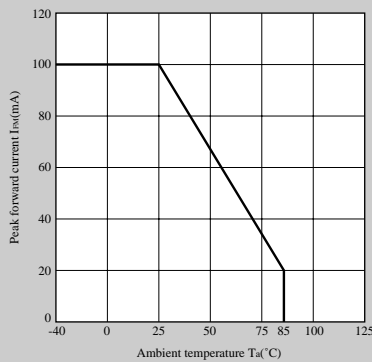

Luminous Intensity vs. Forward Current(Note)

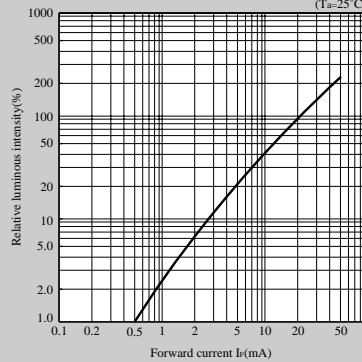

Duty Ratio vs. Peak Forward Current

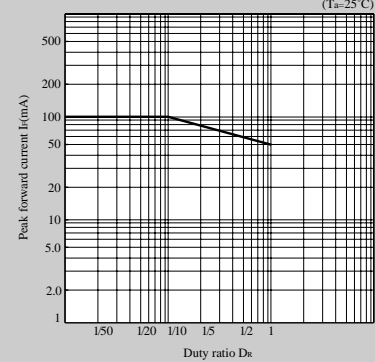

## UR,U series

Forward Current Derating Curve

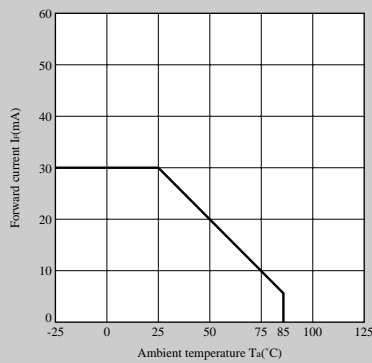

Forward Current vs. Forward Voltage(Note)

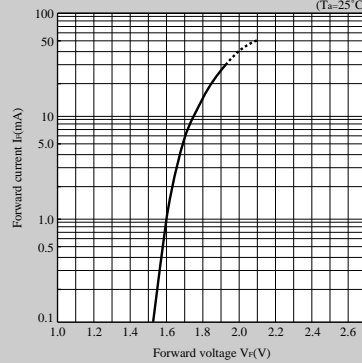

Luminous Intensity vs. Ambient Temperature(Note)

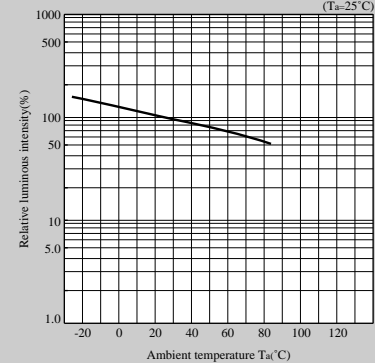

Peak Forward Current Derating Curve

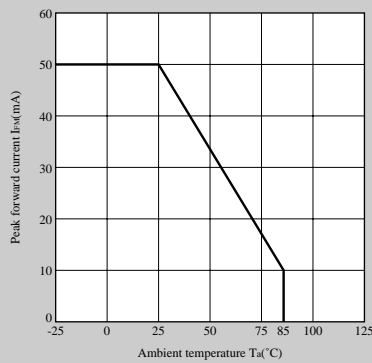

Luminous Intensity vs. Forward Current(Note)

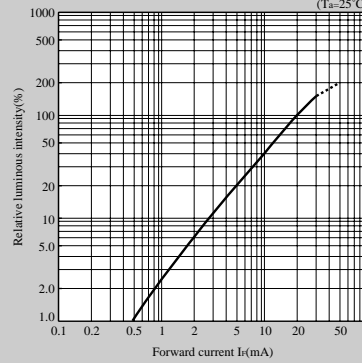

Duty Ratio vs. Peak Forward Current

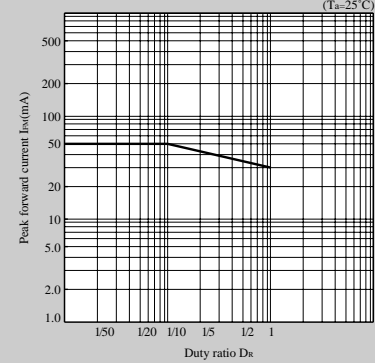

Note) Characteristics shown in diagrams are typical values. (not assurance value)



### NOTICE

- The circuit application examples in this publication are provided to explain representative applications of SHARP devices and are not intended to guarantee any circuit design or license any intellectual property rights. SHARP takes no responsibility for any problems related to any intellectual property right of a third party resulting from the use of SHARP's devices.
- Contact SHARP in order to obtain the latest device specification sheets before using any SHARP device. SHARP reserves the right to make changes in the specifications, characteristics, data, materials, structure, and other contents described herein at any time without notice in order to improve design or reliability. Manufacturing locations are also subject to change without notice.
- Observe the following points when using any devices in this publication. SHARP takes no responsibility for damage caused by improper use of the devices which does not meet the conditions and absolute maximum ratings to be used specified in the relevant specification sheet nor meet the following conditions:
  - (i) The devices in this publication are designed for use in general electronic equipment designs such as:
    - Personal computers
    - Office automation equipment
    - Telecommunication equipment [terminal]
    - Test and measurement equipment
    - Industrial control
    - Audio visual equipment
    - Consumer electronics
  - (ii) Measures such as fail-safe function and redundant design should be taken to ensure reliability and safety when SHARP devices are used for or in connection with equipment that requires higher reliability such as:
    - Transportation control and safety equipment (i.e., aircraft, trains, automobiles, etc.)
    - Traffic signals
    - Gas leakage sensor breakers
    - Alarm equipment
    - Various safety devices, etc.
  - (iii) SHARP devices shall not be used for or in connection with equipment that requires an extremely high level of reliability and safety such as:
    - Space applications
    - Telecommunication equipment [trunk lines]
    - Nuclear power control equipment
    - Medical and other life support equipment (e.g., scuba).
- Contact a SHARP representative in advance when intending to use SHARP devices for any "specific" applications other than those recommended by SHARP or when it is unclear which category mentioned above controls the intended use.
- If the SHARP devices listed in this publication fall within the scope of strategic products described in the Foreign Exchange and Foreign Trade Control Law of Japan, it is necessary to obtain approval to export such SHARP devices.
- This publication is the proprietary product of SHARP and is copyrighted, with all rights reserved. Under the copyright laws, no part of this publication may be reproduced or transmitted in any form or by any means, electronic or mechanical, for any purpose, in whole or in part, without the express written permission of SHARP. Express written permission is also required before any use of this publication may be made by a third party.
- Contact and consult with a SHARP representative if there are any questions about the contents of this publication.