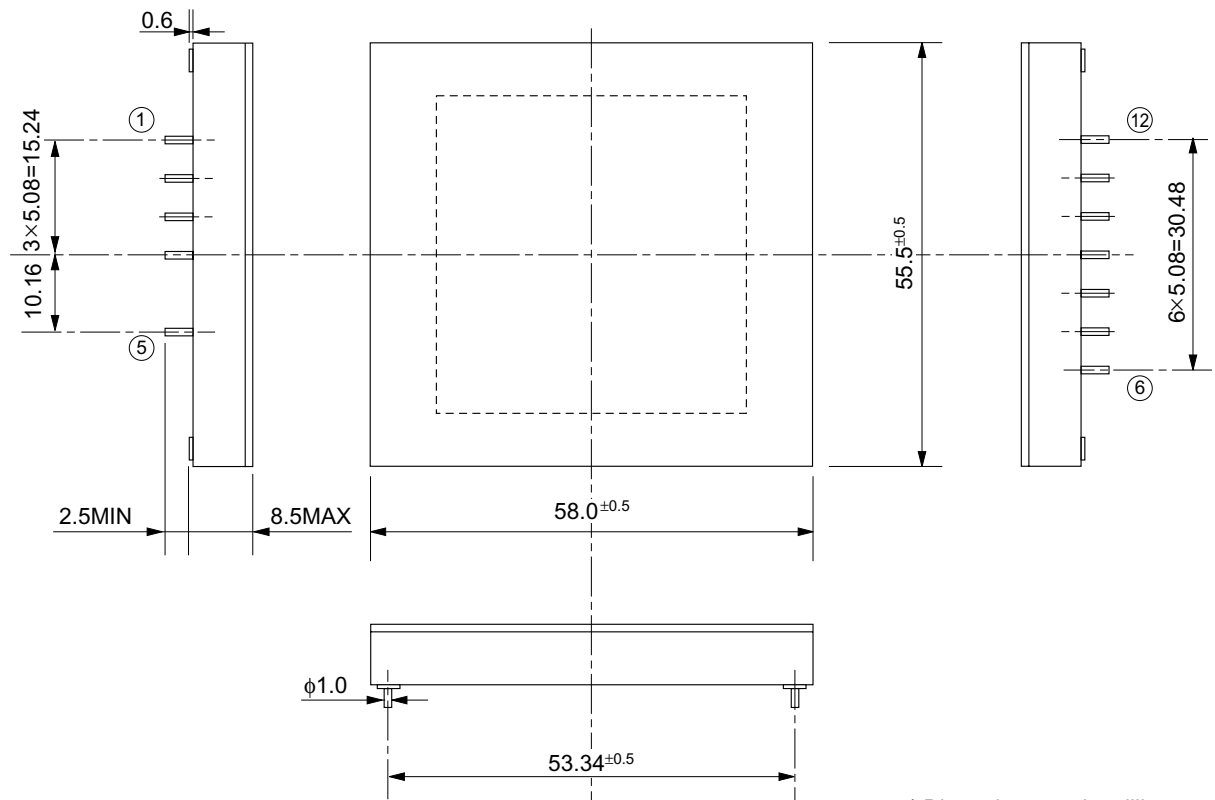

Output voltage	(V)	3.3
Input voltage	(V)	-48
Input voltage range	(V)	-36~-60
Conduction noise	(dBm)	-53
Output voltage range		+5%, -3.5%
Output Current	(A)	10
Output current range	(A)	0~10
Over current protection	(A)	15
Over voltage protection	(V)	4.2
Output ripple noise	(mVp-p)	100
Efficiency		91%
Operating temperature		Ta=0~70°C
Mechanical dimension	(mm)	56.0×58.5×8.5
Isolated voltage	(V)	AC 500, DC 707 (applied for 1minute)
Parallel operation		○
Cooling method		Forced air cooling (1.5m/sec)
Low voltage protection	(V)	2.5

Outline diagram

* Dimensions are in millimeters.

Pin arrangement

Pin No.	Symbol		Function
1	LO		Local off control signal pin
2	RO		Remote off control signal pin
3	-IN		Input voltage pin
4	+IN		Input ground pin
5	CTL		Live line insertion and removal control signal pin
6	3.3V	-	Output ground pin
7			
8			
9		+	Output voltage pin
10			
11			
12	TT		Not connected*

*NC may be used for testing by the manufacturer and shall not be connected by the customer.