

## 4.0x4.0mm SURFACE MOUNT LED LAMP



# SUN LED

Email : sales@us.sunled.com

Web Site : www.sunled.com

XZMDK67W

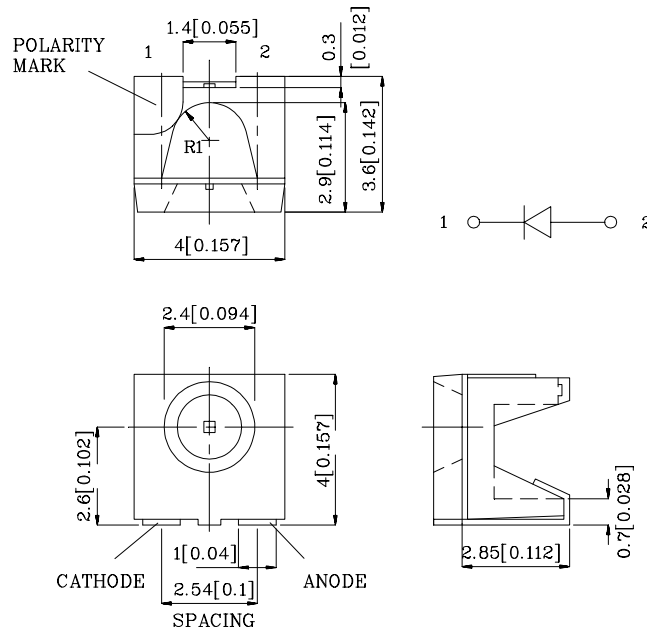

Notes:

1. All dimensions are in millimeters (inches).
2. Tolerance is  $\pm 0.25$  (0.01") unless otherwise noted.

Absolute maximum ratings ( $T_A=25^{\circ}\text{C}$ )		MDK (InGaAlP)	Unit
Reverse voltage	$V_R$	5	V
Forward current	$I_F$	30	mA
Forward current (peak) 1/10Duty cycle 0.1ms pulse width	$i_{FS}$	185	mA
Power dissipation	$P_T$	170	mW
Operating temperature	$T_A$	-40 ~ +85	$^{\circ}\text{C}$
Storage temperature	$T_{stg}$	-40 ~ +85	

Operating Characteristics ( $T_A=25^{\circ}\text{C}$ )		MDK (InGaAlP)	Unit
Forward voltage (typ.) ( $I_F=20\text{mA}$ )	$V_F$	1.95	V
Forward voltage (max.) ( $I_F=20\text{mA}$ )	$V_F$	2.5	V
Reverse current ( $V_R=5\text{V}$ )	$I_R$	10	$\mu\text{A}$
Wavelength at peak emission ( $I_F=20\text{mA}$ )	$\lambda_{\text{peak}}$	650	nm
Wavelength at Dominate emission ( $I_F=20\text{mA}$ )	$\lambda_D$	635	nm
Spectral Line half-width ( $I_F=20\text{mA}$ )	$\Delta\lambda$	28	nm
Capacitance ( $V_F=0\text{V}$ , $f=1\text{MHz}$ )	$C$	35	pF

Part Number	Emitting Color	Emitting Material	Lens-color	Luminous Intensity ( $I_F=20\text{mA}$ ) mcd		Wavelength nm $\lambda_P$	Viewing Angle $2\theta_{1/2}$
				min.	typ.		
XZMDK67W	Red	InGaAlP	Water Clear	70	190	650	120°

**XZMDK67W**

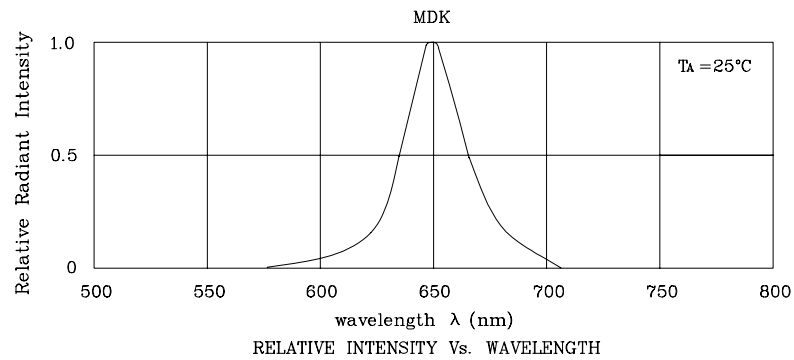

**◆MDK**

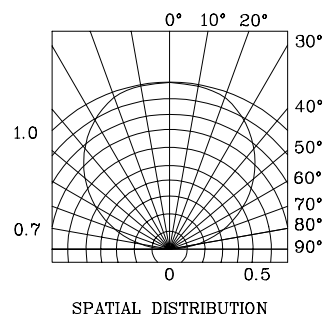
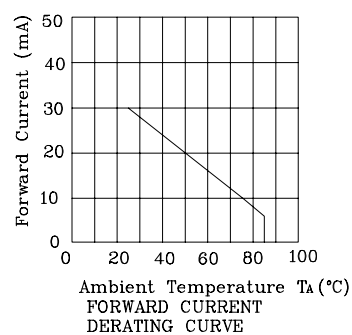
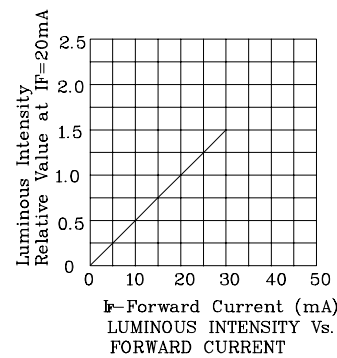
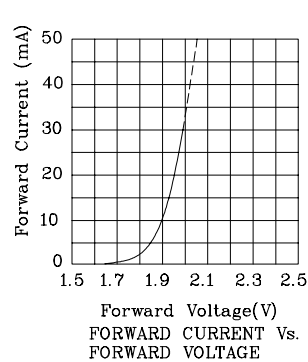

# XZMDK67W

## ❖SMT Reflow Soldering Instructions

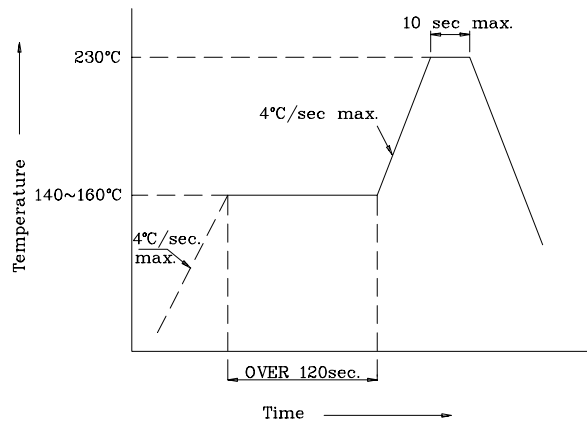

## ❖Recommended Soldering Pattern (Units: mm ; Tolerance: $\pm 0.1$ )

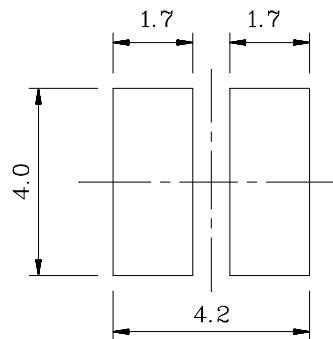

## ❖Tape Specification (Units : mm)

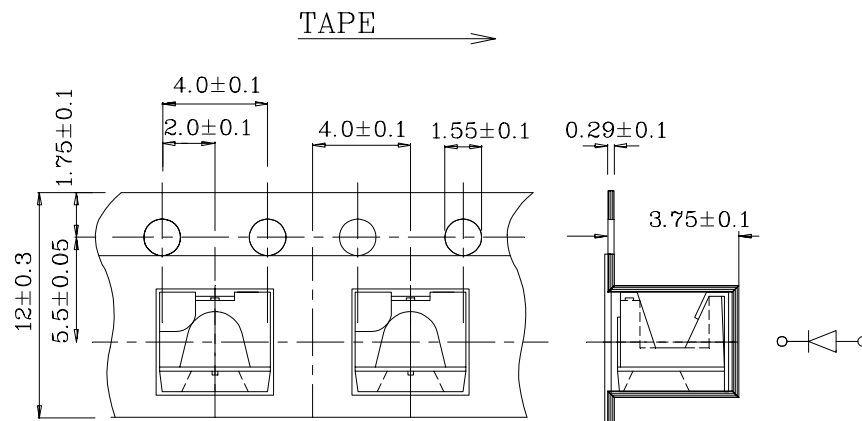

PACKAGE:500PCS / REEL