

# VOLTAGE CONTROLLED OSCILLATOR

## SURFACE MOUNT MODEL: DCMO90220-5

WIDE BANDWIDTH

900 - 2200 MHz

### FEATURES:

- ▶ Exceptional Phase Noise Performance
- ▶ Small Size, Surface Mount
- ▶ Lead Free REL-PRO® Technology

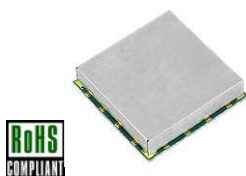

### Phase Noise

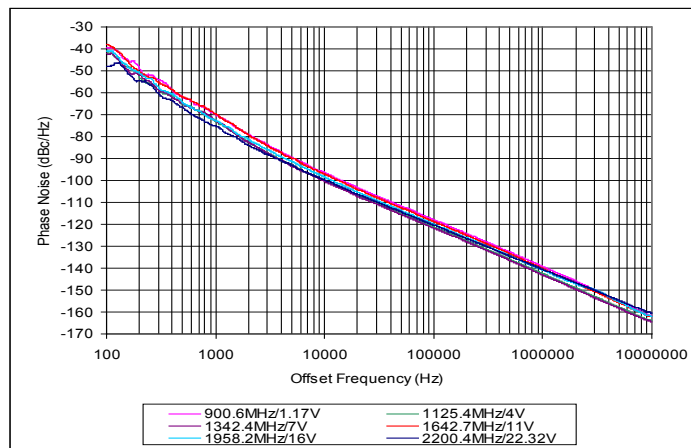

### SPECIFICATIONS

Frequency	900 - 2200 MHz
Tuning Voltage (Full Band)	0.5 - 24 VDC
Bias Voltage	+5 VDC @ 35 mA (Max)
Output Power	+4 dBm (Min)
Tuning Sensitivity	24 - 82 MHz/V (Typ)
Output Impedance	50 Ohms (Nom)
Harmonic Suppression	15 dBc (Typ)
Frequency Pulling	5 MHz (Typ @ 1.75:1 VSWR)
Frequency Pushing	5 MHz/V (Typ)
Phase Noise @ 10 kHz	-98 dBc/Hz (Typ)
Operating Temperature Range	-40 to +85 °C

### Guaranteed Tuning Specifications

Tuning Voltage ( V )	Frequency ( MHz )
0.5	900 (Max)
5	1100 (Min)
8	1250 (Min)
12	1500 (Min)
15	1750 (Min)
18	1900 (Min)
24	2200 (Min)

Package # 278LF

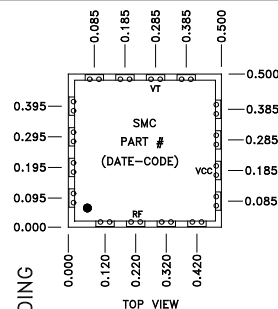

REL-PRO® PATENT PENDING

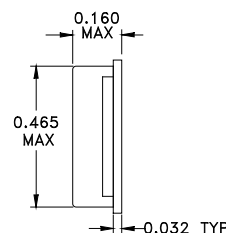
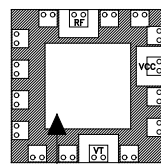

### RECOMMENDED PCB LAYOUT

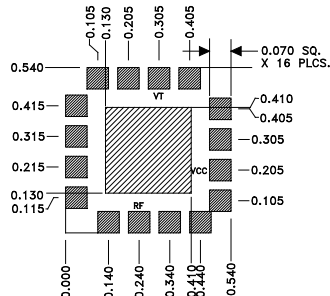

OPTIONAL SOLDER AREA FOR HIGH VIBRATION ENVIRONMENT

TOLERANCES ON THREE DECIMAL PLACES= ± 0.015

PACKAGE MOUNTING: SEE APPLICATION NOTE AN7200

ALL UNLABELED PINS TO BE GROUNDED.

# VOLTAGE CONTROLLED OSCILLATOR

## SURFACE MOUNT MODEL: DCMO90220-5

WIDE BANDWIDTH

900 - 2200 MHz

PERFORMANCE PLOTS

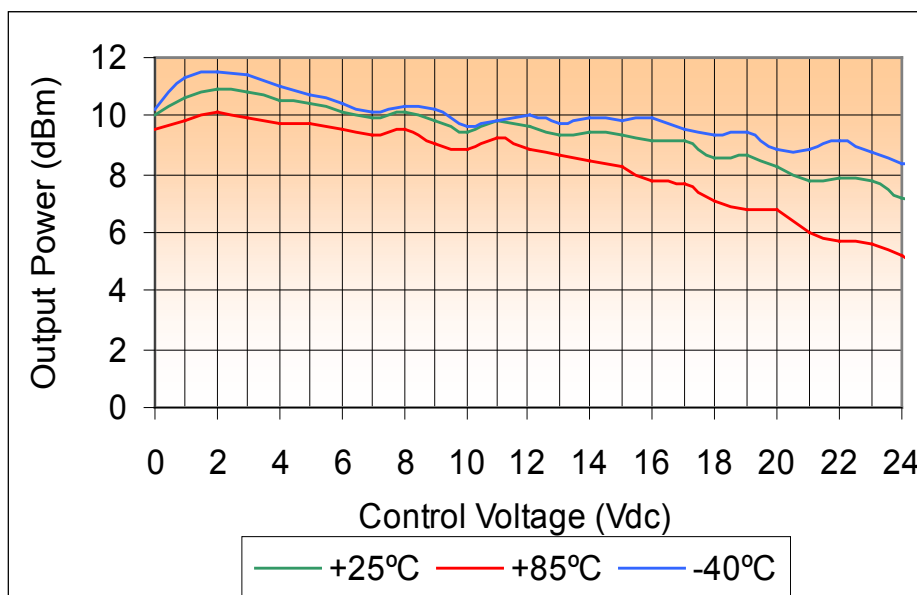
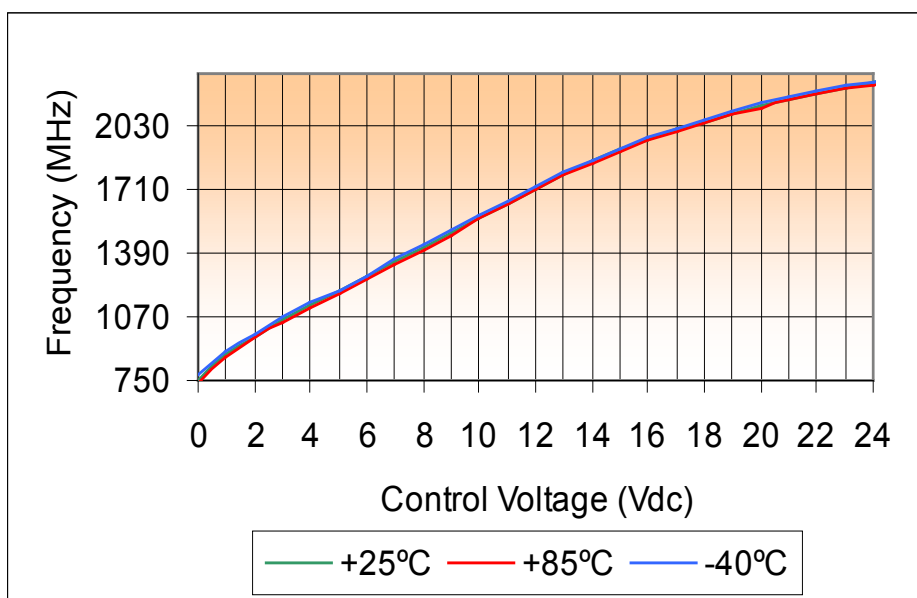

# VOLTAGE CONTROLLED OSCILLATOR

## SURFACE MOUNT MODEL: DCMO90220-5

WIDE BANDWIDTH

900 - 2200 MHz

PERFORMANCE PLOTS

