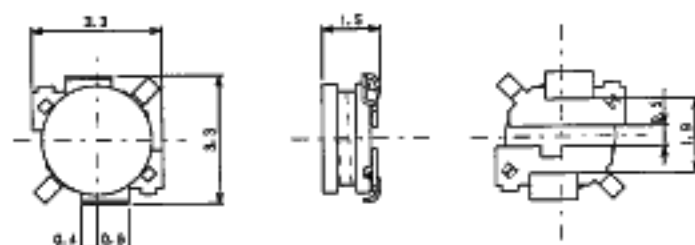
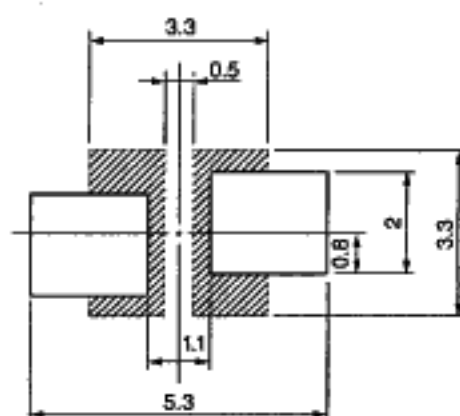

TYPE D31FU
Frequency Range: 10kHz - 1MHz

Inductance Range: 0.1 - 1.2mH

Unit: mm
Tolerance : ± 0.2
Features

- Low profile (1.5mm typ. Height) and 3.3mm square
- Ideal for IC inverter EL lamp driver applications
- Available on tape and reel for auto-insertion
- Suitable for reflow soldering

Recommended patterns:

Unit: mm

STANDARD PARTS SELECTION GUIDE

- (1) Inductance is measured by LCR-meter 4284A (HP) or equivalent.
 (2) DC Resistance is measured by Digital Multimeter TR6871 (Advantest) or equivalent.
 (3) Maximum allowable DC current is that which causes a 10% inductance reduction from the initial value, or coil temperature to rise by 40°C, whichever is smaller. (Reference ambient temperature 20°C).

TYPE D31FU				
TOKO Part Number	Inductance ⁽¹⁾ (mH) $\pm 20\%$	DC ⁽²⁾ Resistance (Ω) max.	Inductance Decrease Current (mA) max.	Temperature Rise Current (mA) max.
888FU-101M	0.1	4.8	168	161
888FU-121M	0.12	6.0	152	148
888FU-151M	0.15	7.1	138	137
888FU-181M	0.18	9.0	121	121
888FU-221M	0.22	10	115	107
888FU-271M	0.27	14	100	97
888FU-331M	0.33	16	92	90
888FU-391M	0.39	18	85	86
888FU-471M	0.47	26	78	68
888FU-561M	0.56	30	72	68
888FU-681M	0.68	34	66	62
888FU-821M	0.82	46	58	52
888FU-102M	1.0	53	54	50
888FU-122M	1.2	60	50	47