

2,000 V - 5,000 V Rectifiers

0.8 A - 2.0 A Forward Current

30 ns - 50 ns Recovery Time

Z20FF3LL Z20FF5LL

Z50FF3LL Z50FF5LL

FORMED LEAD



ELECTRICAL CHARACTERISTICS AND MAXIMUM RATINGS

Part Number	Working Reverse Voltage	Average Rectified Current		Reverse Current @ Vrwm		Forward Voltage		1 Cycle Surge Current tp=8.3ms (Ifsm)	Repetitive Surge Current (Ifrm)	Reverse Recovery Time (3) (Trr)	Thermal Impd. θ_{J-C}	Junction Cap. @50VDC @1kHz (Cj)
	(Vrwm)	(Io)		(Ir)		(Vf)						
	Volts	55°C(1) Amps	100°C(2) Amps	25°C μ A	100°C μ A	25°C Volts	25°C Amps	25°C Amps	25°C Amps	25°C ns	25°C °C/ W	25°C pF
Z20FF3LL Z50FF3LL	2000 5000	2.0 0.8	1.2 0.4	1.0 1.0	25 25	6.0 12.5	0.75 0.36	65 22	10 4.0	30 30	5.0 5.0	20 16
Z20FF5LL Z50FF5LL	2000 5000	2.0 0.8	1.2 0.4	1.0 1.0	25 25	6.0 12.5	0.75 0.36	65 22	10 4.0	50 50	5.0 5.0	20 16

(1)TC=55°C (2)TC=100°C (3)If=0.5A, Ir=1.0A, Irr=0.25A *Op. Temp.= -65°C to +175°C Stg. Temp.= -65°C to +200°C

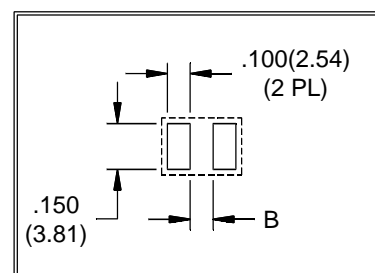
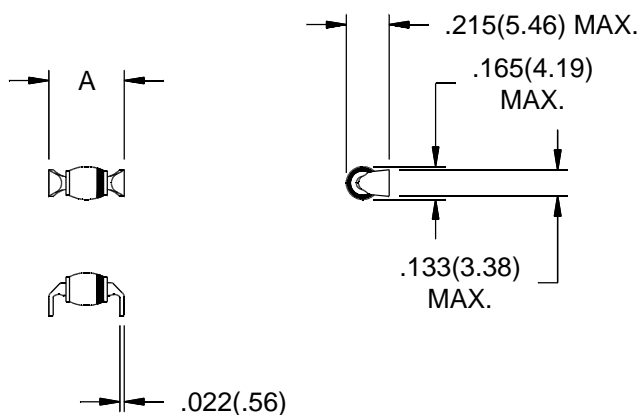

Part	A	B
Z20FF3LL Z20FF5LL	.350(8.89) MAX.	.220(5.59)
Z50FF3LL Z50FF5LL	.390(9.91) MAX.	.260(6.60)



Dimensions: In. (mm) • All temperatures are ambient unless otherwise noted. • Data subject to change without notice.



VOLTAGE MULTIPLIERS INC.
8711 W. Roosevelt Ave.
Visalia, CA 93291

TEL 559-651-1402
FAX 559-651-0740
www.voltagemultipliers.com

Z20FF3LL Z50FF3LL Z20FF5LL Z50FF5LL

