

# 2.50mm (0.098") PITCH CONNECTOR

Wire-to-Board  
Housing

SMH250 Series

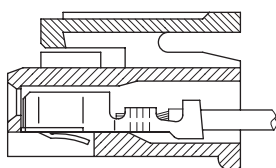
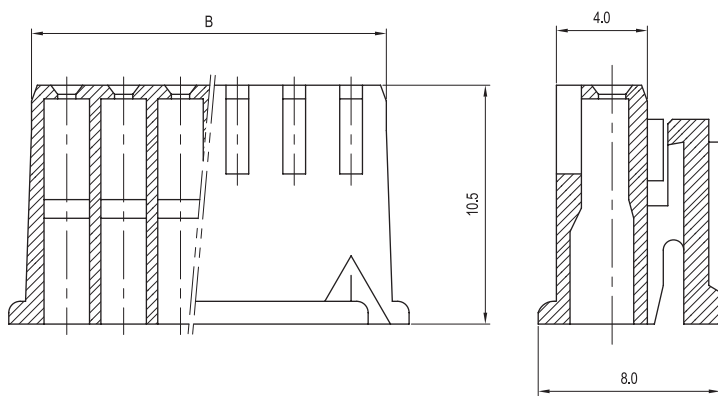
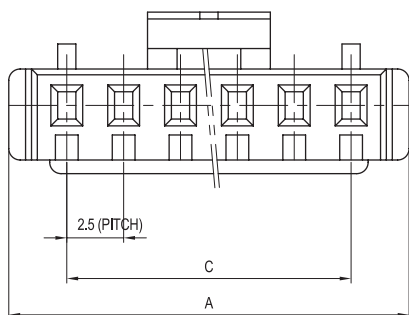
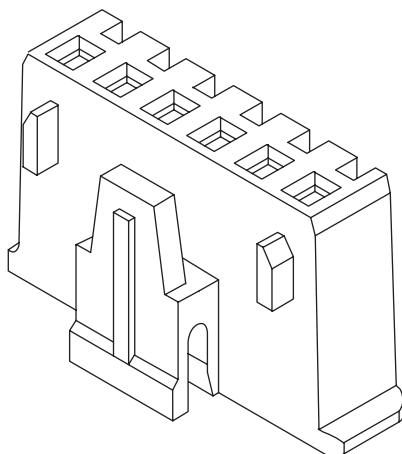

TERMINAL ASSEMBLY DRAWING

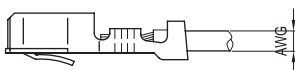

AWG : #22 ~ #28

## Material

I/NO	DESCRIPTION	TITLE	MATERIAL
1	HOUSING	SMH250	PA66, UL94 V Grade

## Available Pin

PARTS NO.	A	B	C
SMH250-02	7.2	5.6	2.5
SMH250-03	9.7	8.1	5.0
SMH250-04	12.2	10.6	7.5
SMH250-05	14.7	13.1	10.0
SMH250-06	17.2	15.6	12.5
SMH250-07	19.7	18.1	15.0
SMH250-08	22.2	20.6	17.5
SMH250-09	24.7	23.1	20.0
SMH250-10	27.2	25.6	22.5
SMH250-11	29.7	28.1	25.0
SMH250-12	32.2	30.6	27.5
SMH250-13	34.7	33.1	30.0
SMH250-14	37.2	35.6	32.5
SMH250-15	39.7	38.1	35.0

## Specification

ITEM	SPEC
Voltage Rating	AC/DC 250V
Current Rating	AC/DC 3A
Operating Temperature	-25℃~+85℃
Contact Resistance	30mΩ MAX
Withstanding Voltage	AC1000V/1min
Insulation Resistance	1000MΩ MIN
Applicable Wire	AWG #22~#28
Applicable P.C.B	-
Applicable FPC/FFC	-
Solder Height	-
Crimp Tensile Strength	-
UL FILE NO	E108706

Application Terminal : YST025 (143 page)