

# 2.50mm (0.098") PITCH CONNECTOR

Wire-to-Board  
Housing

SMH250J Series

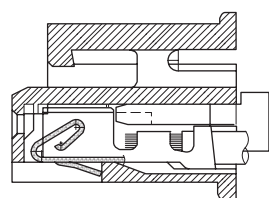
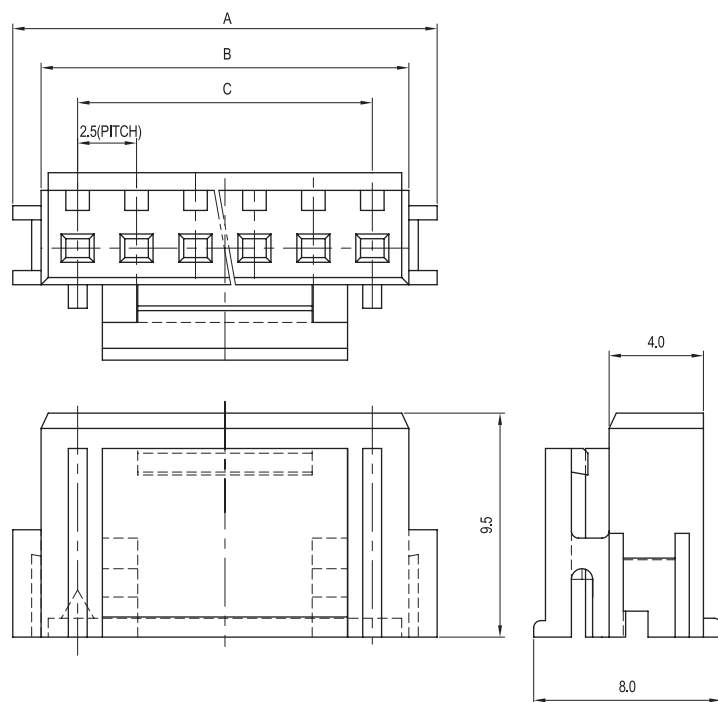
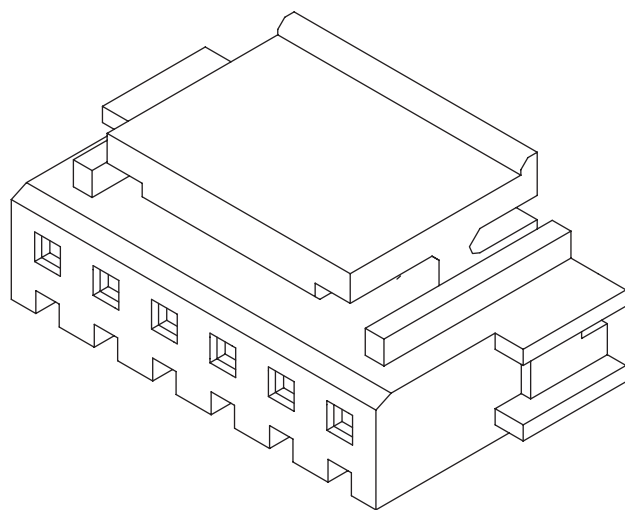

TERMINAL ASSEMBLY DRAWING

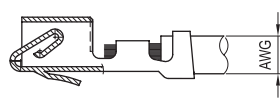

AWG : #22 ~ #28

## Material

I/NO	DESCRIPTION	TITLE	MATERIAL
1	Housing	SMH250-NNJ	PA66, UL94 V Grade

## Available Pin

PARTS NO.	A	B	C
SMH250-02J	8.0	5.6	2.5
SMH250-03J	10.5	8.1	5.0
SMH250-04J	13.0	10.6	7.5
SMH250-05J	15.5	13.1	10.0
SMH250-06J	18.0	15.6	12.5
SMH250-07J	20.5	18.1	15.0
SMH250-08J	23.0	20.6	17.5
SMH250-09J	25.5	23.1	20.0
SMH250-10J	28.0	25.6	22.5
SMH250-11J	30.5	28.1	25.0
SMH250-12J	33.0	30.6	27.5
SMH250-13J	35.5	33.1	30.0
SMH250-14J	38.0	35.6	32.5
SMH250-15J	40.5	38.1	35.0

## Specification

ITEM	SPEC
Voltage Rating	AC/DC 250V
Current Rating	AC/DC 3A
Operating Temperature	-25℃~+85℃
Contact Resistance	30mΩ MAX
Withstanding Voltage	AC1000V/1min
Insulation Resistance	1000MΩ MIN
Applicable Wire	AWG #22~#28
Applicable P.C.B	-
Applicable FPC/FFC	-
Solder Height	-
Crimp Tensile Strength	-
UL FILE NO	-

Application Terminal : YST025J (151 page)