

# ZXMN3A04DN8

## DUAL 30V N-CANNEL ENHANCEMENT MODE MOSFET

### SUMMARY

$V_{(BR)DSS}=30V$ ;  $R_{DS(ON)}=0.025\Omega$  ;  $I_D=7.6A$

### DESCRIPTION

This new generation of TRENCH MOSFETs from Zetex utilizes a unique structure that combines the benefits of low on-resistance with fast switching speed. This makes them ideal for high efficiency, low voltage, power management applications.

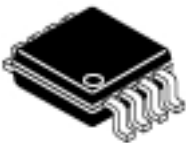

SO8

### FEATURES

- Low on-resistance
- Fast switching speed
- Low threshold
- Low gate drive
- Low profile SOIC package

### APPLICATIONS

- DC - DC Converters
- Power Management Functions
- Disconnect switches
- Motor control

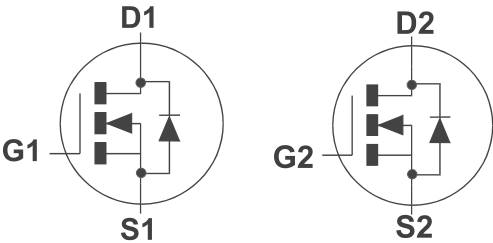

### ORDERING INFORMATION

DEVICE	REEL SIZE	TAPE WIDTH	QUANTITY PER REEL
ZXMN3A04DN8TA	7"	12mm	500 units
ZXMN3A04DN8TC	13"	12mm	2500 units

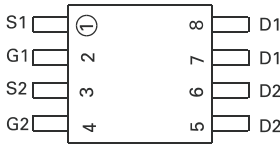

Top View

### DEVICE MARKING

- ZXMN  
3A04D

# ZXMN3A04DN8

## ABSOLUTE MAXIMUM RATINGS.

PARAMETER	SYMBOL	LIMIT	UNIT
Drain-Source Voltage	$V_{DS}$	30	V
Gate Source Voltage	$V_{GS}$	$\pm 20$	V
Continuous Drain Current ( $V_{GS}=10V$ ; $T_A=25^\circ C$ )(b)(d) ( $V_{GS}=10V$ ; $T_A=70^\circ C$ )(b)(d) ( $V_{GS}=10V$ ; $T_A=25^\circ C$ )(a)(d)	$I_D$	7.6 6.0 5.8	A
Pulsed Drain Current (c)	$I_{DM}$	25	A
Continuous Source Current (Body Diode) (b)	$I_S$	2.5	A
Pulsed Source Current (Body Diode)(c)	$I_{SM}$	25	A
Power Dissipation at $T_A=25^\circ C$ (a)(d) Linear Derating Factor	$P_D$	1.25 10	W mW/ $^\circ C$
Power Dissipation at $T_A=25^\circ C$ (a)(e) Linear Derating Factor	$P_D$	1.8 14	W mW/ $^\circ C$
Power Dissipation at $T_A=25^\circ C$ (b)(d) Linear Derating Factor	$P_D$	2.1 17	W mW/ $^\circ C$
Operating and Storage Temperature Range	$T_J, T_{stg}$	-55 to +150	$^\circ C$

## THERMAL RESISTANCE

PARAMETER	SYMBOL	VALUE	UNIT
Junction to Ambient (a)(d)	$R_{\theta JA}$	100	$^\circ C/W$
Junction to Ambient (a)(e)	$R_{\theta JA}$	70	$^\circ C/W$
Junction to Ambient (b)(d)	$R_{\theta JA}$	60	$^\circ C/W$

### NOTES

(a) For a device surface mounted on 25mm x 25mm FR4 PCB with high coverage of single sided 1oz copper, in still air conditions

(b) For a device surface mounted on FR4 PCB measured at  $t \leq 10$  secs.

(c) Repetitive rating 25mm x 25mm FR4 PCB,  $D=0.05$  pulse width=10 $\mu s$  - pulse width limited by maximum junction temperature. Refer to Transient Thermal Impedance graph.

(d) For device with one active die

(e) For device with two active die running at equal power.



PROVISIONAL ISSUE A - AUGUST 2001

# ZXMN3A04DN8

## ELECTRICAL CHARACTERISTICS (at $T_A = 25^\circ\text{C}$ unless otherwise stated).

PARAMETER	SYMBOL	MIN.	TYP.	MAX.	UNIT	CONDITIONS.
STATIC						
Drain-Source Breakdown Voltage	V <sub>(BR)DSS</sub>	30			V	I <sub>D</sub> =250μA, V <sub>GS</sub> =0V
Zero Gate Voltage Drain Current	I <sub>DSS</sub>			0.5	μA	V <sub>DS</sub> =30V, V <sub>GS</sub> =0V
Gate-Body Leakage	I <sub>GSS</sub>			100	nA	V <sub>GS</sub> =±20V, V <sub>DS</sub> =0V
Gate-Source Threshold Voltage	V <sub>GS(th)</sub>	1.0			V	I <sub>D</sub> =250μA, V <sub>DS</sub> = V <sub>GS</sub>
Static Drain-Source On-State Resistance (1)	R <sub>DS(on)</sub>			0.02 0.03	Ω Ω	V <sub>GS</sub> =10V, I <sub>D</sub> =12.6A V <sub>GS</sub> =4.5V, I <sub>D</sub> =10.6A
Forward Transconductance (3)	g <sub>fs</sub>		17.5		S	V <sub>DS</sub> =15V,I <sub>D</sub> =6A
DYNAMIC (3)						
Input Capacitance	C <sub>iss</sub>		1800		pF	V <sub>DS</sub> =25V, V <sub>GS</sub> =0V, f=1MHz
Output Capacitance	C <sub>oss</sub>		289		pF	
Reverse Transfer Capacitance	C <sub>rss</sub>		178		pF	
SWITCHING(2) (3)						
Turn-On Delay Time	t <sub>d(on)</sub>		5.5		ns	V <sub>DD</sub> =15V, I <sub>D</sub> =6A R <sub>G</sub> =6.0Ω, V <sub>GS</sub> =10V
Rise Time	t <sub>r</sub>		8.7		ns	
Turn-Off Delay Time	t <sub>d(off)</sub>		33		ns	
Fall Time	t <sub>f</sub>		8.5		ns	
Gate Charge	Q <sub>g</sub>		19.4		nC	V <sub>DS</sub> =15V,V <sub>GS</sub> =5V, I <sub>D</sub> =3.5A
Total Gate Charge	Q <sub>g</sub>		35.7		nC	V <sub>DS</sub> =15V,V <sub>GS</sub> =10V, I <sub>D</sub> =3.5A
Gate-Source Charge	Q <sub>gs</sub>		5.5		nC	
Gate-Drain Charge	Q <sub>gd</sub>		7.0		nC	
SOURCE-DRAIN DIODE						
Diode Forward Voltage (1)	V <sub>SD</sub>			0.95	V	T <sub>J</sub> =25°C, I <sub>S</sub> =6A, V <sub>GS</sub> =0V
Reverse Recovery Time (3)	t <sub>rr</sub>		20.5		ns	T <sub>J</sub> =25°C, I <sub>F</sub> =6A, di/dt= 100A/μs
Reverse Recovery Charge (3)	Q <sub>rr</sub>		41.5		nC	

### NOTES

- (1) Measured under pulsed conditions. Width=300 $\mu\text{s}$ . Duty cycle  $\leq 2\%$  .  
(2) Switching characteristics are independent of operating junction temperature.  
(3) For design aid only, not subject to production testing.

## ZXMN3A04DN8

### PACKAGE DIMENSIONS

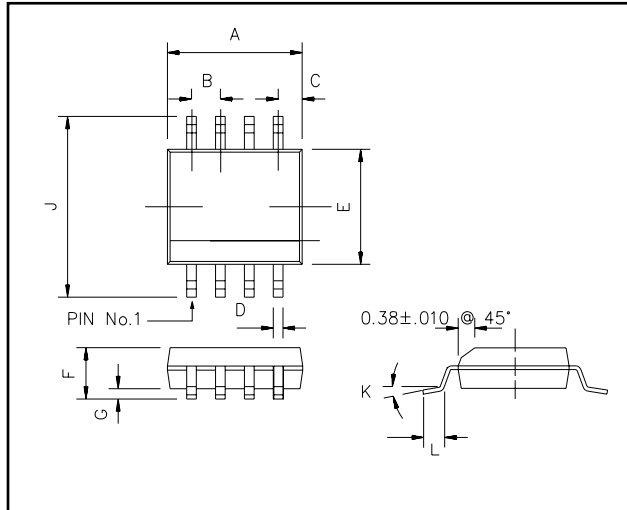

DIM	Millimetres		Inches	
	Min	Max	Min	Max
A	4.80	4.98	0.189	0.196
B	1.27 BSC		0.05 BSC	
C	0.53 REF		0.02 REF	
D	0.36	0.46	0.014	0.018
E	3.81	3.99	0.15	0.157
F	1.35	1.75	0.05	0.07
G	0.10	0.25	0.004	0.010
J	5.80	6.20	0.23	0.24
K	0°	8°	0°	8°
L	0.41	1.27	0.016	0.050



Zetex plc.  
Fields New Road, Chadderton, Oldham, OL9-8NP, United Kingdom.  
Telephone: (44)161 622 4422 (Sales), (44)161 622 4444 (General Enquiries)  
Fax: (44)161 622 4420

Zetex GmbH  
Streitfeldstraße 19  
D-81673 München  
Germany

Zetex Inc.  
Suite 315  
700 Veterans Memorial Highway  
Hauppauge  
USA

Telefon: (49) 89 45 49 49 0  
Fax: (49) 89 45 49 49 49

Telephone: (631) 360-2222  
Fax: (631) 360-8222

Zetex (Asia) Ltd.  
3701-04 Metroplaza, Tower 1  
Hing Fong Road,  
Kwai Fong  
Hong Kong  
Telephone: (852) 26100 611  
Fax: (852) 24250 494

These are supported by  
agents and distributors in  
major countries world-wide  
© Zetex plc 2001

[www.zetex.com](http://www.zetex.com)

This publication is issued to provide outline information only which (unless agreed by the Company in writing) may not be used, applied or reproduced for any purpose or form part of any order or contract or be regarded as a representation relating to the products or services concerned. The Company reserves the right to alter without notice the specification, design, price or conditions of supply of any product or service.



PROVISIONAL ISSUE A - AUGUST 2001